

Schottky Barrier Diode

Features

- High Current Capability
- Low Forward Voltage Drop
- Lead free in comply with EU RoHS 2011/65/EU directive

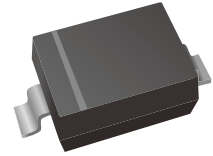

Mechanical Data

- Case: SOD-323
- Mounting Position: Any
- Polarity: Color band denotes cathode end

Ordering Information

Part Number	Marking	Shipping	Reel
LTS40B5-TR3	5	3000PCS Tape&Reel	7 inches
LTS40B5-TR12	5	12000PCS Tape&Reel	13 inches

Maximum Ratings & Thermal Characteristics

(Ratings at 25°C ambient temperature unless otherwise specified)

Parameter	Symbol	Limit	Unit
Peak reverse voltage	V_{RM}	40	V
DC reverse voltage	V_R	30	V
Mean rectifying current	I_O	30	mA
Peak forward surge current 8.3 ms single half sine-wave	I_{FSM}	200	mA
Power Dissipation	P_D	200	mW
Junction Temperature	T_j	125	°C
Storage temperature range	$R_{\theta JA}$	-55 to +150	°C

Electrical Characteristics

(Ratings at 25°C ambient temperature unless otherwise specified)

Parameters	Symbol	Test conditions	Min	Typ	Max	Unit
Maximum forward voltage	V_F	$I_F = 1.0\text{mA}$			0.37	V
Maximum reverse current	I_R	$V_R = 30\text{V}$			0.5	μA
Capacitance between terminals	C_T	$V_R = 10\text{V}, f = 1\text{MHz}$		6		pF



Characteristics Curves

Fig.1 Forward Characteristics

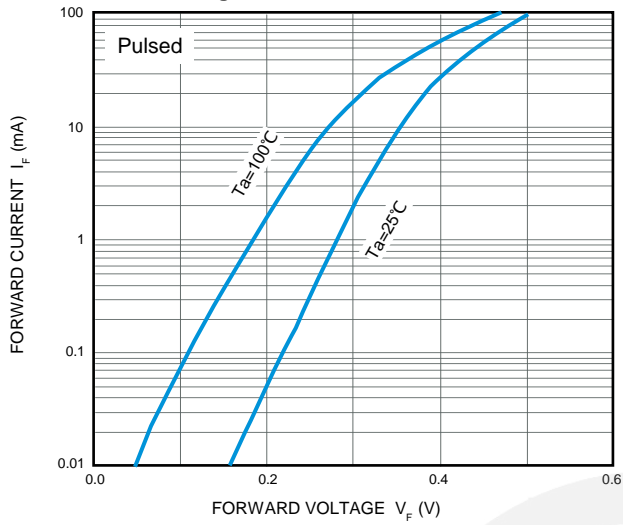

Fig.2 Reverse Characteristics

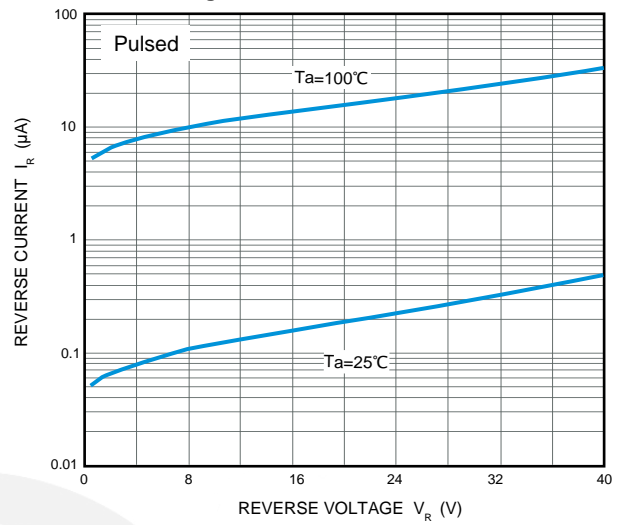

Fig.3 Capacitance Characteristics

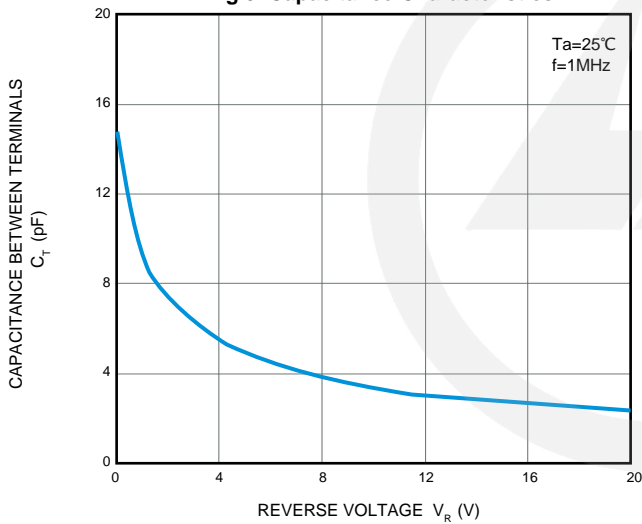
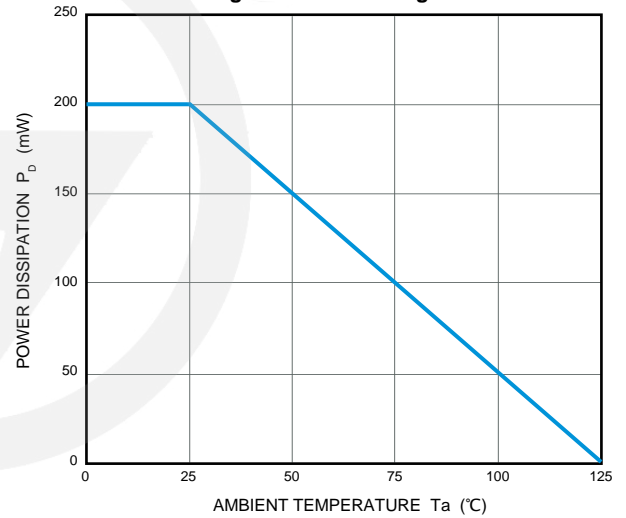
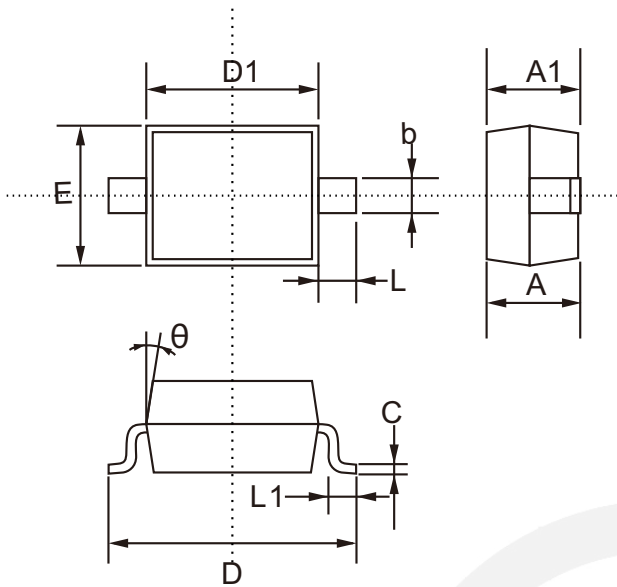

Fig.4 Power Derating Curve



SOD-323 Package Outline

Unit: mm



SYMBOL	DIMENSIONS	
	MIN.	MAX.
A	0.800	1.100
A1	0.800	0.900
b	0.250	0.400
C	0.080	0.177
D	2.300	2.800
D1	1.400	1.800
E	1.150	1.400
L1	0.100	0.400
L	0.475 TYP.	
θ	8°	

SOD-323 Suggested Pad Layout

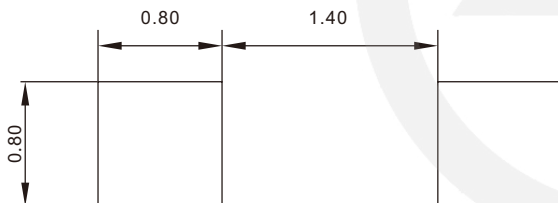

- Note:
1. Controlling dimension: in millimeters.
 2. General tolerance: $\pm 0.05\text{mm}$
 3. The pad layout is for reference purpose only.

Carrier Tape Dimensions

Unit : mm

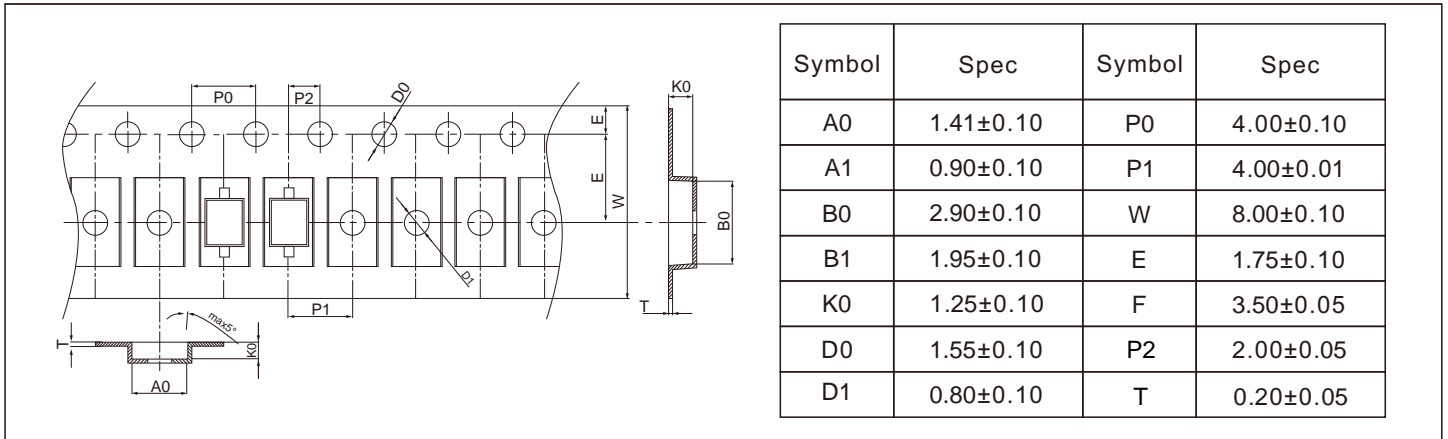

Reel Dimensions

Unit : mm

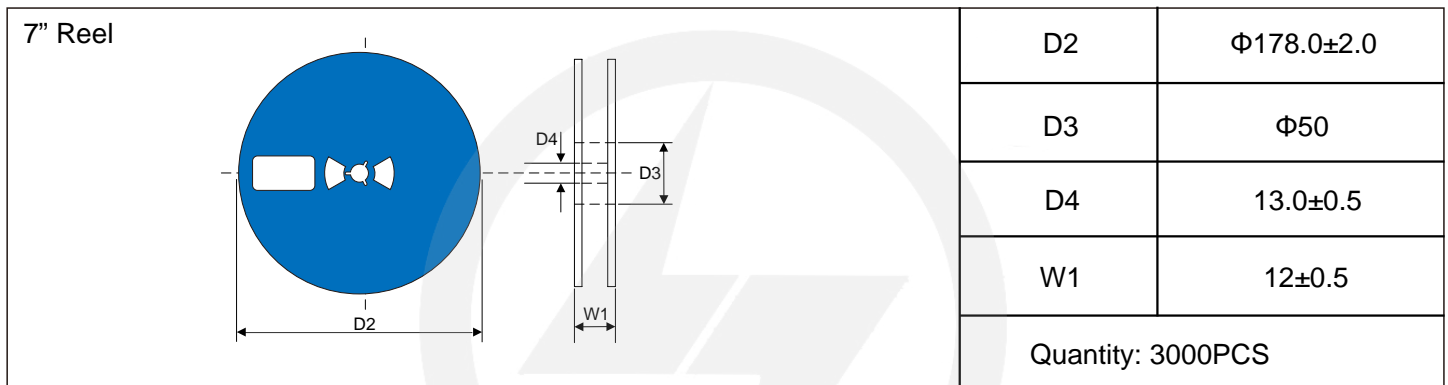

Reel Dimensions

Unit : mm

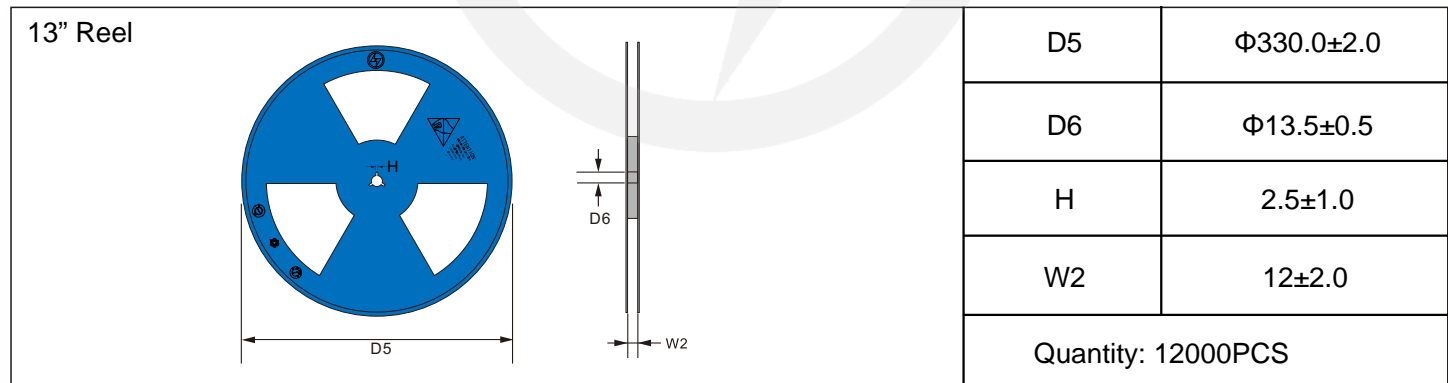

Packaging

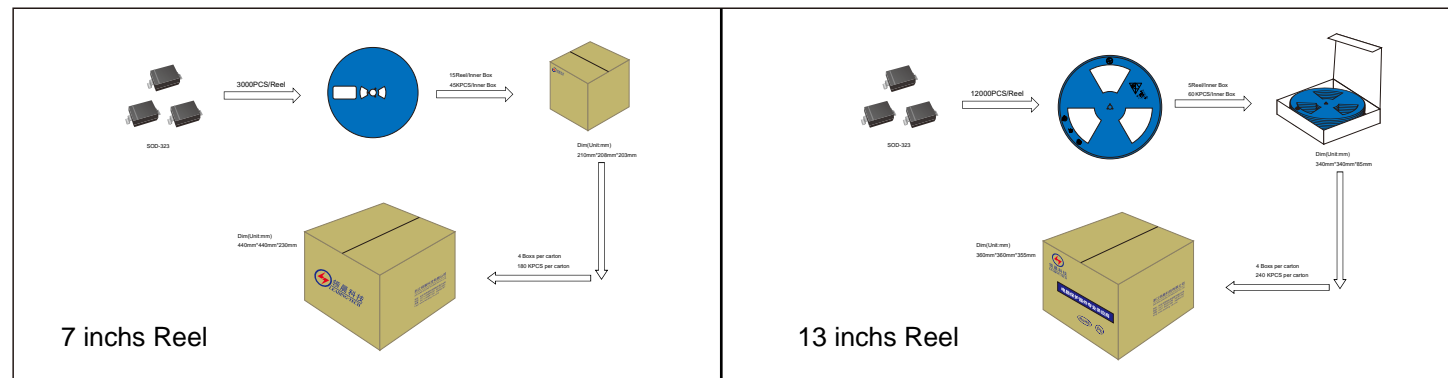



Recommended Soldering Conditions



Recommended Conditions

Profile Feature	Pb-Free Assembly
Average ramp-up rate (T _L to T _P)	3°C/second max.
Preheat	
-Temperature Min (T _{S min})	150°C
-Temperature Max (T _{S max})	200°C
-Time (min to max) (t _s)	60-180 seconds
T _{S max} to T _L	
-Ramp-up Rate	3°C/second max.
Time maintained above:	
-Temperature (T _L)	217°C
-Time (t _L)	60-150 seconds
Peak Temperature (T _P)	260°C
Time within 5°C of actual Peak Temperature (t _p)	20-40 seconds
Ramp-down Rate	6°C/second max.
Time 25°C to Peak Temperature	8 minutes max.

Important Notice and Disclaimer

Leading-Tech reserves the right to make changes to this document and its products and specifications at any time without notice.

Customers should obtain and confirm the latest product information and specifications before final design, purchase or use.

Leading-Tech makes no warranty, representation or guarantee regarding the suitability of its products for any particular purpose, not does Leading-Tech assume any liability for application assistance or customer product design.

Leading-tech does not warrant or accept any liability with products which are purchase or used for any unintended or unauthorized application.

No license is granted by implication or otherwise under any intellectual property rights of Leading-Tech.

Leading-Tech products are not authorized for use as critical components in life support devices or systems without express written approval of Leading-tech.

Version Update Information

Series NO.	Enactment/Revision Date	Effective Date	Version	Revision content	Revision Reason	Revision Person	Note
01	2024.08.19	2024.08.19	3.0	New File	/	Ding	
02	2025.06.12	2025.06.12	3.1	Update packaging information	/	Ding	