

## Fast Recovery Epi Diodes

### Features

- High frequency operation
- High surge forward current capability
- High purity, high temperature epoxy encapsulation for enhanced mechanical strength and moisture resistance
- Guard ring for enhanced ruggedness and long term reliability
- Solder dip 275°C max. 7s, per JESD 22-B106
- Lead free in comply with EU RoHS 2011/65/EU directives

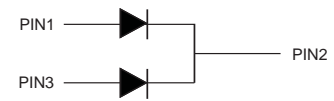
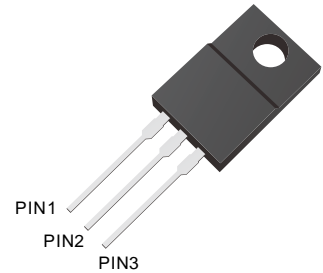

### Mechanical data

- Case: ITO-220AB
- Approx. Weight: 1.561g ( 0.055oz)
- Case Material: “Green” molding compound, UL flammability classification 94V-0, “Halogen-free”.

### Ordering Information

Part Number	Shipping	Packing Type
LTMU2020FD THRU LTMU2060FD	5000PCS/Carton	Tube

### Maximum Ratings and Electrical Characteristics

Ratings At 25°C Ambient Temperature Unless Otherwise Specified

Characteristics	Symble	LTMU2020FD	LTMU2040FD	LTMU2060FD	Unit
Maximum Recurrent Peak Reverse Voltage	$V_{RRM}$	200	400	600	V
Maximum RMS voltage	$V_{RMS}$	140	280	420	V
Maximum DC Blocking Voltage	$V_{DC}$	200	400	600	V
Maximum Average Forward Rectified Current Per leg Per device	$I_{F(AV)}$		10 20		A
Peak Forward Surge Current, 8.3ms Single Half Sine-wave Superimposed on Rated Load (JEDEC method)(Per leg)	$I_{FSM}$		150		A
Max Instantaneous Forward Voltage at 10 A (Per leg)	$V_F$	1.0	1.3	1.6	V
Maximum DC Reverse Current $T_a = 25^\circ\text{C}$ at Rated DC Reverse Voltage $T_a = 125^\circ\text{C}$	$I_R$		10 500		$\mu\text{A}$
Maximum Reverse Recovery Time (NOTE1)	$t_{rr}$		35		ns
Typical Thermal Resistance	$R_{\theta JC}$		4		$^\circ\text{C/W}$
Operating Junction Temperature Range	$T_j$		-55 ~ +150		$^\circ\text{C}$
Storage Temperature Range	$T_{stg}$		-55 ~ +150		$^\circ\text{C}$

Note:(1) Reverse recovery test conditions  $I_F=0.5\text{A}$ ,  $I_R=1.0\text{A}$ ,  $I_{rr}=0.25\text{A}$



Characteristics Curves

Fig.1 Forward Current Derating Curve

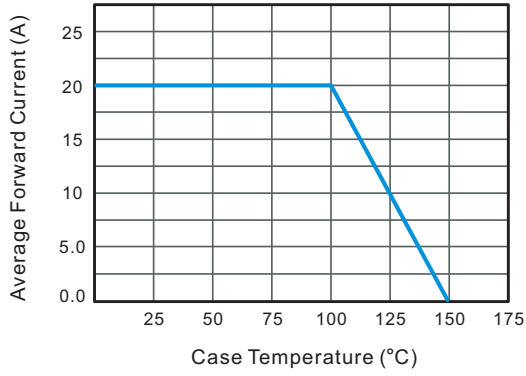

Fig.2 Typical Instantaneous Reverse Characteristics

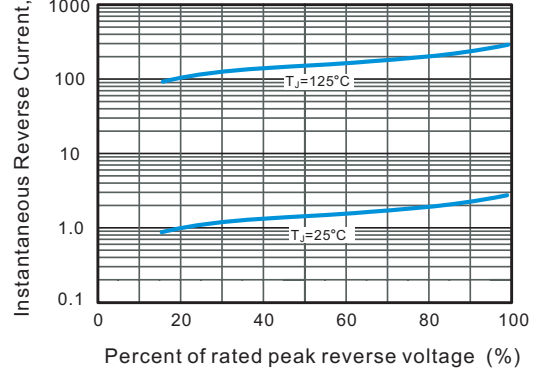

Fig.3 Typical Forward Characteristic

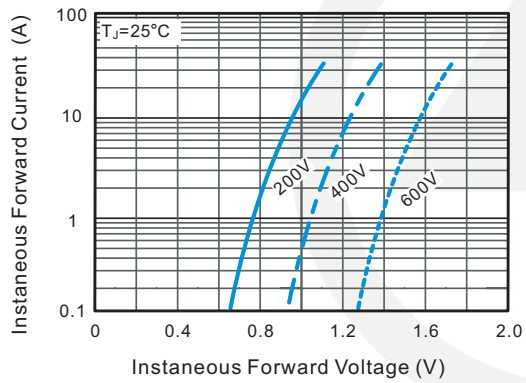
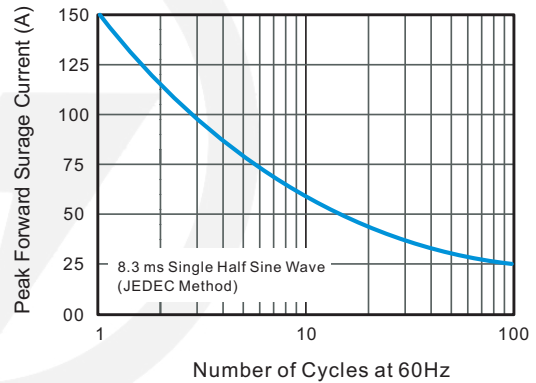
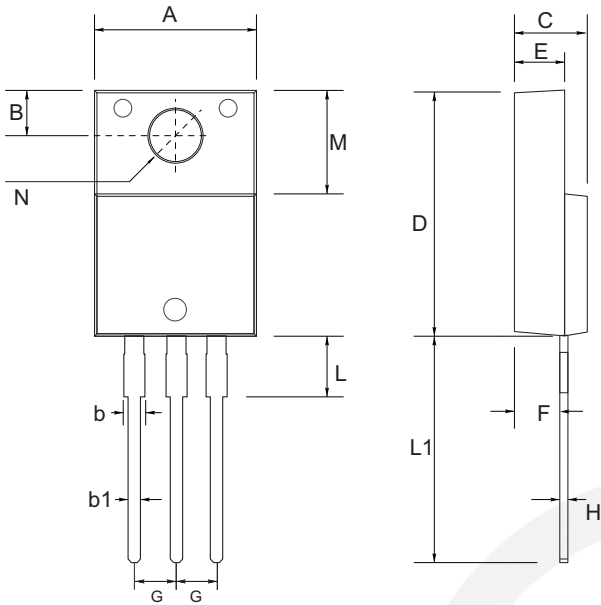

Fig.4 Maximum Non-Repetitive Peak Forward Surge Current



## ITO-220AB Package Outline



Symbol	Dimensions In Millimeters	
	Min.	Max.
A	9.85	10.50
B	2.54	2.85
b	1.10	1.40
b1	0.50	0.80
C	4.40	4.70
D	14.70	16.00
E	2.50	2.90
F	2.50	2.80
G	2.54 TYP.	
H	0.41	0.70
L	2.30	2.90
L1	13.00	14.30
M	6.30	7.00
N	3.4 TYP.	

### Marking

Type number	Marking code
LTMU2020FD	MUR2020FD
LTMU2040FD	MUR2040FD
LTMU2060FD	MUR2060FD

## Important Notice and Disclaimer

Leading-Tech reverses the right to make changes to this document and its products and specifications at any time without notice.

Customers should obtain and confirm the latest product information and specifications before final design, purchase or use.

Leading-Tech makes no warranty, representation or guarantee regarding the suitability of its products for any particular purpose, not does Leading-Tech assume any liability for application assistance or customer product design.

Leading-tech does not warrant or accept any liability with products which are purchase or used for any unintended or unauthorized application.

No license is granted by implication or otherwise under any intellectual property rights of Leading-Tech.

Leading-Tech products are not authorized for use as critical components in life support devices or systems without express written approval of Leading-tech.

## Version Update Information

Series NO.	Enactment/Revision Date	Effective Date	Version	Revision content	Revision Reason	Revision Person	Note
01	2024.4.13	2024.4.13	1.0	New File	/	Ding	