

15A Glass Passivated Single-Phase Bridge Rectifier

Features

- Glass passivated chip
- Low Reverse Leakage Current
- High surge current capability
- Case to Terminal Isolation Voltage 2500V
- Lead free in comply with EU RoHS 2011/65/EU directives

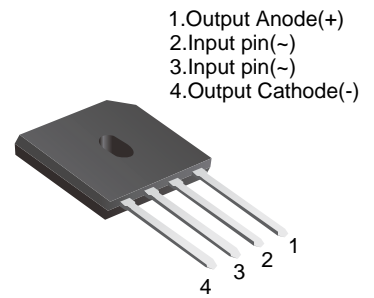

Mechanical Data

- Case: GBU
- Approx. Weight: 3.85g
- Polarity: As marked on body

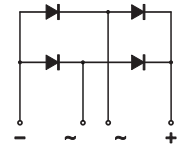

Ordering Information

Part Number	Shipping	Packing Type
LTG15005U THRU LTG1510U	500PCS/Box	Box

Maximum Ratings and Thermal Characteristics @ Ta = 25°C unless otherwise noted

Characteristic	Symbol	LTG15005U	LTG1501U	LTG1502U	LTG1504U	LTG1506U	LTG1508U	LTG1510U	Unit
Maximum Recurrent Peak Reverse Voltage	V_{RRM}	50	100	200	400	600	800	1000	V
Average Forward Output Rectified Current@Ta =120°C	$I_{F(AV)}$	15							A
Forward Voltage Per Leg @IFM =15.0A	V_F	1.1							V
Peak Forward Surge Current 8.3ms Single Half Sine-wave superimposed on rated load	I_{FSM}	300							A
Maximum DC reverse current at rated DC blocking voltage per leg Ta = 25°C Ta=125°C	I_R	5 500							uA
Rms isolation voltage from case to leads	V_{isol}	2500							V
Typical Junction Capacitance	C_J	98							pF
Maximum thermal resistance per leg	$R_{\theta JC}$	1.5							/W
Operating Junction and storage temperature range	T_J, T_{STG}	-55 to +150							

Note:

- (1) Junction to case with heatsink
- (2) Recommended mounting position is to bolt down on heatsink with silicone thermal compound for maximum heat transfer with M3 screw.



Characteristics Curves

Fig.1 Forward Current Derating Curve

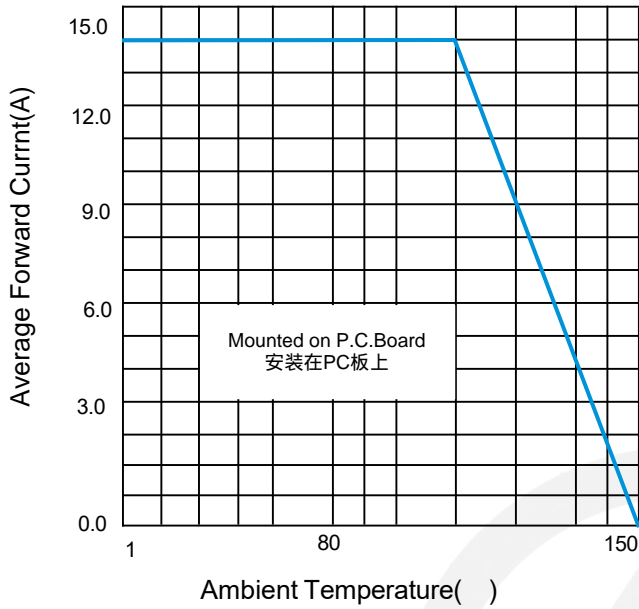

Fig.2 Maximum Non-Repetitive Surge Current

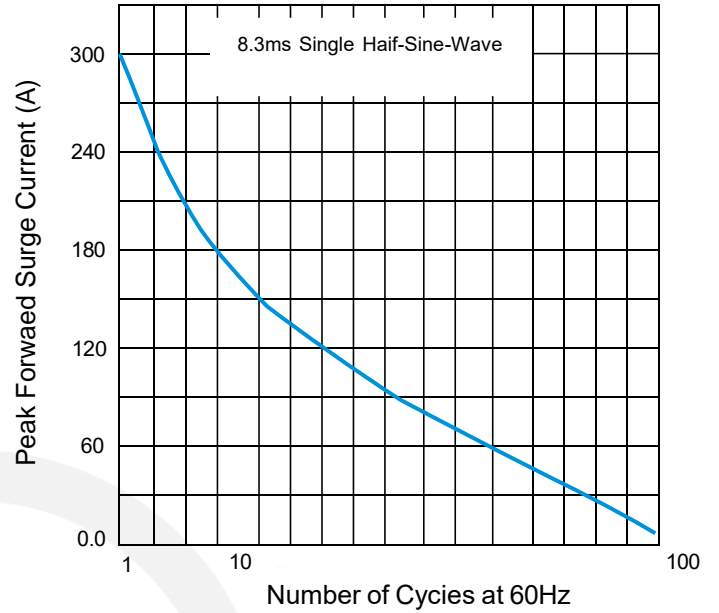

Fig.3 Typical Reverse Characteristics

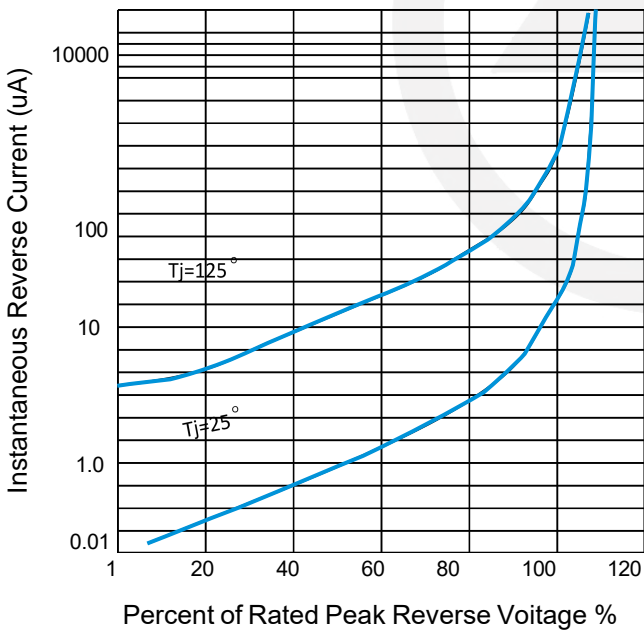
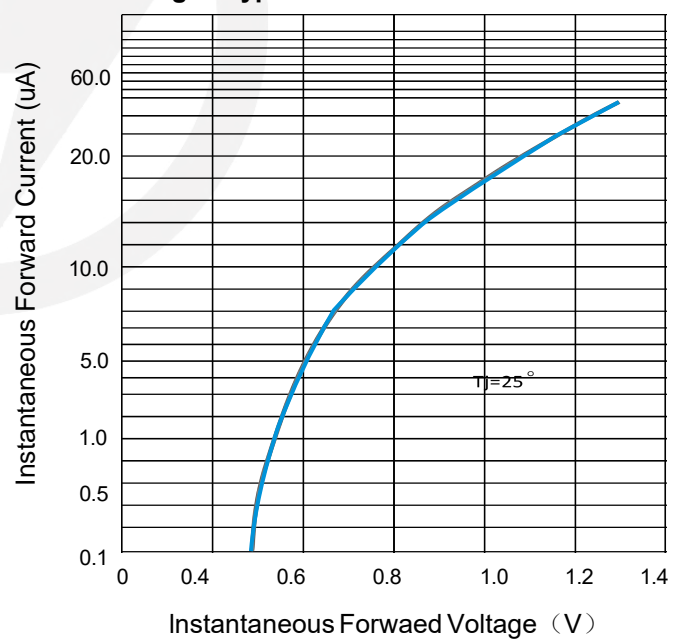
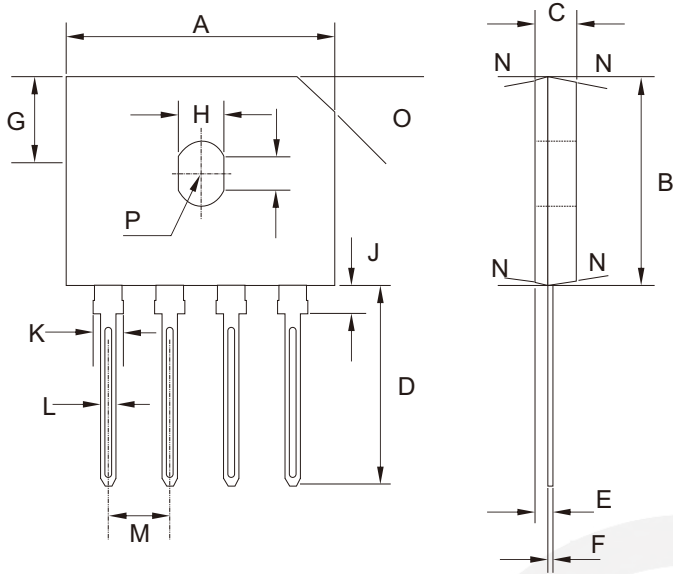

Fig.4 Typical Forward Characteristics



GBU Package Outline



Symbol	Dimensions In Millimeters	
	Min	Max
A	21.80	22.30
B	18.30	18.80
C	3.30	3.56
D	17.50	18.00
E	0.76	1.00
F	0.46	0.56
G	7.40	7.90
H	3.50	4.10
I	1.65	2.16
J	1.85	2.75
K	1.95	2.35
L	1.02	1.27
M	4.83	5.33
N	7°TYP.	
O	3.2x45°	
P	1.90	

Marking

Type number	Marking code
LTG15005U	GBU15005
LTG1501U	GBU1501
LTG1502U	GBU1502
LTG1504U	GBU1504
LTG1506U	GBU1506
LTG1508U	GBU1508
LTG1510U	GBU1510

Important Notice and Disclaimer

Leading-Tech reserves the right to make changes to this document and its products and specifications at any time without notice.

Customers should obtain and confirm the latest product information and specifications before final design, purchase or use.

Leading-Tech makes no warranty, representation or guarantee regarding the suitability of its products for any particular purpose, not does Leading-Tech assume any liability for application assistance or customer product design.

Leading-Tech does not warrant or accept any liability with products which are purchase or used for any unintended or unauthorized application.

No license is granted by implication or otherwise under any intellectual property rights of Leading-Tech.

Leading-Tech products are not authorized for use as critical components in life support devices or systems without express written approval of Leading-tech.

Version Update Information

Series NO.	Enactment/Revision Date	Effective Date	Version	Revision Content	Revision Reason	Revision Person	Note
01	2025.12.10	2025.12.10	3.0	New file	/	Ding	