

Transient Voltage Suppressors for ESD Protection Features

Features

- Protects one data or power line
- Operating Voltage: 4.5V
- High peak pulse current capability
- Ultra low clamping voltage
- Complies with following standards:
 - IEC 61000-4-2 (ESD) ±30kV (Contact)
 - ±30kV (Air)
- IEC61000-4-5 (Lightning) 130A (8/20μs)
- Lead free in comply with EU RoHS 2011/65/EU directives

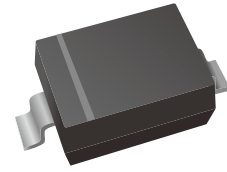

Mechanical Data

- Case:SOD-323
- Flammability Rating: UL 94V-0
- Lead Finish: Matte Tin
- Case Material:“Green”Molding Compound
- Polarity: Color band denotes cathode end

Applications

- Mobile Phonesand Accessories
- Battery Protection
- Power Supply Protection
- Hand Held PortableApplications
- Peripherals

Ordering Information

Part Number	Marking	Shipping	Reel
LTES4V5A01HN-TR3	47D	3000PCS Tape&Reel	7 inches
LTES4V5A01HN-TR12	47D	12000PCS Tape&Reel	13 inches

Absolute Maximum Ratings (TA=25°C unless otherwise specified)

Parameter	Symbol	Value	Unit
Peak Pulse Power (8/20μs)	Ppk	2200	W
Peak Pulse Current (8/20μs)	Ipp	130	A
ESD per IEC 61000-4-2 (Air)	VESD	±30	kV
ESD per IEC 61000-4-2 (Contact)		±30	
Operating Temperature Range	TJ	-55 to +125	°C
Storage Temperature Range	Tstg	-55 to +150	°C

Electrical Characteristics (TA=25°C unless otherwise specified)

Parameter	Symbol	Min	Typ	Max	Unit	Test Condition
Reverse Working Voltage	VRWM			4.5	V	
Breakdown Voltage	VBR	4.7			V	IT = 1mA
Reverse Leakage Current	IR			1	μA	VRWM = 4.5V
Clamping Voltage	VC			8.5	V	I _{PP} = 20A (8 x 20μs pulse)
Clamping Voltage	VC			17	V	I _{PP} = 130A (8 x 20μs pulse)
Junction Capacitance	CJ		500		pF	VR = 0V, f = 1MHz

Characteristic Curves
Fig.1 Junction Capacitance vs. Reverse Voltage

Fig.2 Peak Pulse Power vs. Pulse Time

Fig.3 Clamping Voltage vs. Peak Pulse Current (tp=8/20μs)

Fig.4 Power Derating Curve

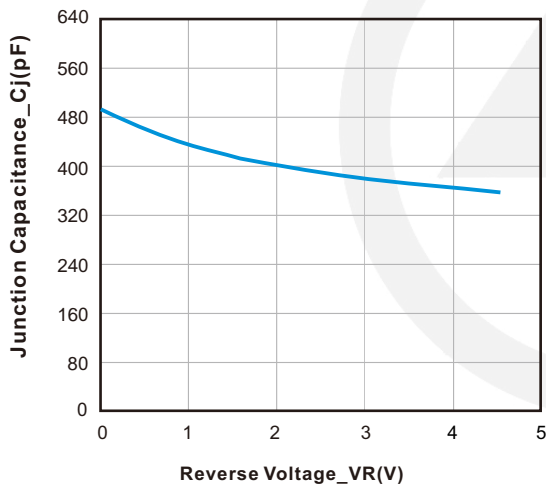
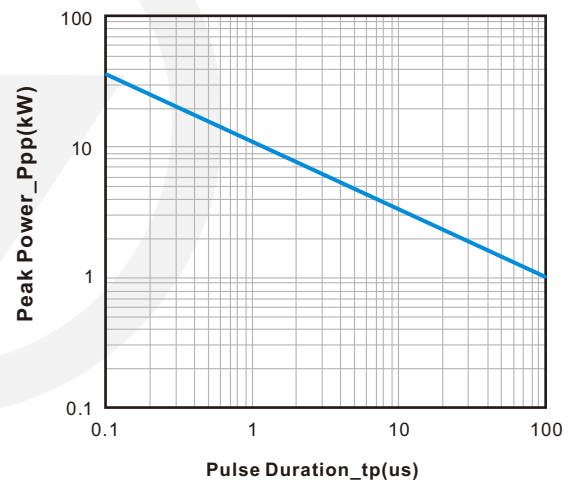
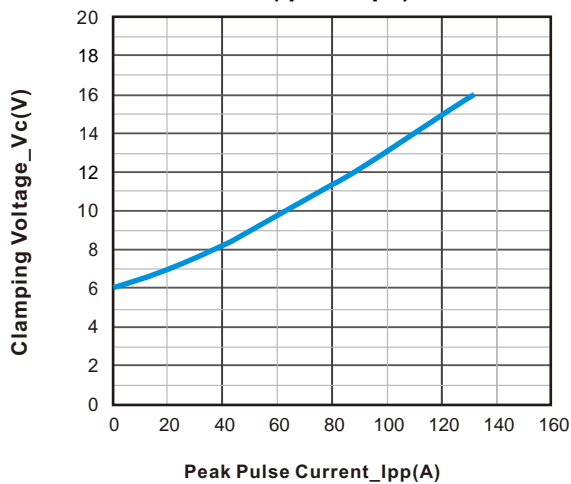
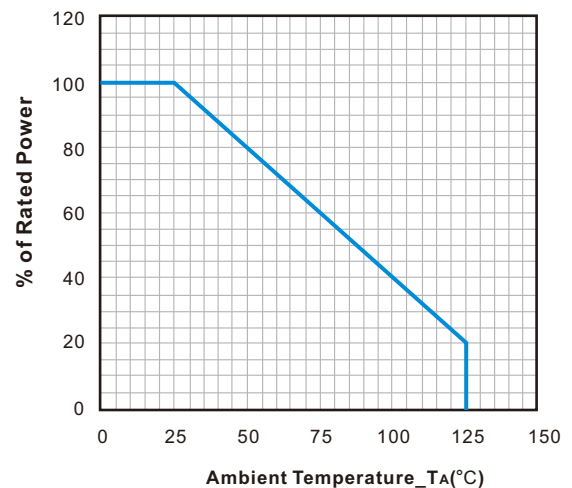

Fig.5 8 X 20 μ s Pulse Waveform

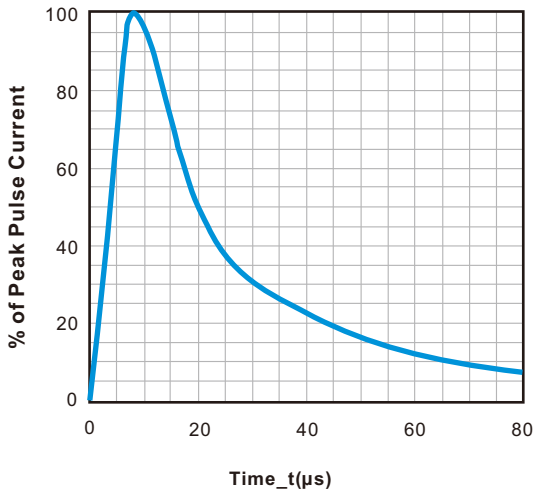
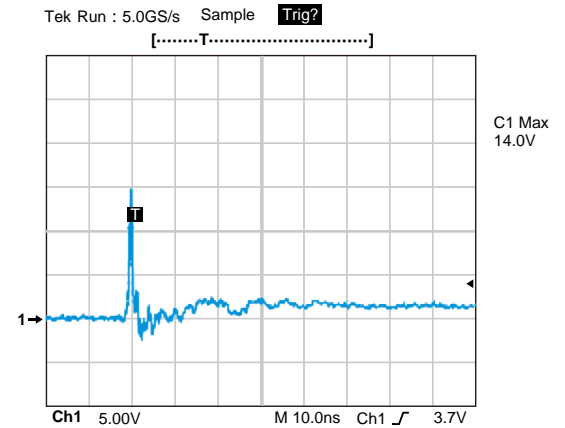

Fig.6 8 kV Contact per IEC61000-4-2



Note : Data is taken with a 10x attenuator
ESD Clamping Voltage

SOD-323 Package Outline

Unit : mm

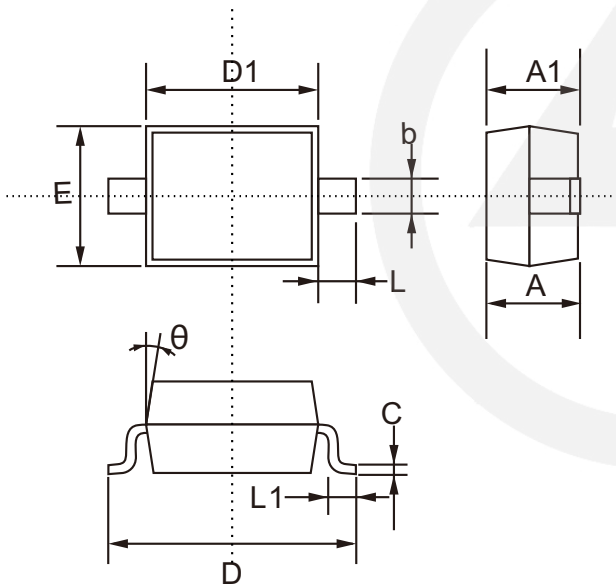

SYMBOL	DIMENSIONS	
	MIN.	MAX.
A	0.800	1.100
A1	0.800	0.900
b	0.250	0.400
C	0.080	0.177
D	2.300	2.800
D1	1.400	1.800
E	1.150	1.400
L1	0.100	0.400
L	0.475 TYP.	
θ	8°	

SOD-323 Suggested Pad Layout

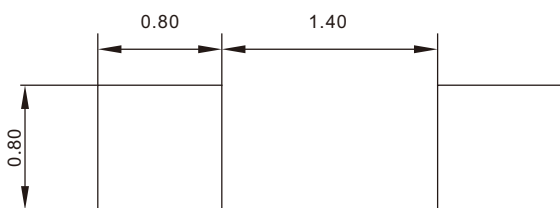

- Note:
1. Controlling dimension: in millimeters.
 2. General tolerance: ± 0.05 mm
 3. The pad layout is for reference purpose only.

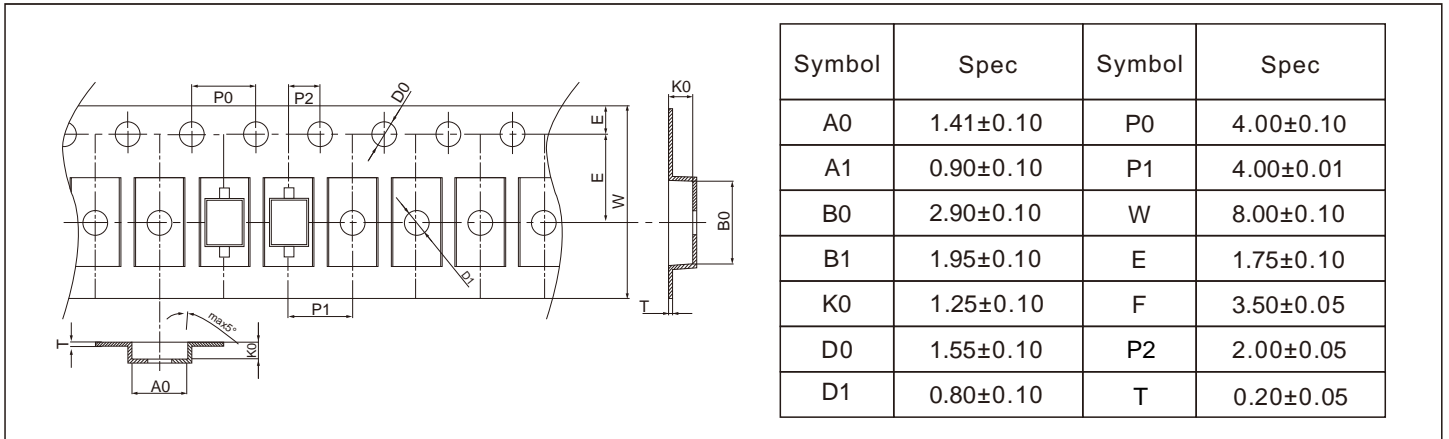
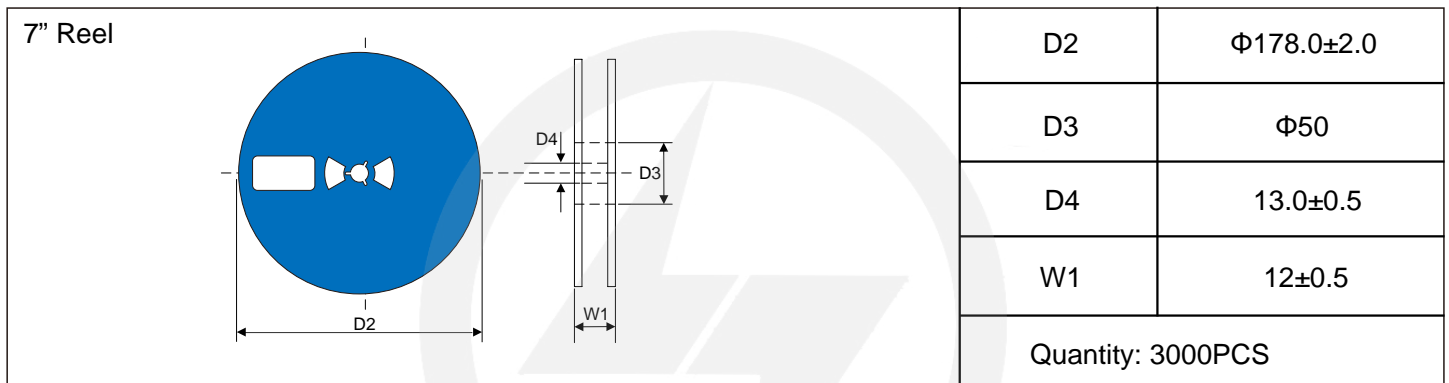
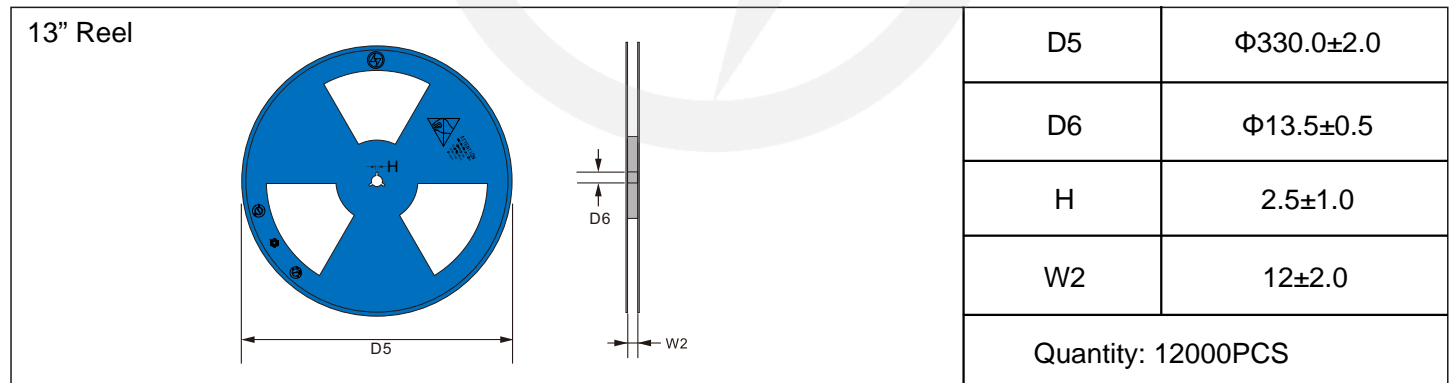
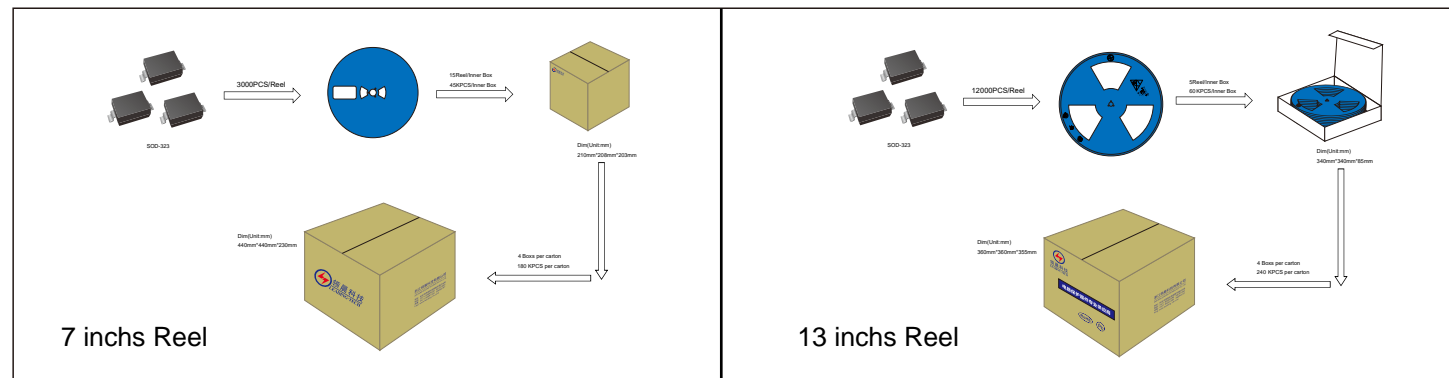
Carrier Tape Dimensions
Unit : mm

Reel Dimensions
Unit : mm

Reel Dimensions
Unit : mm

Packaging



Recommended Soldering Conditions



Recommended Conditions

Profile Feature	Pb-Free Assembly
Average ramp-up rate (T _L to T _P)	3°C/second max.
Preheat	
-Temperature Min (T _{S min})	150°C
-Temperature Max (T _{S max})	200°C
-Time (min to max) (t _s)	60-180 seconds
T _{S max} to T _L	
-Ramp-up Rate	3°C/second max.
Time maintained above:	
-Temperature (T _L)	217°C
-Time (t _L)	60-150 seconds
Peak Temperature (T _P)	260°C
Time within 5°C of actual Peak Temperature (t _p)	20-40 seconds
Ramp-down Rate	6°C/second max.
Time 25°C to Peak Temperature	8 minutes max.

Important Notice and Disclaimer

Leading-Tech reserves the right to make changes to this document and its products and specifications at any time without notice.

Customers should obtain and confirm the latest product information and specifications before final design, purchase or use.

Leading-Tech makes no warranty, representation or guarantee regarding the suitability of its products for any particular purpose, not does Leading-Tech assume any liability for application assistance or customer product design.

Leading-tech does not warrant or accept any liability with products which are purchase or used for any unintended or unauthorized application.

No license is granted by implication or otherwise under any intellectual property rights of Leading-Tech.

Leading-Tech products are not authorized for use as critical components in life support devices or systems without express written approval of Leading-tech.

Version Update Information

Series NO.	Enactment/Revision Date	Effective Date	Version	Revision content	Revision Reason	Revision Person	Note
01	2024.03.16	2024.03.16	3.0	New File	/	Ding	