

Bidirectional TVS Diode

Features

- IEC61000-4-2 (ESD) $\pm 15\text{kV}$ (air), $\pm 8\text{kV}$ (contact)
- IEC61000-4-4 (EFT) 40A (5/50ns)
- IEC61000-4-5 (Lightning) 18A (8/20 μs)
- Protects one I/O line (bidirectional)
- Low clamping voltage
- Working voltages : 5V
- Low leakage current
- Response Time is < 1 ns
- Lead free in comply with EU RoHS 2011/65/EU directives

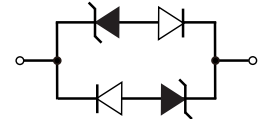
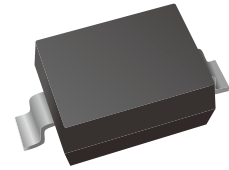

Mechanical Data

- Case:SOD-323
- Flammability Rating: UL 94V-0

Applications

- Cell Phone Handsets and Accessories
- Microprocessor based equipment
- Personal Digital Assistants (PDA's)
- Notebooks, Desktops, and Servers
- Portable Instrumentation
- Peripherals
- USB Interface

Ordering Information

Part Number	Marking	Shipping	Reel
LTES05C01LG-TR3	AC or S2	3000PCS Tape&Reel	7 inches
LTES05C01LG-TR12	AC or S2	12000PCS Tape&Reel	13 inches

Absolute Maximum Rating

Symbol	Parameter	Value	Unit
V_{ESD}	ESD per IEC 61000-4-2 (Air)	± 30	kV
	ESD per IEC 61000-4-2 (Contact)	± 30	
P_{PP}	Peak Pulse Power (8/20 μ s)	350	W
T_{OPT}	Operating Temperature	-55/+150	$^{\circ}$ C
T_{STG}	Storage Temperature	-55/+150	$^{\circ}$ C
T_L	Lead Soldering Temperature	260	$^{\circ}$ C

Electrical Characteristics (TA=25 $^{\circ}$ C unless otherwise specified)

Part Number	Device Marking	V_{RWM}	$V_B@1mA$	$V_C@1A$	$V_C@I_{pp}^{*1}$		$V_C@I_{pp}^{*1}$		I_R	C_T^{*2}
		(V) Max	(V) Min	(V) Max	(V) Max	(A) I_{pp}	(V) Max	(A) I_{pp}	(μ A) Max	(pF) Typ.
LTES05C01LG	AC or S2	5.0	6.0	9.8	18.3	8	20.0	18	1	0.8

*1 Surge Pulse waveform tp=8/20 μ s

*2 Capacitance@ VR=0V,f=1MHz

Characteristic Curves

Fig.1 8x20 μ s Pulse Waveform per IEC 61000-4-5

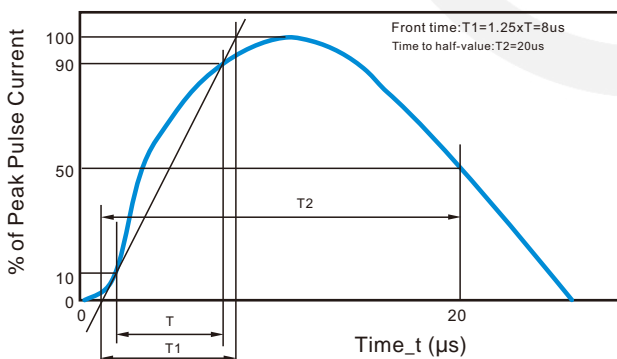

Fig.2 Contact Discharge Current Waveform per IEC 61000-4-2

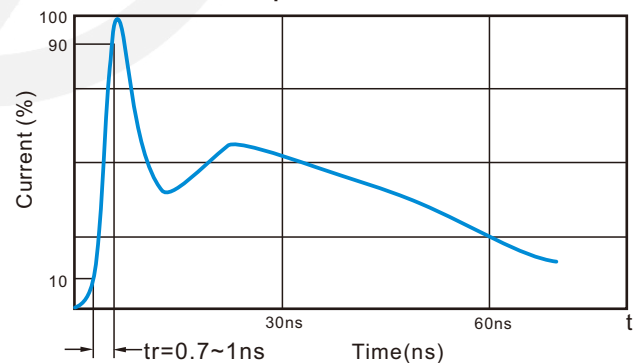

Fig.3 Voltage vs Capacitance

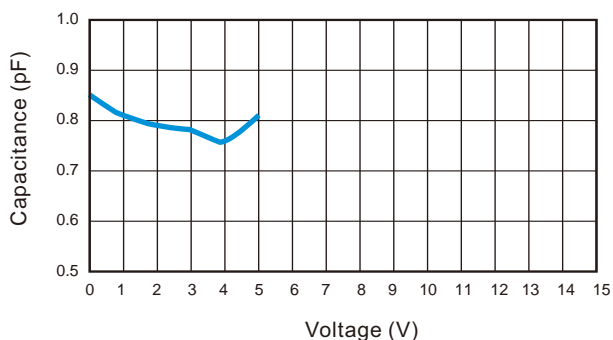
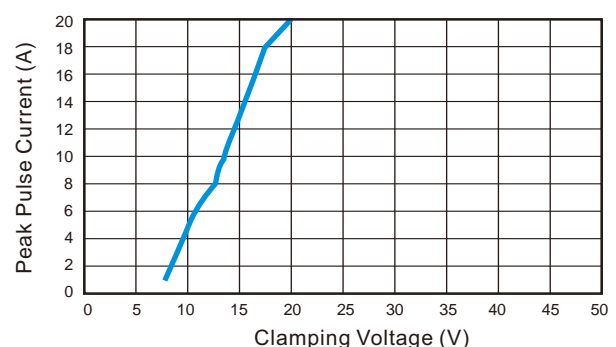

Fig.4 Clamping Voltage vs Peak Pulse Current





SOD-323 Package Outline

Unit: mm

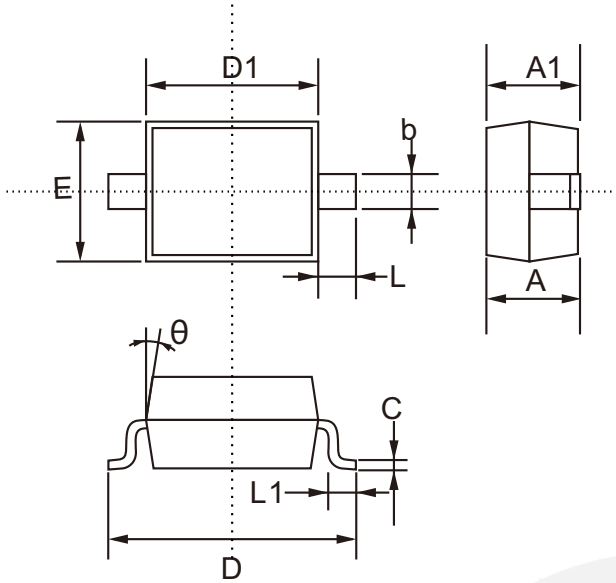

SYMBOL	DIMENSIONS	
	MIN.	MAX.
A	0.800	1.100
A1	0.800	0.900
b	0.250	0.400
C	0.080	0.177
D	2.300	2.800
D1	1.400	1.800
E	1.150	1.400
L	0.475 TYP.	
θ	8°	

SOD-323 Suggested Pad Layout

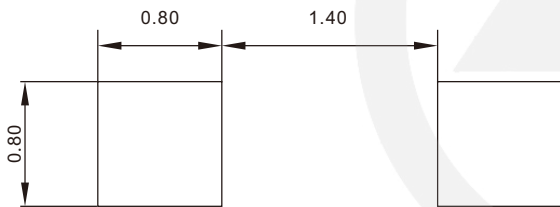

- Note:
1. Controlling dimension: in millimeters.
 2. General tolerance: $\pm 0.05\text{mm}$
 3. The pad layout is for reference purpose only.

Carrier Tape Dimensions

Unit : mm

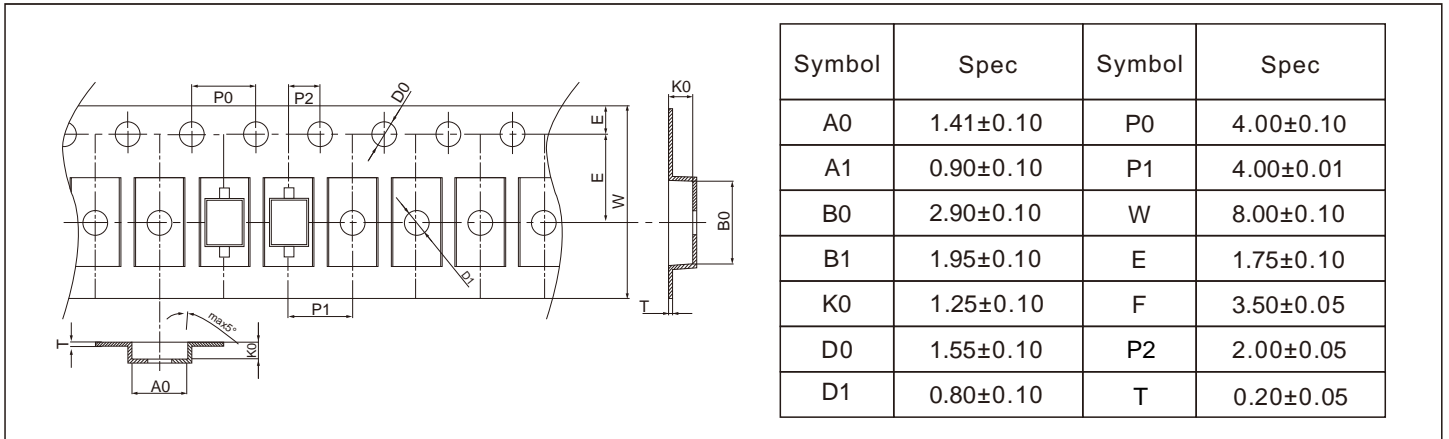

Reel Dimensions

Unit : mm

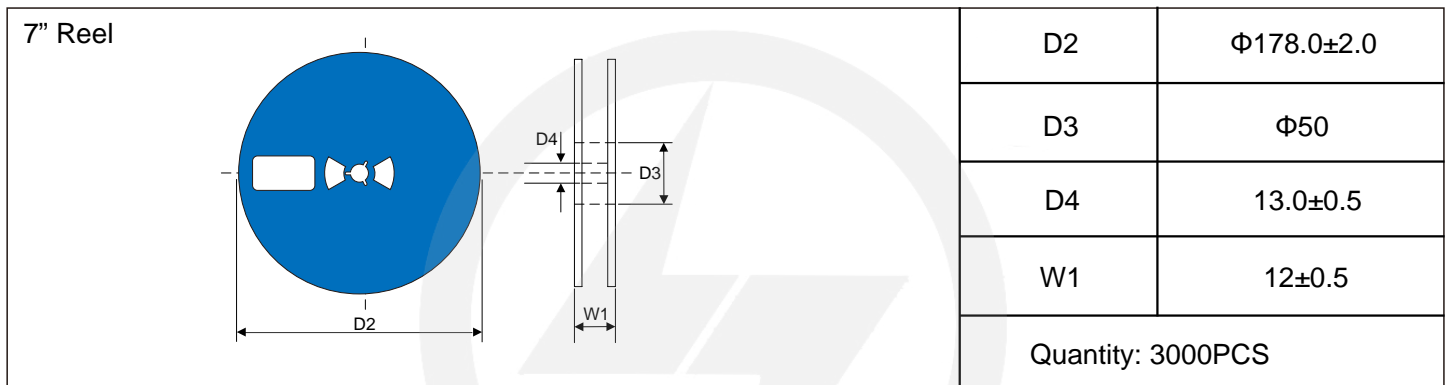

Reel Dimensions

Unit : mm

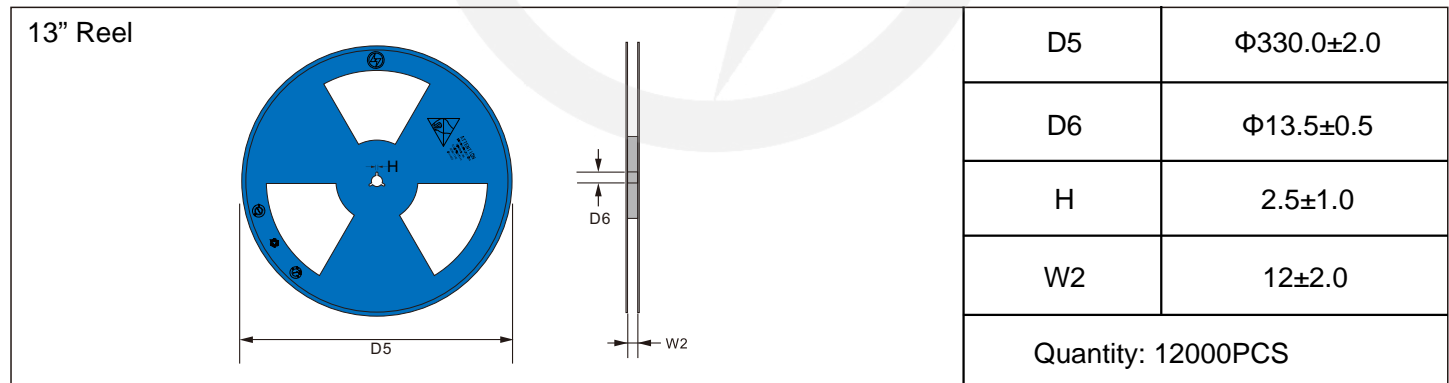

Packaging

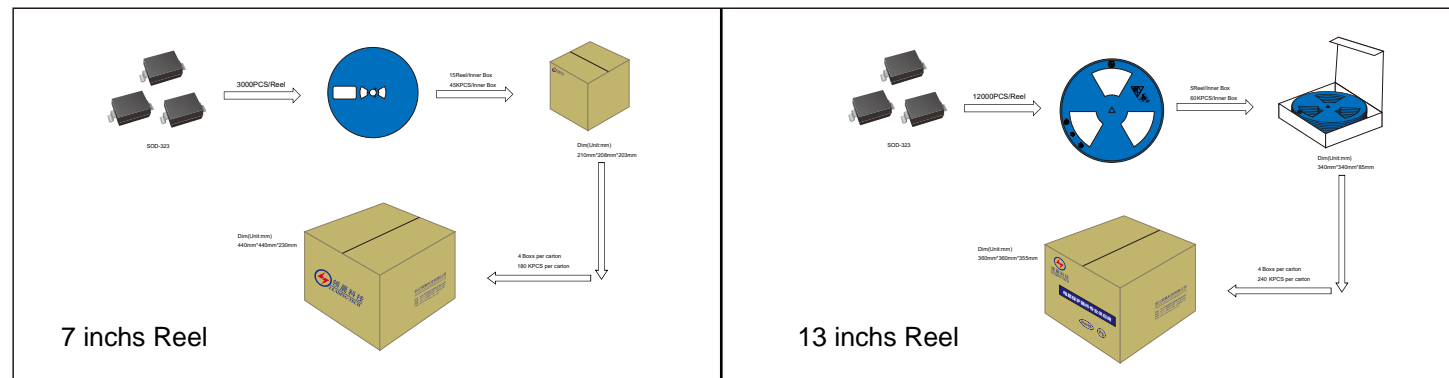



Recommended Soldering Conditions



Recommended Conditions

Profile Feature	Pb-Free Assembly
Average ramp-up rate (T_L to T_P)	3°C/second max.
Preheat	
-Temperature Min ($T_{S\ min}$)	150°C
-Temperature Max ($T_{S\ max}$)	200°C
-Time (min to max) (t_s)	60-180 seconds
$T_{S\ max}$ to T_L	
-Ramp-up Rate	3°C/second max.
Time maintained above:	
-Temperature (T_L)	217°C
-Time (t_L)	60-150 seconds
Peak Temperature (T_P)	260°C
Time within 5°C of actual Peak Temperature (t_p)	20-40 seconds
Ramp-down Rate	6°C/second max.
Time 25°C to Peak Temperature	8 minutes max.

Important Notice and Disclaimer

Leading-Tech reserves the right to make changes to this document and its products and specifications at any time without notice.

Customers should obtain and confirm the latest product information and specifications before final design, purchase or use.

Leading-Tech makes no warranty, representation or guarantee regarding the suitability of its products for any particular purpose, not does Leading-Tech assume any liability for application assistance or customer product design.

Leading-tech does not warrant or accept any liability with products which are purchase or used for any unintended or unauthorized application.

No license is granted by implication or otherwise under any intellectual property rights of Leading-Tech.

Leading-Tech products are not authorized for use as critical components in life support devices or systems without express written approval of Leading-tech.

Version Update Information

Series NO.	Enactment/Revision Date	Effective Date	Version	Revision content	Revision Reason	Revision Person	Note
01	2024.03.16	2024.03.16	3.0	New File	/	Ding	
02	2025.06.16	2025.06.16	3.1	Update packaging information	/	Ding	