

## 1-Line Low Capacitance Bi-directional TVS Diode

### Features

- 340W peak pulse power (8/20 $\mu$ s)
- Ultra low capacitance: 1pF typical
- Ultra low leakage: nA level
- Operating voltage: 5V
- Low clamping voltage
- Protects one power line or data line
- Complies with following standards:
  - IEC 61000-4-2 (ESD) immunity test  
Air discharge:  $\pm$ 30kV  
Contact discharge:  $\pm$ 30kV
  - IEC61000-4-5 (Lightning) 18A (8/20 $\mu$ s)
- Lead free in comply with EU RoHS 2011/65/EU directives

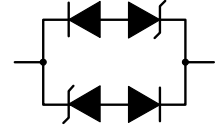

### Mechanical Data

- Case: SOD-123
- LeadFinish: Matte Tin
- Case Material: "Green" Molding Compound
- Approx. Weight: 10.5mg

### Applications

- USB Ports
- Smart Phones
- Wireless Systems
- Ethernet 10/100/1000 Base T

### Ordering information

Part Number	Marking	Shipping	Reel
LTE1Z05C01L-TR3	1D1	3000PCS Tape&Reel	7 inchs
LTE1Z05C01L-TR12	1D1	12000PCS Tape&Reel	13 inchs

**Absolute Maximum Ratings** ( $T_A=25^{\circ}\text{C}$  unless otherwise specified)

Parameter	Symbol	Value	Unit
Peak Pulse Power (8/20 $\mu\text{s}$ )	Ppk	340	W
Peak Pulse Current (8/20 $\mu\text{s}$ )	IPP	18	A
ESD per IEC 61000-4-2 (Air) ESD per IEC 61000-4-2 (Contact)	VESD	$\pm 30$ $\pm 30$	kV
Operating Temperature Range	TJ	-55 to +125	$^{\circ}\text{C}$
Storage Temperature Range	Tstg	-55 to +150	$^{\circ}\text{C}$

**Electrical Characteristics** ( $T_A=25^{\circ}\text{C}$  unless otherwise specified)

Parameter	Symbol	Min	Typ	Max	Unit	Test Condition
Reverse Working Voltage	VRWM			5	V	
Breakdown Voltage	VBR	6			V	$I_T = 1\text{mA}$
Reverse Leakage Current	$I_R$			0.2	$\mu\text{A}$	$VRWM = 5\text{V}$
Clamping Voltage	VC		8	10	V	$IPP = 1\text{A}$ (8/20 $\mu\text{s}$ pulse)
Clamping Voltage	VC		15	18	V	$IPP = 18\text{A}$ (8/20 $\mu\text{s}$ pulse)
Junction Capacitance	CJ		1		pF	$VR = 0\text{V}$ , $f = 1\text{MHz}$

**Characteristic Curves**

**Fig.1 Junction Capacitance vs. Reverse Voltage**

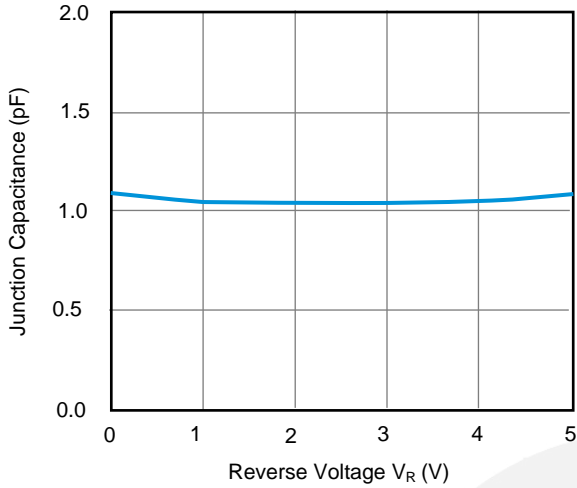

**Fig.2 Peak Pulse Power vs. Pulse Time**

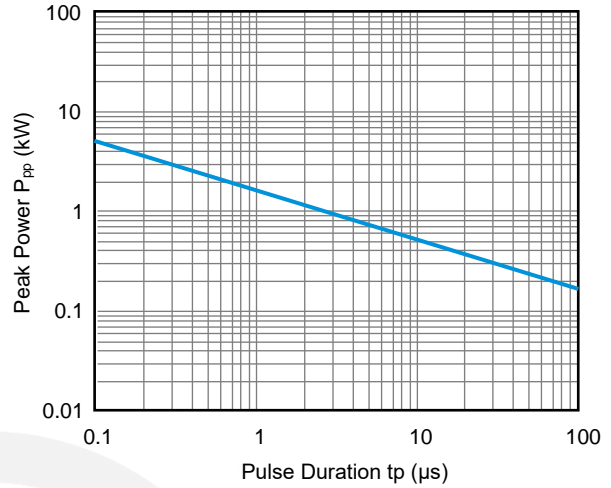

**Fig.3 Clamping Voltage vs. Peak Pulse Current**

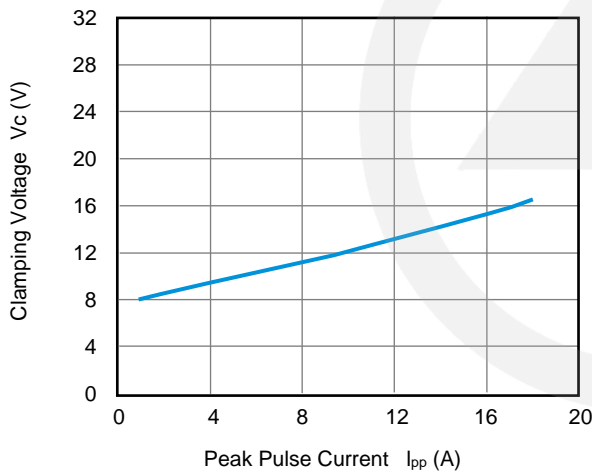

**Fig.4 Power Derating Curve**

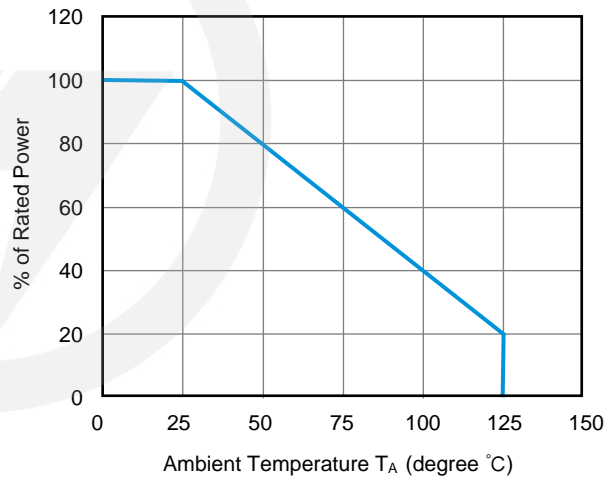

**Fig.5 8 X 20μs Pulse Waveform**

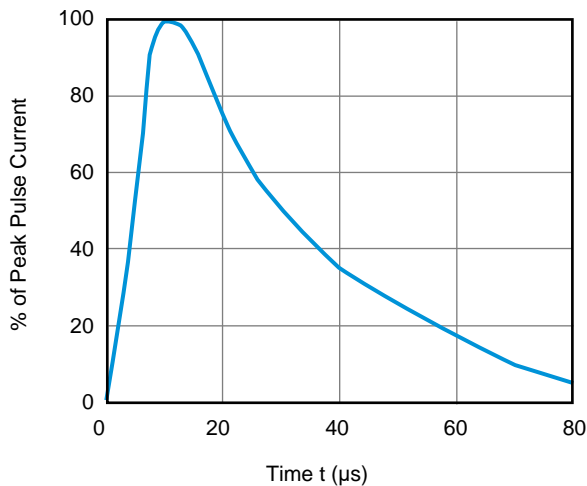

**Fig.6 ESD Clamping Voltage  
8 kV Contact per IEC61000-4-2**

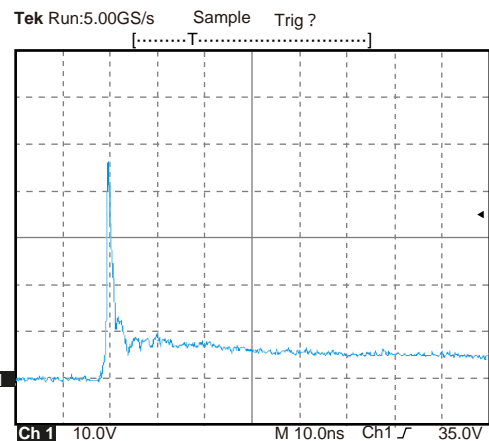

Note: Data is taken with a 10x attenuator

**SOD-123 Package Outline**

Unit: mm

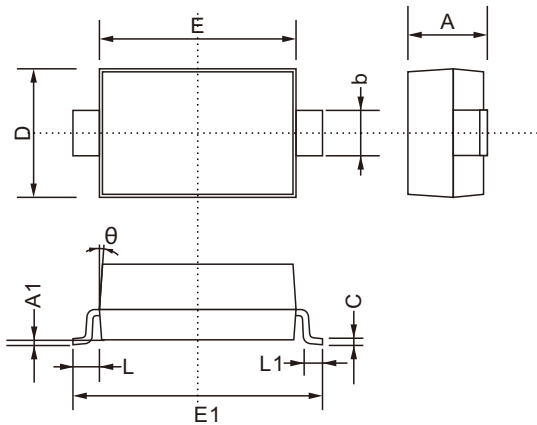

SYMBOL	DIMENSIONS	
	MIN.	MAX.
A	0.900	1.300
A1	0.000	0.200
b	0.450	0.750
C	0.080	0.230
D	1.500	1.800
E	2.500	2.800
E1	3.550	3.900
L1	0.250	0.450
L	0.5REF	
$\theta$	8°	

**SOD-123 Suggested Pad Layout**

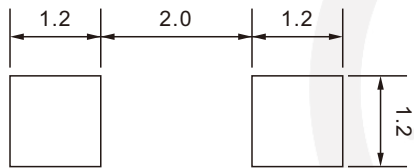

- Note:
1. Controlling dimension: in millimeters.
  2. General tolerance:  $\pm 0.05\text{mm}$
  3. The pad layout is for reference purpose only.

**Carrier Tape Dimensions**

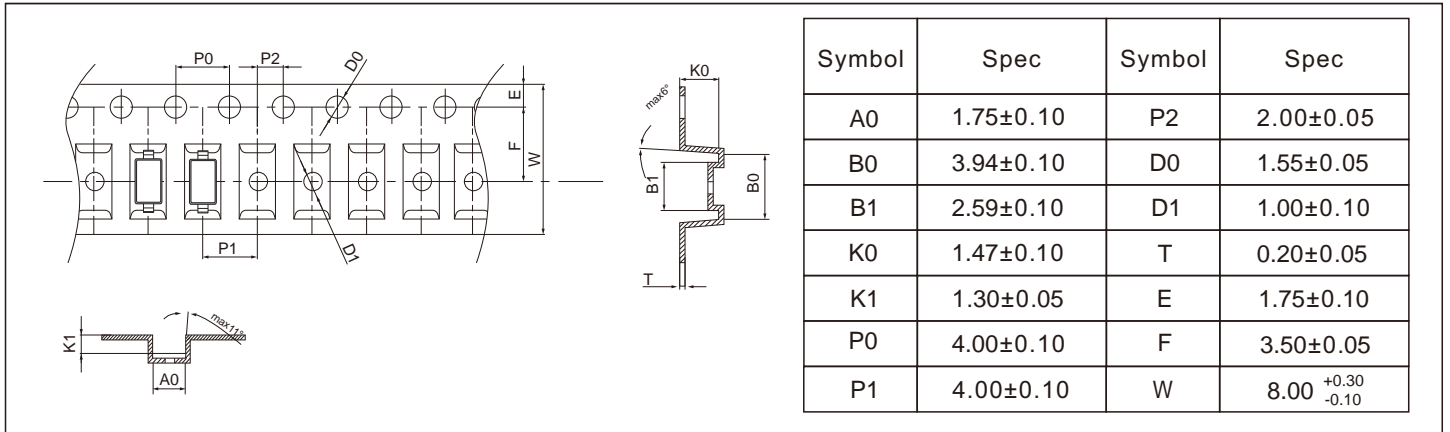

**Reel Dimensions**

**Unit : mm**

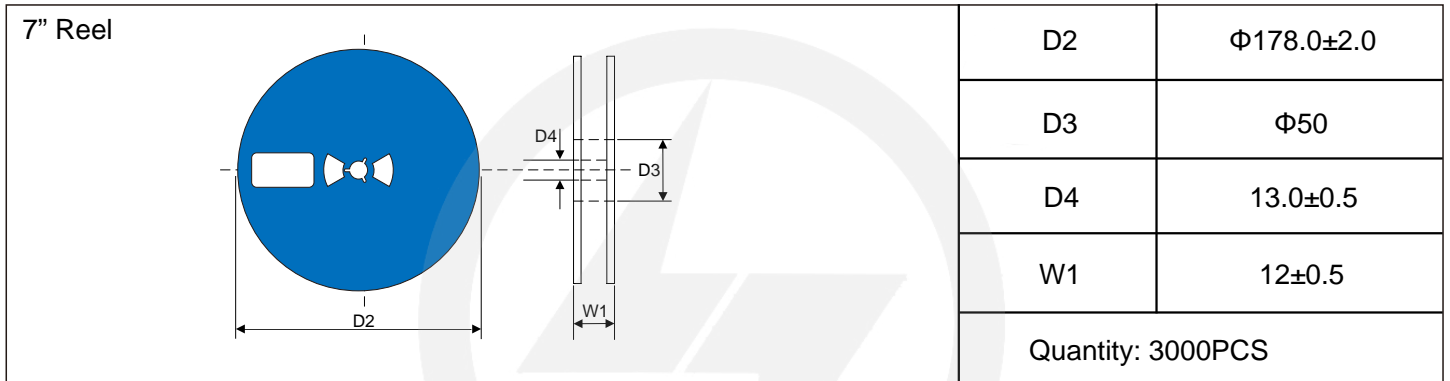

**Reel Dimensions**

**Unit : mm**

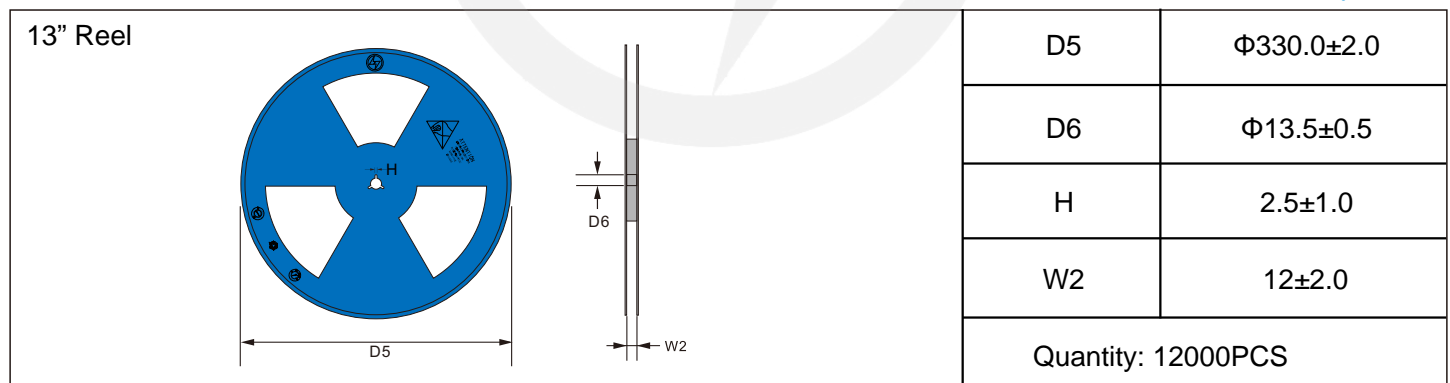

**Packaging**

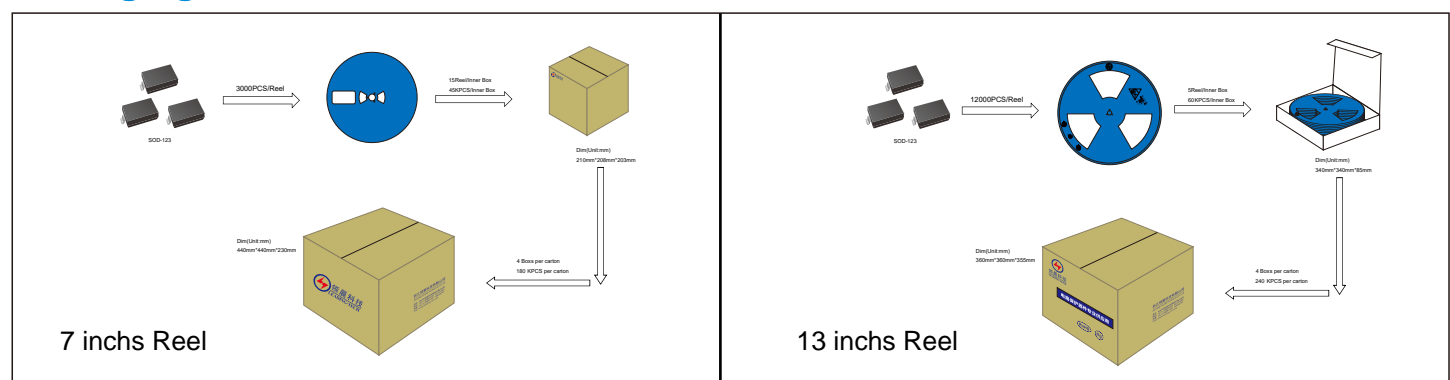



Recommended Soldering Conditions



Recommended Conditions

Profile Feature	Pb-Free Assembly
Average ramp-up rate (T <sub>L</sub> to T <sub>P</sub> )	3°C/second max.
Preheat	
-Temperature Min (T <sub>S min</sub> )	150°C
-Temperature Max (T <sub>S max</sub> )	200°C
-Time (min to max) (t <sub>s</sub> )	60-180 seconds
T <sub>S max</sub> to T <sub>L</sub>	
-Ramp-up Rate	3°C/second max.
Time maintained above:	
-Temperature (T <sub>L</sub> )	217°C
-Time (t <sub>L</sub> )	60-150 seconds
Peak Temperature (T <sub>P</sub> )	260°C
Time within 5°C of actual Peak Temperature (t <sub>p</sub> )	20-40 seconds
Ramp-down Rate	6°C/second max.
Time 25°C to Peak Temperature	8 minutes max.

## Important Notice and Disclaimer

Leading-Tech reverses the right to make changes to this document and its products and specifications at any time without notice.

Customers should obtain and confirm the latest product information and specifications before final design, purchase or use.

Leading-Tech makes no warranty, representation or guarantee regarding the suitability of its products for any particular purpose, not does Leading-Tech assume any liability for application assistance or customer product design.

Leading-Tech does not warrant or accept any liability with products which are purchase or used for any unintended or unauthorized application.

No license is granted by implication or otherwise under any intellectual property rights of Leading-Tech.

Leading-Tech products are not authorized for use as critical components in life support devices or systems without express written approval of Leading-tech.

## Version Update Information

Series NO.	Enactment/Revision Date	Effective Date	Version	Revision content	Revision Reason	Revision Person	Note
01	2025.06.09	2025.06.09	3.0	New File	/	Ding	