

2.0A Single-Phase GLass Passivated Bridge Rectifiers

Features

- Glass passivated junction
- The plastic material used carries Underwriters Laboratory flammability recognition 94V-0
- Suge overload ratings to 60 amperes peak
- Ideal for printed circuit board application
- Lead free in comply with EU RoHS 2011/65/EU directives



Mechanical Data

- Case:Molded plastic
- Terminals:Platde leads solderable per MIL-STD-750, Method 2026
- Polarity:Polarity symbols molded or Marked on body
- Mounting Position:Any

Ordering Information

Part Number	Shipping	Reel
LTD201B THRU LTD207B-TR1K5	1500PCS Tape&Reel	13 inches

Maximum Ratings and Electrical Characteristics

Ratings at 25°C ambient temperature unless otherwise specified.
 Single phase half-wave 60Hz,resistive or inductive load, for capacitive load derate current by 20%.

Characteristics	Symbol	LTD201B	LTD202B	LTD203B	LTD204B	LTD205B	LTD206B	LTD207B	Unit
Maximum Recurrent Peak Reverse Voltage	VRRM	50	100	200	400	600	800	1000	V
Maximum RMS Voltage	VRMS	35	70	140	280	420	560	700	V
Maximum DC Blocking Voltage	VDC	50	100	200	400	600	800	1000	V
Maximum Average Forward Rectified Current @TA=40°C	IAV	2							A
Peak Forward Surge Current 8.3ms Single Half Sine-Wave Super Imposed on Rated Load (JEDEC Method)	IFSM	60							A
Maximum Forward Voltage at 2.0A DC	VF	1.1							V
Maximum DC Reverse Current @TJ=25°C at Rated DC Bolcking Voltage @TJ=125°C	IR	10 100							µA
I ² t Rating for Fusing (t<8.3ms)	I ² t	15							A ² s
Typical Junction Capacitance Per Element (Note1)	CJ	25							pF
Typical Thermal Resistance (Note2)	RJA	68							°C/W
Operating Temperature Range	TJ	-55 to +150							°C
Storage Temperature Range	TSTG	-55 to +150							°C

Note:1.Measured at 1.0MHz and applied reverse voltage of 4.0V DC.

2.Thermal resistance from junction to ambient mounted on P.C.B. with 0.5*0.5"(13mm*13mm) copper pads.



Characteristics Curves

FIG.1 DERATING CURVE FOR OUTPUT RECTIFIED CURRENT

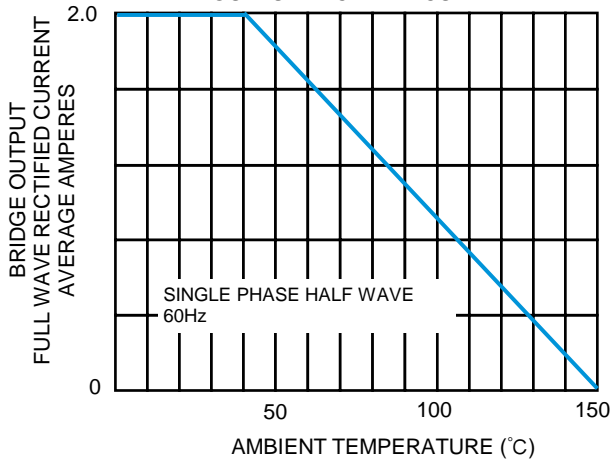

FIG.2 MAXIMUM NON-REPETITIVE SURNGE CURRENT

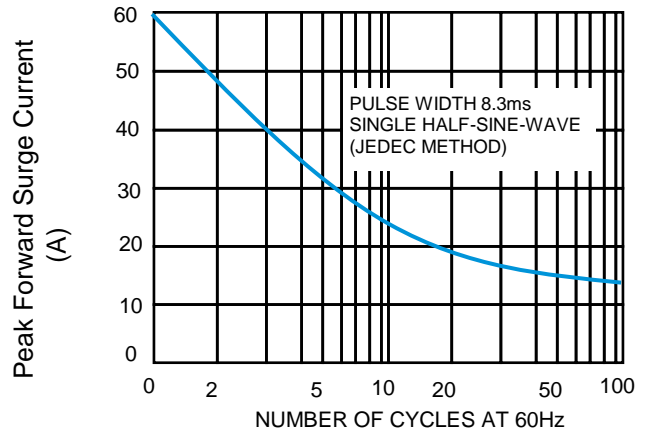

FIG.3 TYPICAL JUNCTION CAPACITANCE

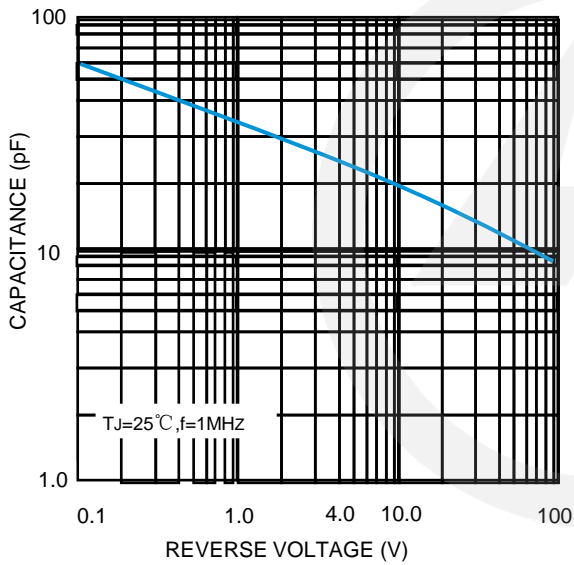

FIG.4 TYPICAL FORWARD CHARACTERISTICS

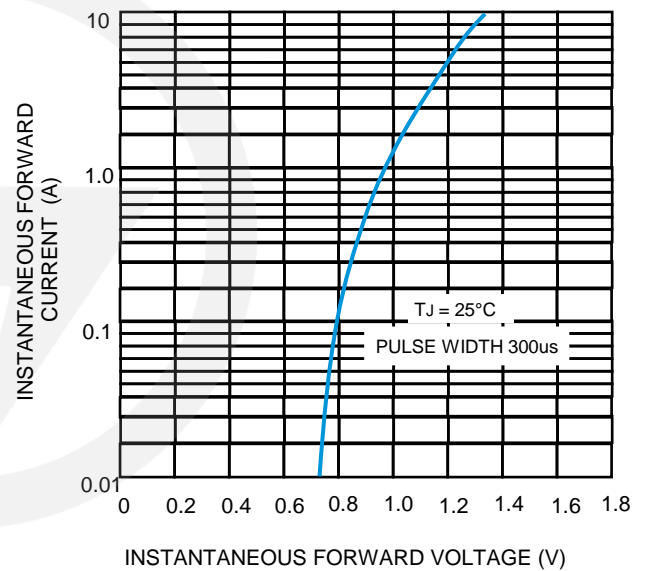
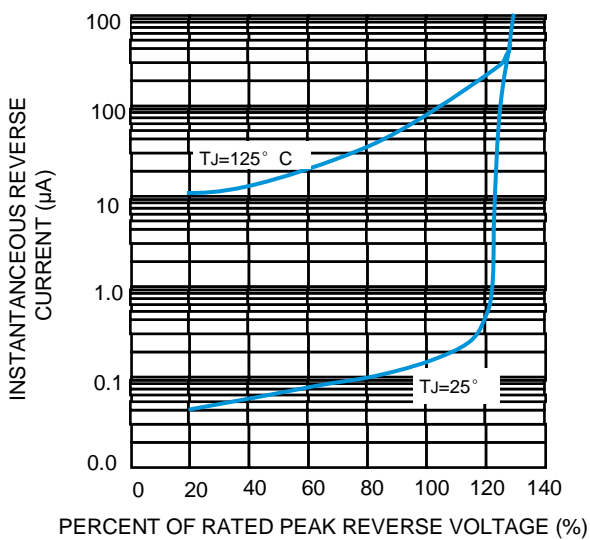
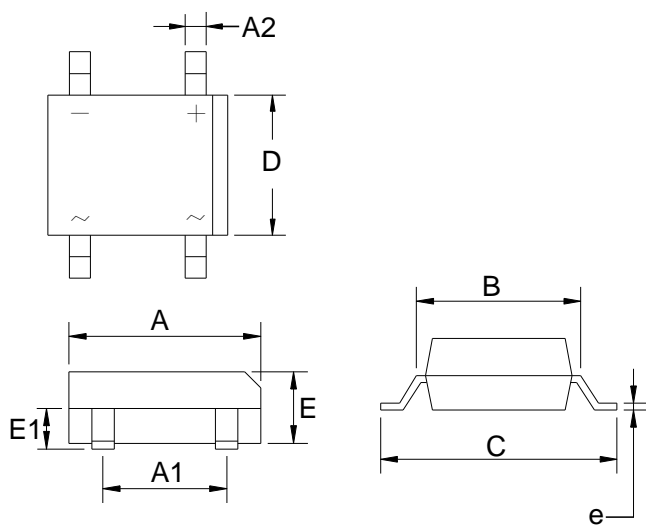

FIG.5 TYPICAL REVERSE CHARACTERISTICS



DBS Package Outline



Unit : mm

SYMBOL	DIMENSIONS	
	MIN.	MAX.
A	7.800	8.500
A1	5.000	5.200
A2	0.900	1.200
B	7.200	8.000
C	9.700	10.200
D	6.200	6.500
E	2.350	3.000
E1	1.300	1.600
e	0.200	0.350

Marking

Type number	Marking code
LTD201B	DB201S
LTD202B	DB202S
LTD203B	DB203S
LTD204B	DB204S
LTD205B	DB205S
LTD206B	DB206S
LTD207B	DB207S

Reel Dimensions

Unit : mm

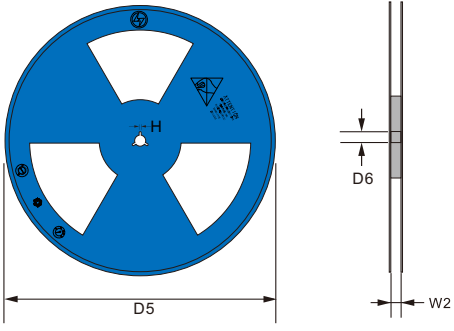
<p>13" Reel</p> 	D5	$\Phi 330.0 \pm 2.0$
	D6	$\Phi 13.5 \pm 0.5$
	H	2.5 ± 1.0
	W2	12 ± 2.0
	Quantity: 1500PCS	

Packaging

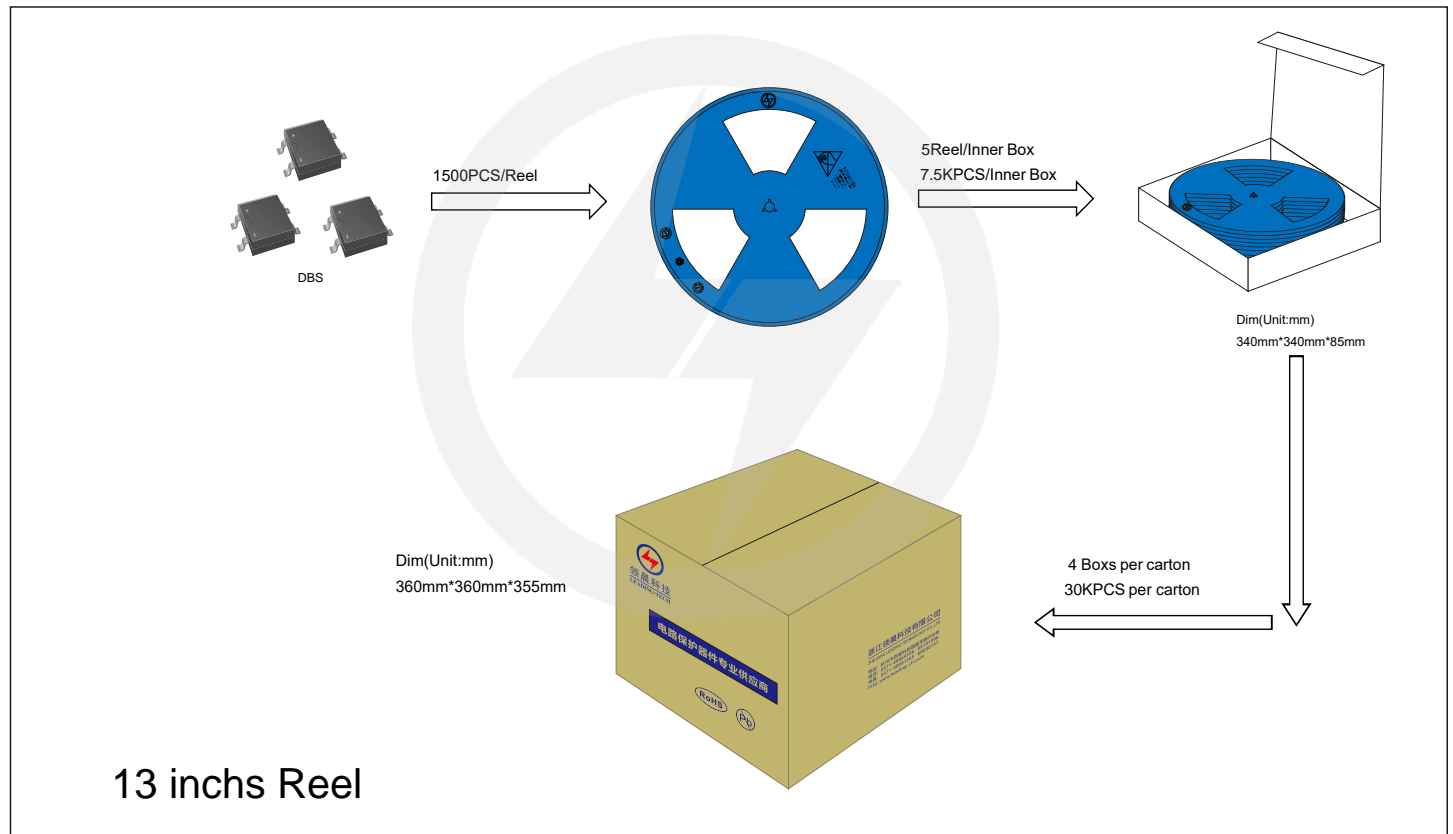



Recommended Soldering Conditions



Recommended Conditions

Profile Feature	Pb-Free Assembly
Average ramp-up rate (T_L to T_P)	3°C/second max.
Preheat	
-Temperature Min ($T_{S\ min}$)	150°C
-Temperature Max ($T_{S\ max}$)	200°C
-Time (min to max) (t_s)	60-180 seconds
$T_{S\ max}$ to T_L	
-Ramp-up Rate	3°C/second max.
Time maintained above:	
-Temperature (T_L)	217°C
-Time (t_L)	60-150 seconds
Peak Temperature (T_P)	260°C
Time within 5°C of actual Peak Temperature (t_p)	20-40 seconds
Ramp-down Rate	6°C/second max.
Time 25°C to Peak Temperature	8 minutes max.

Important Notice and Disclaimer

Leading-Tech reserves the right to make changes to this document and its products and specifications at any time without notice.

Customers should obtain and confirm the latest product information and specifications before final design, purchase or use.

Leading-Tech makes no warranty, representation or guarantee regarding the suitability of its products for any particular purpose, not does Leading-Tech assume any liability for application assistance or customer product design.

Leading-tech does not warrant or accept any liability with products which are purchase or used for any unintended or unauthorized application.

No license is granted by implication or otherwise under any intellectual property rights of Leading-Tech.

Leading-Tech products are not authorized for use as critical components in life support devices or systems without express written approval of Leading-tech.

Version Update Information

Series NO.	Enactment/Revision Date	Effective Date	Version	Revision content	Revision Reason	Revision Person	Note
01	2024.8.24	2024.8.24	3.0	New File	/	Ding	
02	2025.05.29	2025.05.29	3.1	Update packaging information	/	Ding	