

Surface Mount Bridge Rectifier

Features

- Reverse Voltage 2000V
- Forward Current 1 A
- High Surge Current Capability
- Designed for Surface Mount Application
- Lead free in comply with EU RoHS 2011/65/EU directives

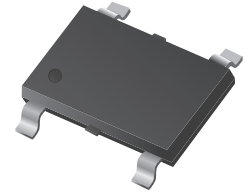

Mechanical Data

- Case : SOP-4B
- Terminals: Solderable per MIL-STD-750, Method 2026

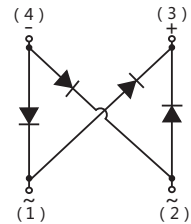

Ordering Information

Part Number	Marking	Shipping	Reel
LT4P20-10-TR5	LT4P20-10	5000PCS Tape&Reel	13 inches

Maximum Ratings and Electrical Characteristics

Ratings at 25 °C ambient temperature unless otherwise specified.

Single phase half-wave 60 Hz, resistive or inductive load, for capacitive load current derate by 20 %.

Parameter	Symbol	LT4P20-10	Unit
Maximum Repetitive Peak Reverse Voltage	V_{RRM}	2000	V
Maximum RMS voltage	V_{RMS}	1400	V
Maximum DC Blocking Voltage	V_{DC}	2000	V
Average Rectified Output Current at $T_c = 125\text{ °C}$	I_o	1	A
Peak Forward Surge Current 8.3 ms Single Half Sine Wave Superimposed on Rated Load (JEDEC Method)	I_{FSM}	30	A
Maximum Forward Voltage at 1.0 A	V_F	1.2	V
Maximum DC Reverse Current at Rated DC Blocking Voltage @ $T_A=25\text{ °C}$ @ $T_A=125\text{ °C}$	I_R	1 100	μA
Typical Junction Capacitance (Note1)	C_j	20	pF
Operating and Storage Temperature Range	T_j, T_{stg}	-55 ~ +150	°C

Note: 1. Measured at 1MHz and applied reverse voltage of 4 V D.C.

Characteristic Curves

Fig.1 Average Rectified Output Current Derating Curve

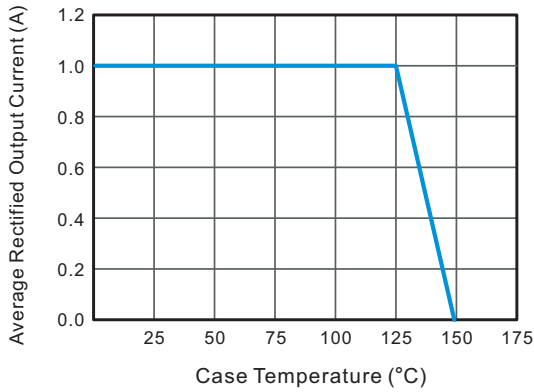

Fig.2 Typical Reverse Characteristics

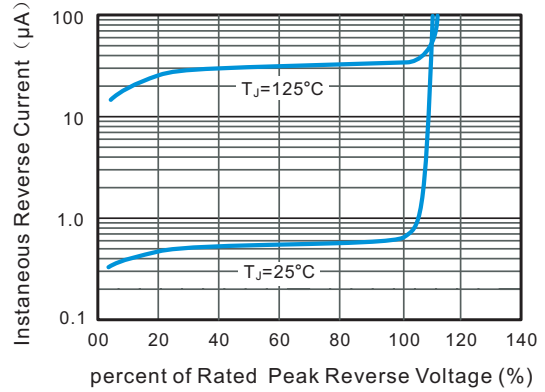

Fig.3 Typical Instantaneous Forward Characteristics

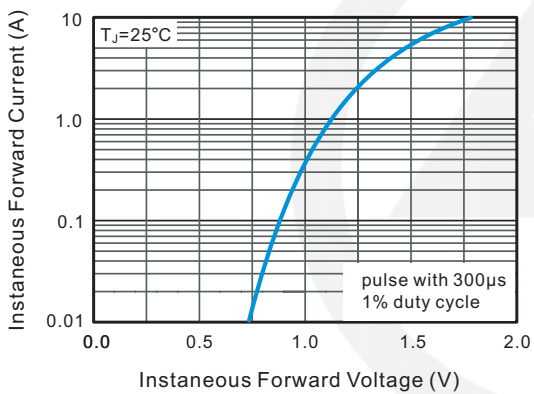

Fig.4 Typical Junction Capacitance

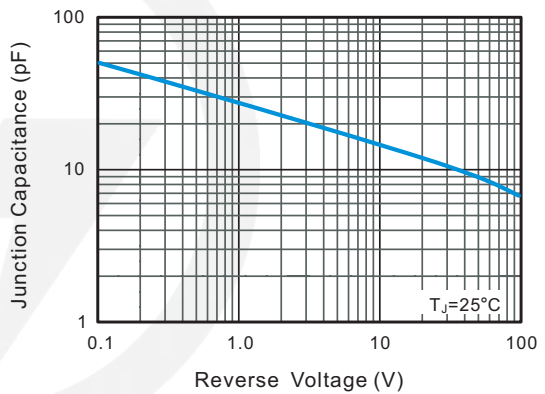
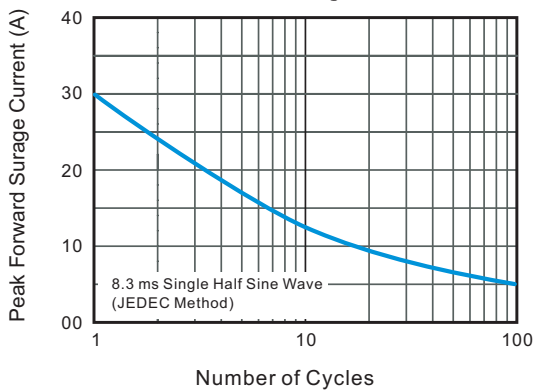
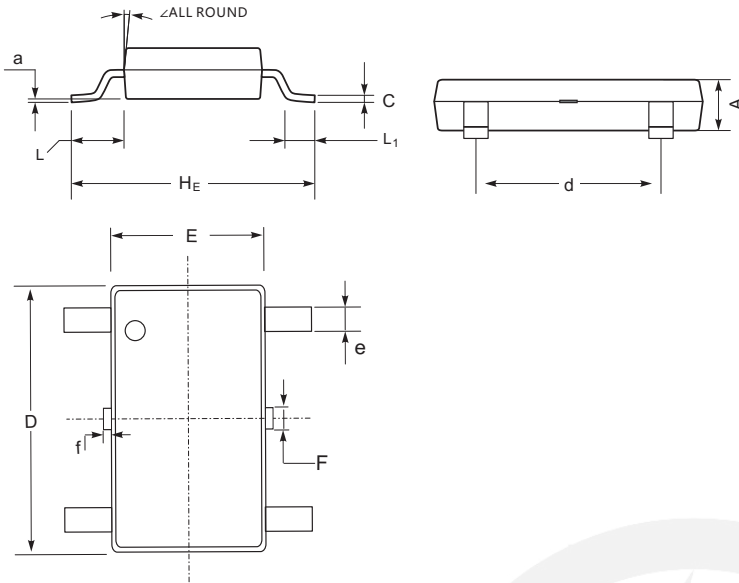

Fig.5 Maximum Non-Repetitive Peak Forward Surge Current



SOP-4B Package Outline

Unit: mm



SYMBOL	DIMENSIONS	
	MIN.	MAX.
A	1.05	1.25
C	0.15	0.22
D	6.10	6.30
E	3.60	4.10
HE	5.90	6.10
d	4.60	5.00
e	0.50	0.80
L	0.95	1.15
L ₁	0.40	0.80
a	0.2ref.	
F	0.8TYPICAL	
f	0.3TYPICAL	
∠	12°	

SOP-4B Suggested Pad Layout

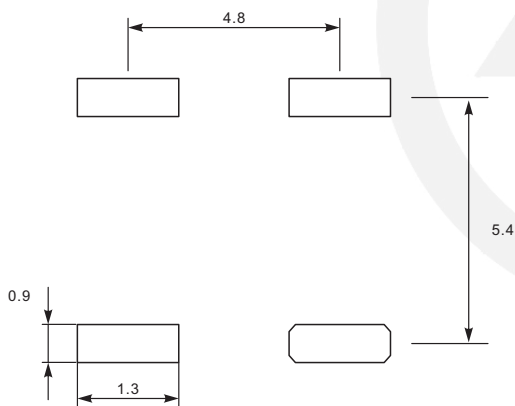

- Note:
1. Controlling dimension: in millimeters.
 2. General tolerance: $\pm 0.05\text{mm}$
 3. The pad layout is for reference purpose only.

Reel Dimensions

Unit : mm

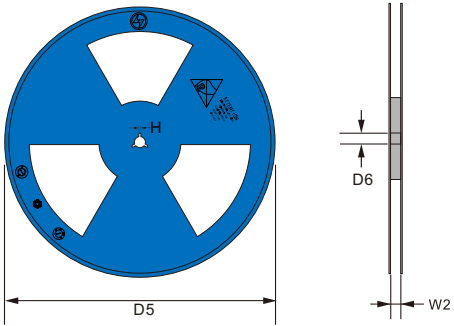
<p>13" Reel</p> 	D5	$\Phi 330.0 \pm 2.0$
	D6	$\Phi 13.5 \pm 0.5$
	H	2.5 ± 1.0
	W2	12 ± 2.0
	Quantity: 5000PCS	

Packaging

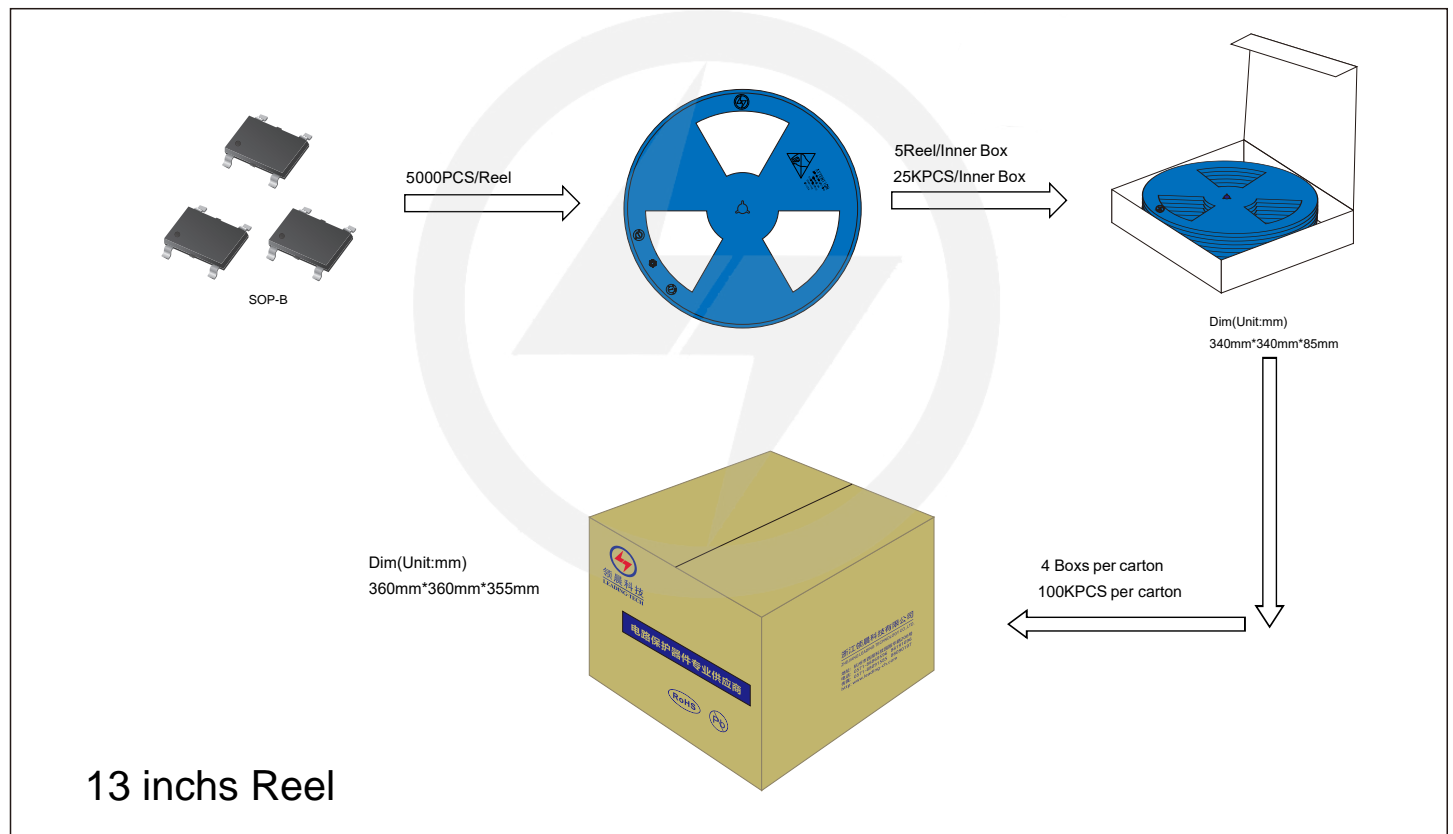



Recommended Soldering Conditions

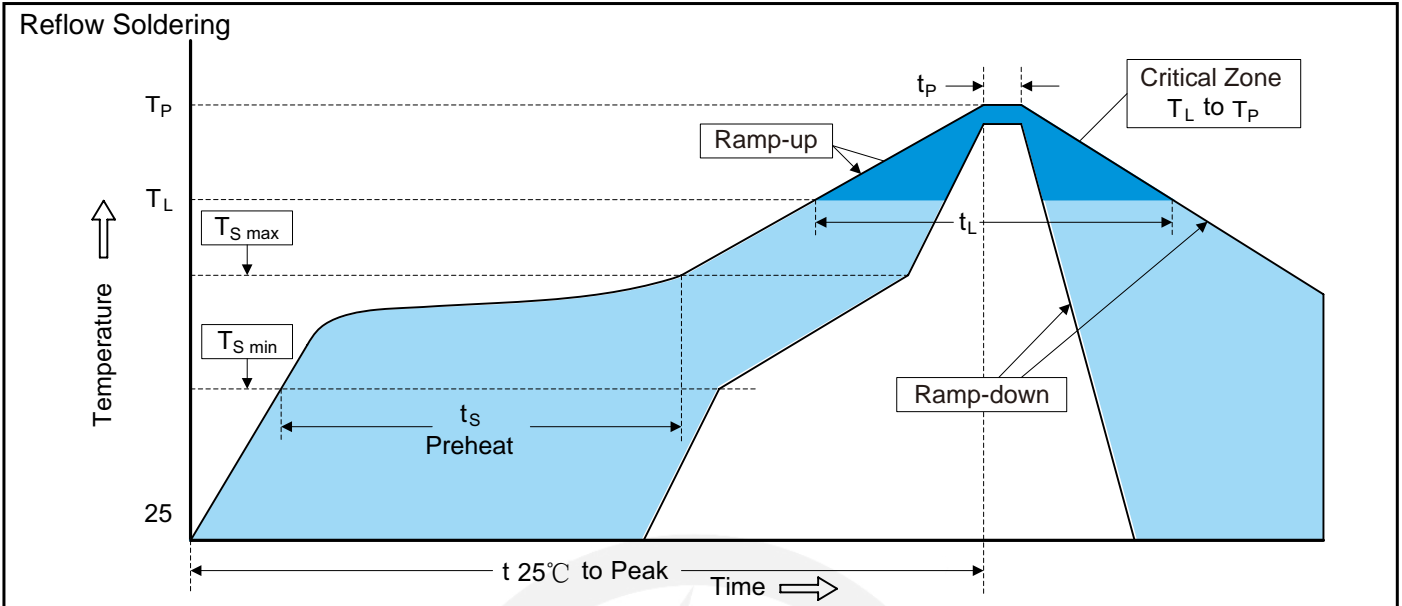

Recommended Conditions

Profile Feature	Pb-Free Assembly
Average ramp-up rate (T _L to T _P)	3°C/second max.
Preheat	
-Temperature Min (T _{S min})	150°C
-Temperature Max (T _{S max})	200°C
-Time (min to max) (t _s)	60-180 seconds
T _{S max} to T _L	
-Ramp-up Rate	3°C/second max.
Time maintained above:	
-Temperature (T _L)	217°C
-Time (t _L)	60-150 seconds
Peak Temperature (T _P)	260°C
Time within 5°C of actual Peak Temperature (t _p)	20-40 seconds
Ramp-down Rate	6°C/second max.
Time 25°C to Peak Temperature	8 minutes max.

Important Notice and Disclaimer

Leading-Tech reserves the right to make changes to this document and its products and specifications at any time without notice.

Customers should obtain and confirm the latest product information and specifications before final design, purchase or use.

Leading-Tech makes no warranty, representation or guarantee regarding the suitability of its products for any particular purpose, not does Leading-Tech assume any liability for application assistance or customer product design.

Leading-tech does not warrant or accept any liability with products which are purchase or used for any unintended or unauthorized application.

No license is granted by implication or otherwise under any intellectual property rights of Leading-Tech.

Leading-Tech products are not authorized for use as critical components in life support devices or systems without express written approval of Leading-tech.

Version Update Information

Series NO.	Enactment/Revision Date	Effective Date	Version	Revision content	Revision Reason	Revision Person	Note
01	2024.04.19	2024.04.19	3.0	New File	/	Ding	