

Switching Diodes

Features

- For surface mounted applications
- Fast reverse recovery time
- Ideal for automated placement
- Lead free in comply with EU RoHS 2011/65/EU directives

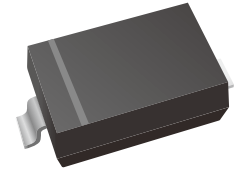

Mechanical Data

- Case: SOD-123
- Terminals: Solderable per MIL-STD-750, Method 2026
- Polarity: Color band denotes cathode end

Ordering Information

Part Number	Marking	Shipping	Reel
LT4148WA-TR3	T4 or G1	3000PCS Tape&Reel	7 inchs
LT4148WA-TR12	T4 or G1	12000PCS Tape&Reel	13 inchs

Absolute Maximum Ratings (Ta=25°C)

Parameter	Symbol	LT4148WA	Unit
Maximum Repetitive Peak Reverse Voltage	V_{RRM}	100	V
Maximum RMS voltage	V_{RMS}	75	V
Average Rectified Forward Current	$I_{F(AV)}$	200	mA
Non-repetitive Peak Forward Surge Current	I_{FSM}	0.5 1 4	A
Total Power Dissipation	P_{tot}	400	mW
Typical Thermal Resistance (Note1)	$R_{\theta JA}$ $R_{\theta JC}$	280 100	°C/W
Operating and Storage Temperature Range	T_j, T_{stg}	-55 ~ +150	°C

Note: (1) P.C.B. mounted with 5mm × 5mm copper pad areas.

Characteristics (Ta=25°C)

Parameter	Symbol	LT4148WA	Unit
Reverse Breakdown Voltage at $I_R=1\mu A$	$V_{(BR)R}$	75	V
Maximum Forward Voltage at 1 mA at 10 mA at 50 mA at 150 mA	V_F	0.715 0.855 1.00 1.25	V
Peak Reverse Current at $V_R=20V$ $T_J=25^\circ C$ at $V_R=75V$ $T_J=25^\circ C$	I_R	0.025 1	μA
Typical Junction Capacitance $f=1MHz, V_R=0V$	C_j	2	pF
Maximum Reverse Recovery Time (Note2)	t_{rr}	4	ns

Note: (2) Measured with $I_F=I_R=10mA, I_{rr}=0.1 \times I_R, R_L=100\Omega$

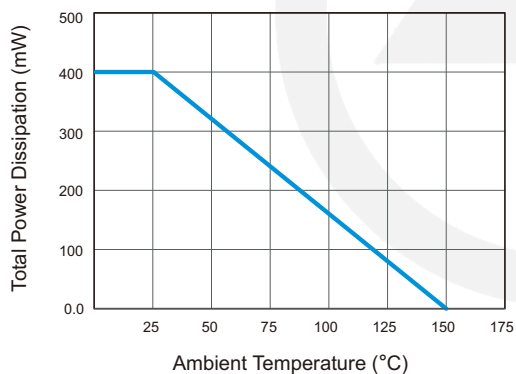
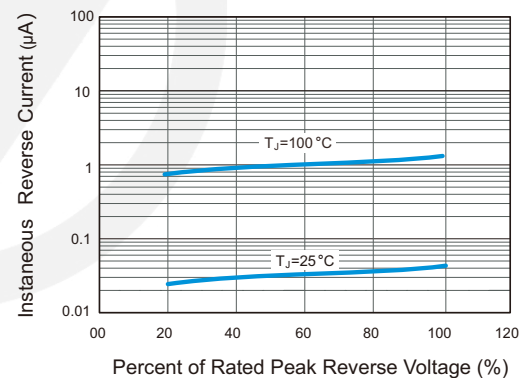
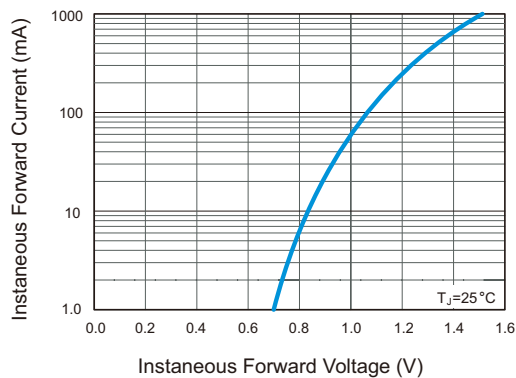
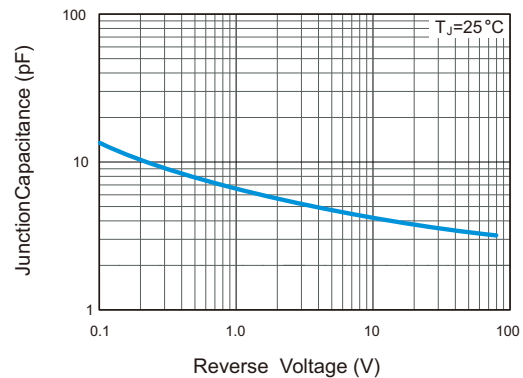
Characteristics Curve
Fig.1 Power Derating Curve

Fig.2 Typical Reverse Characteristics

Fig.3 Typical Instantaneous Forward Characteristics

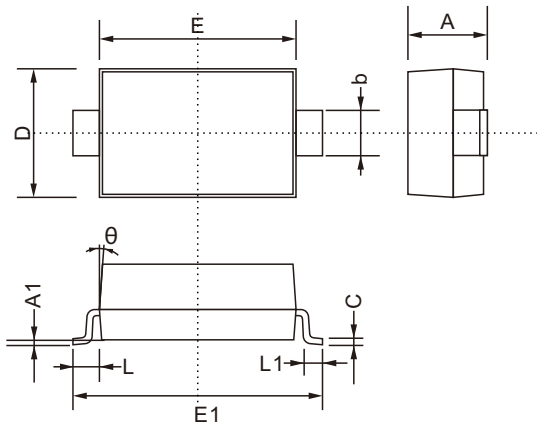
Fig.4 Typical Junction Capacitance

SOD-123 Package Outline

Unit: mm



SYMBOL	DIMENSIONS	
	MIN.	MAX.
A	0.900	1.300
A1	0.000	0.200
b	0.450	0.750
C	0.080	0.230
D	1.500	1.800
E	2.500	2.800
E1	3.550	3.900
L	0.5REF	
θ	8°	

SOD-123 Suggested Pad Layout

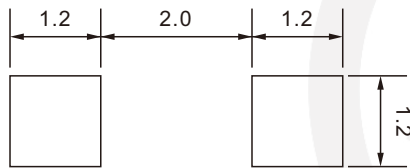

- Note:
1. Controlling dimension: in millimeters.
 2. General tolerance: $\pm 0.05\text{mm}$
 3. The pad layout is for reference purpose only.

Carrier Tape Dimensions

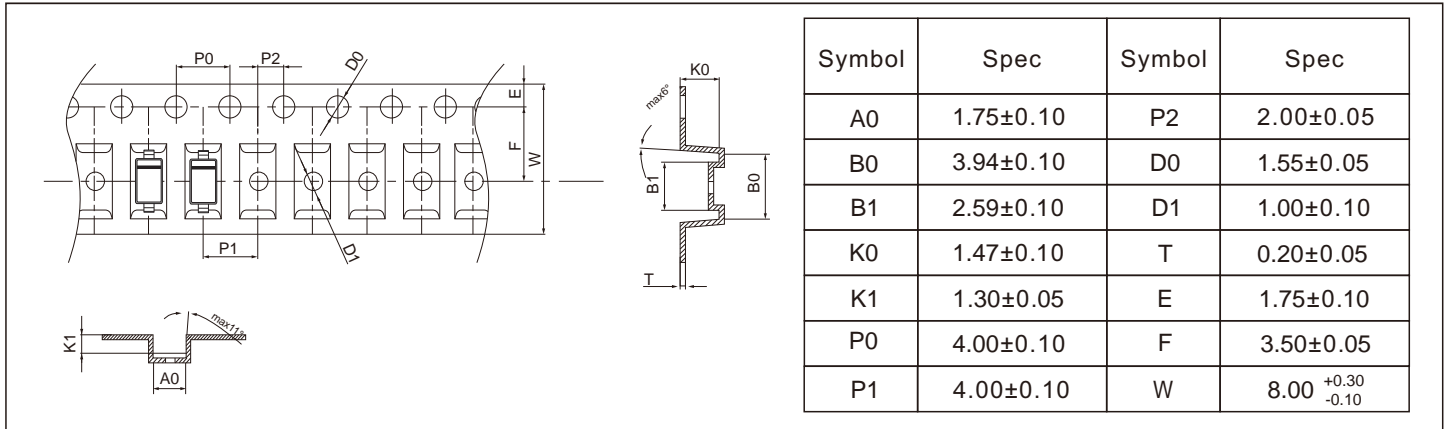

Reel Dimensions

Unit : mm

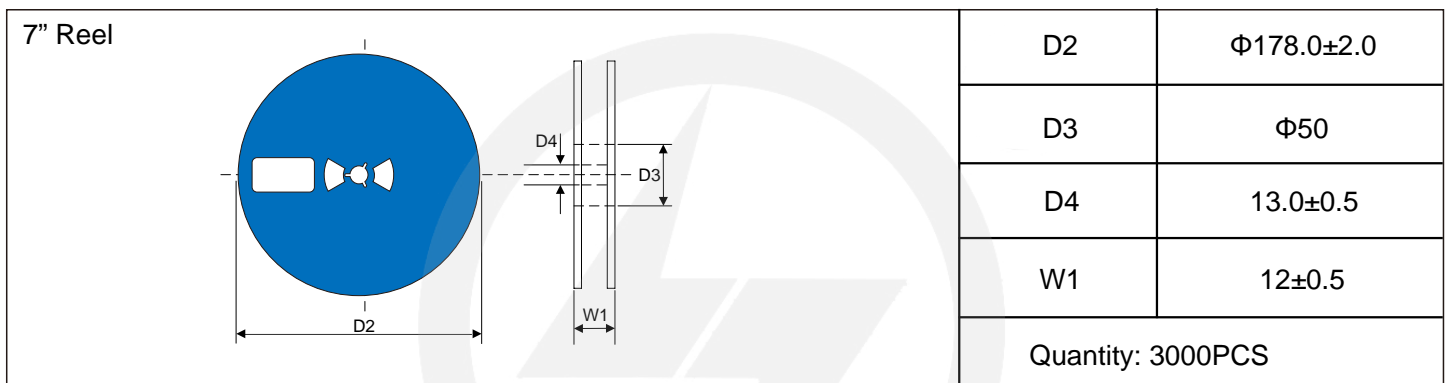

Reel Dimensions

Unit : mm

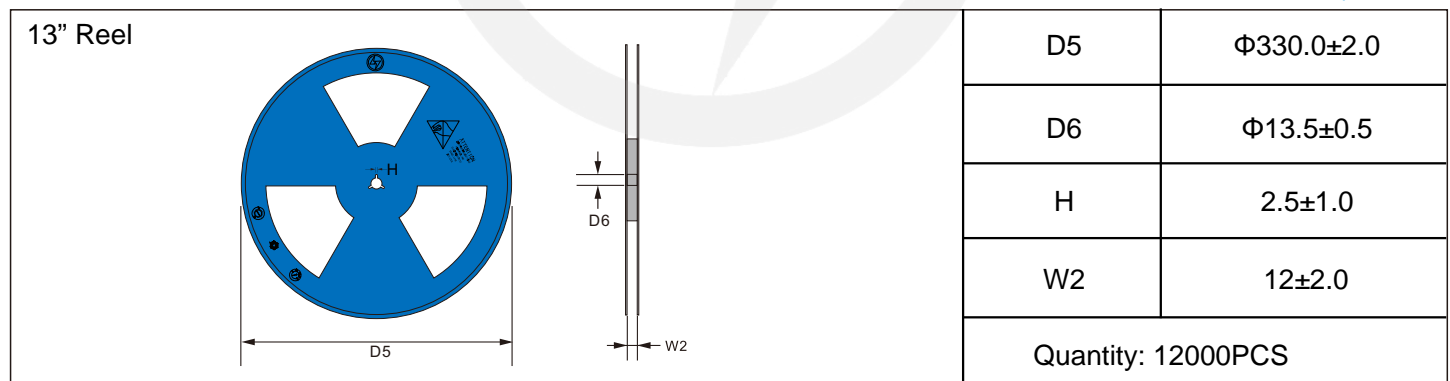

Packaging

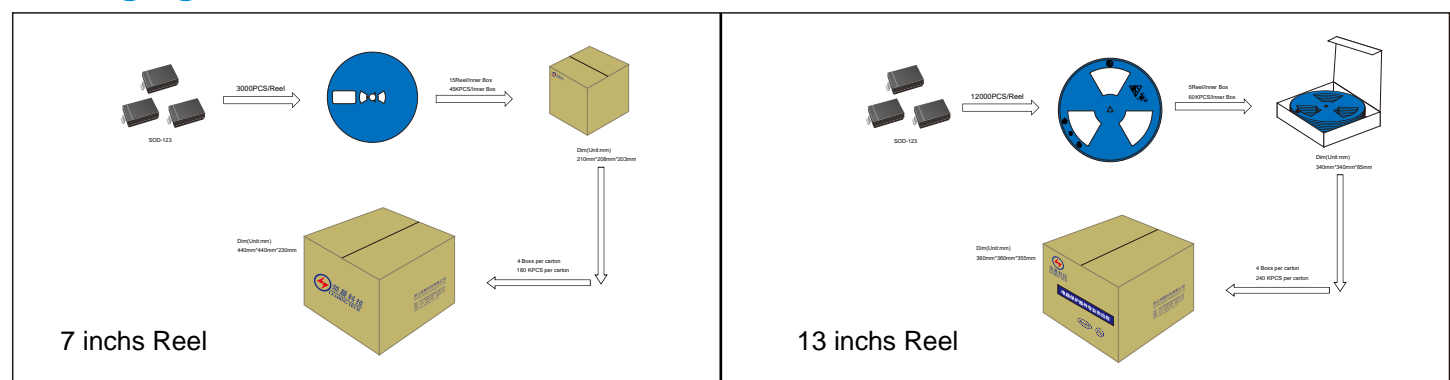



Recommended Soldering Conditions

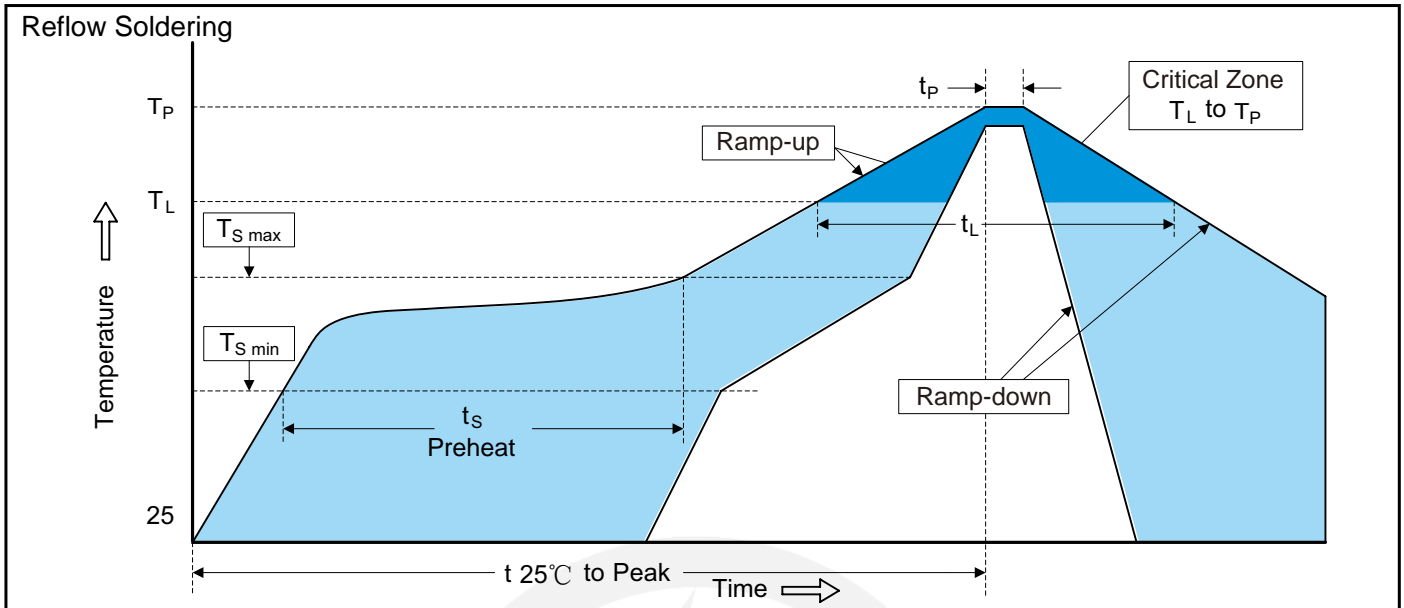

Recommended Conditions

Profile Feature	Pb-Free Assembly
Average ramp-up rate (T _L to T _P)	3°C/second max.
Preheat	
-Temperature Min (T _{S min})	150°C
-Temperature Max (T _{S max})	200°C
-Time (min to max) (t _s)	60-180 seconds
T _{S max} to T _L	
-Ramp-up Rate	3°C/second max.
Time maintained above:	
-Temperature (T _L)	217°C
-Time (t _L)	60-150 seconds
Peak Temperature (T _P)	260°C
Time within 5°C of actual Peak Temperature (t _p)	20-40 seconds
Ramp-down Rate	6°C/second max.
Time 25°C to Peak Temperature	8 minutes max.

Important Notice and Disclaimer

Leading-Tech reserves the right to make changes to this document and its products and specifications at any time without notice.

Customers should obtain and confirm the latest product information and specifications before final design, purchase or use.

Leading-Tech makes no warranty, representation or guarantee regarding the suitability of its products for any particular purpose, nor does Leading-Tech assume any liability for application assistance or customer product design.

Leading-tech does not warrant or accept any liability with products which are purchase or used for any unintended or unauthorized application.

No license is granted by implication or otherwise under any intellectual property rights of Leading-Tech.

Leading-Tech products are not authorized for use as critical components in life support devices or systems without express written approval of Leading-tech.

Version Update Information

Series NO.	Enactment/Revision Date	Effective Date	Version	Revision content	Revision Reason	Revision Person	Note
01	2024.3.14	2024.3.14	3.0	New File	/	Ding	
02	2025.06.17	2025.06.17	3.1	Update packaging information	/	Ding	