

## Transistor(PNP)

### Features

- Low saturation voltage
- Lead free in comply with EU RoHS 2011/65/EU directives

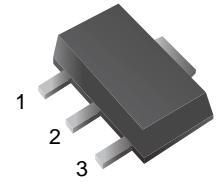

### Ordering Information

Part Number	Marking	Shipping	Reel
LT2AR553-TR1	DL	1000PCS Tape&Reel	7 inches
LT2AR553-TR3	DL	3000PCS Tape&Reel	13 inches

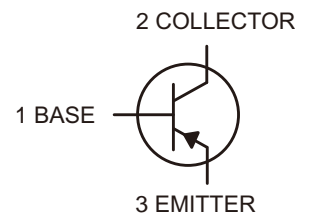

### Maximum Ratings ( Ta=25 unless otherwise noted )

Parameter	Symbol	Value	Unit
Collector Base Voltage	$-V_{CBO}$	50	V
Collector Emitter Voltage	$-V_{CEO}$	50	V
Emitter Base Voltage	$-V_{EBO}$	6	V
Collector Current	$-I_C$	2	A
Maximum Power Dissipation	$P_D$	0.5	W
Junction Temperature	$T_J$	150	°C
Storage Temperature Range	$T_{STG}$	-55 to +150	°C

### Electrical characteristics ( Ta=25 unless otherwise specified )

Parameter	Symbol	Min	Typ	Max	Unit
DC Current Gain at $V_{CE} = -2\text{ V}$ , $I_C = -50\text{ mA}$	$H_{FE}$	180		450	
Collector Base Cutoff Current at $V_{CB} = -50\text{ V}$	$-I_{CBO}$			0.1	$\mu\text{A}$
Emitter Base Cutoff Current at $V_{EB} = -4\text{ V}$	$-I_{EBO}$			0.1	$\mu\text{A}$
Collector Base Breakdown Voltage at $I_C = -100\ \mu\text{A}$	$-V_{(BR)CBO}$	50			V
Collector Emitter Breakdown Voltage at $I_C = -1\text{ mA}$	$-V_{(BR)CEO}$	50			V
Emitter Base Breakdown Voltage at $I_E = -100\ \mu\text{A}$	$-V_{(BR)EBO}$	6			V
Collector Emitter Saturation Voltage at $I_C = -700\text{ mA}$ , $I_B = -35\text{ mA}$	$-V_{CE(sat)}$			0.4	V
Base Emitter Saturation Voltage at $I_C = -500\text{ mA}$ , $I_B = -50\text{ mA}$	$-V_{BE(sat)}$			1.2	V
Transition Frequency at $V_{CE} = -10\text{ V}$ , $I_E = -300\text{ mA}$ , $f=100\text{MHz}$	$F_T$		320		MHz

**Characteristics Curves**

**Fig.1 Ground Emitter Propagation Characteristics**

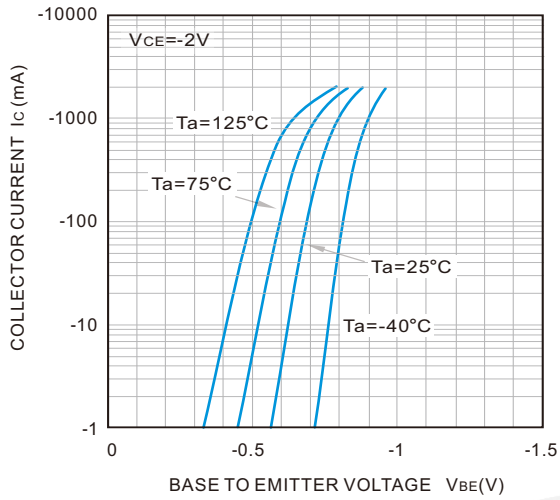

**Fig.2 Typical Output Characteristics**

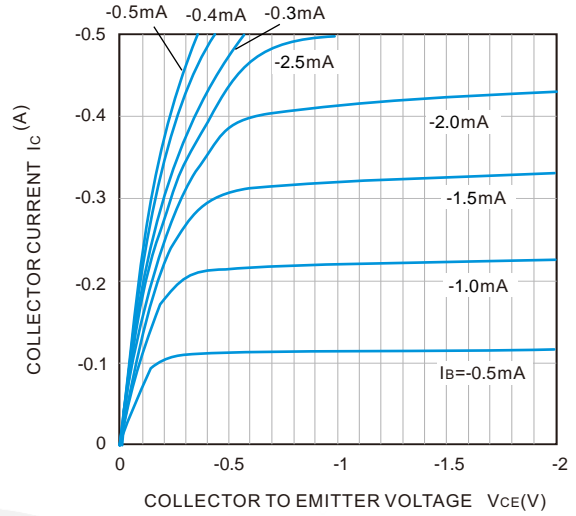

**Fig.3 DC Current Gain vs Collector Current (1)**

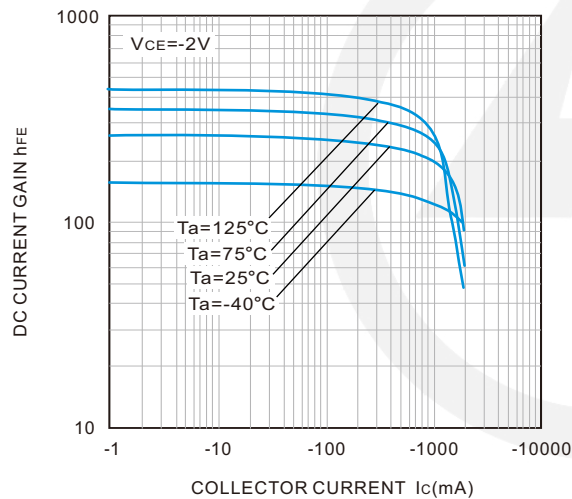

**Fig.4 DC Current Gain vs Output Current (2)**

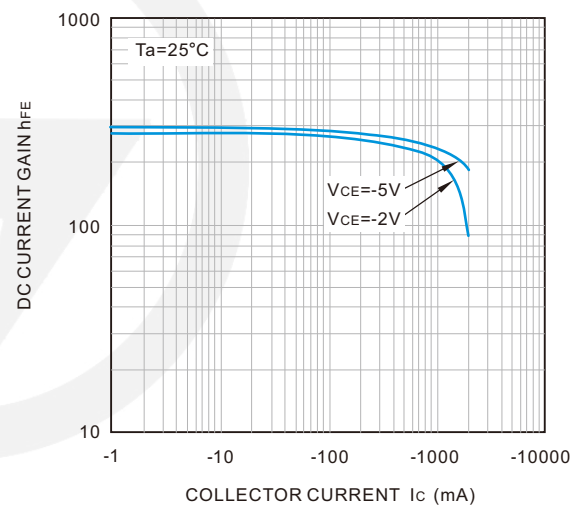

**Fig.5 Collector-Emitter Saturation Voltage vs Collector Current (1)**

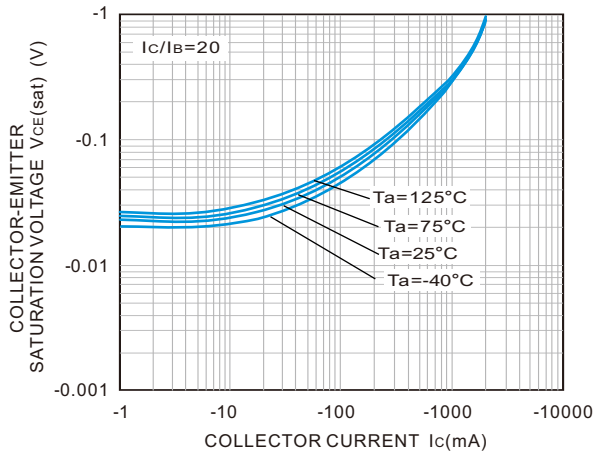

**Fig.6 Collector-Emitter Saturation Voltage vs Collector Current (2)**

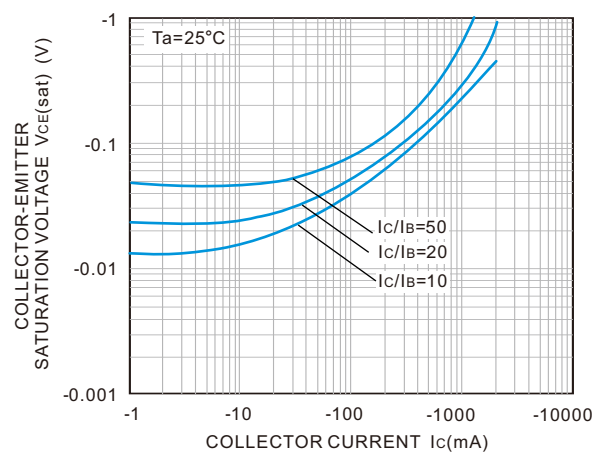



Fig.7 Base-Emitter Saturation Voltage vs Collector Current

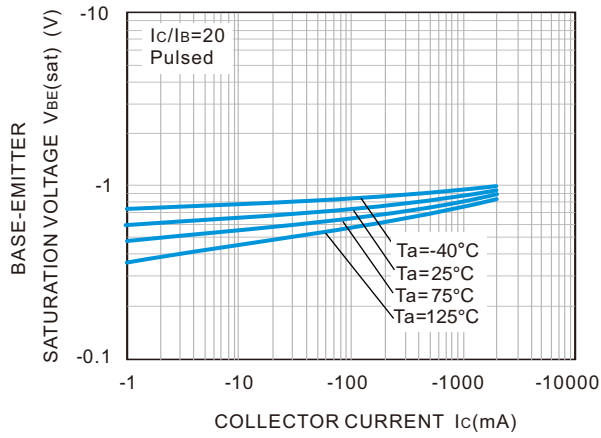

Fig.8 Gain Bandwidth Product vs Emitter Current

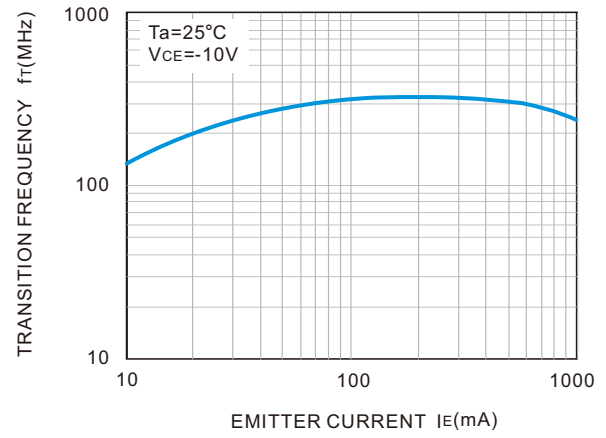

Fig.9 Emitter Input Capacitance vs Emitter-Base Voltage  
Collector Output Capacitance vs Collector-Base Voltage

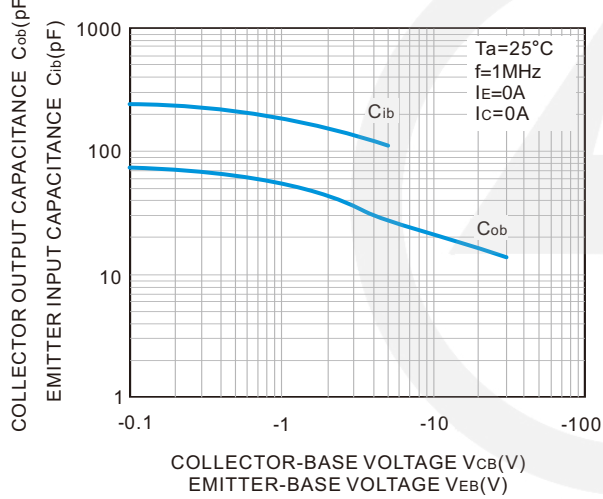
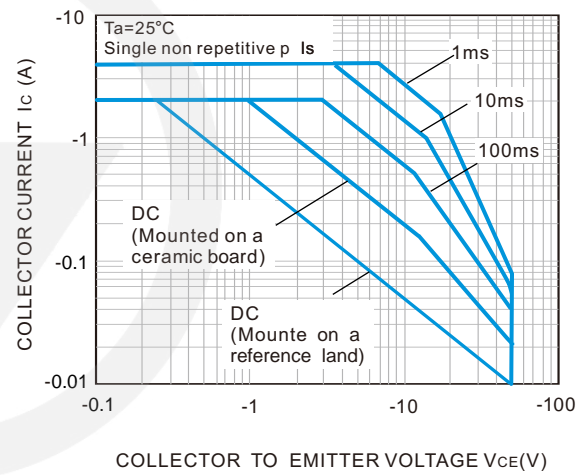
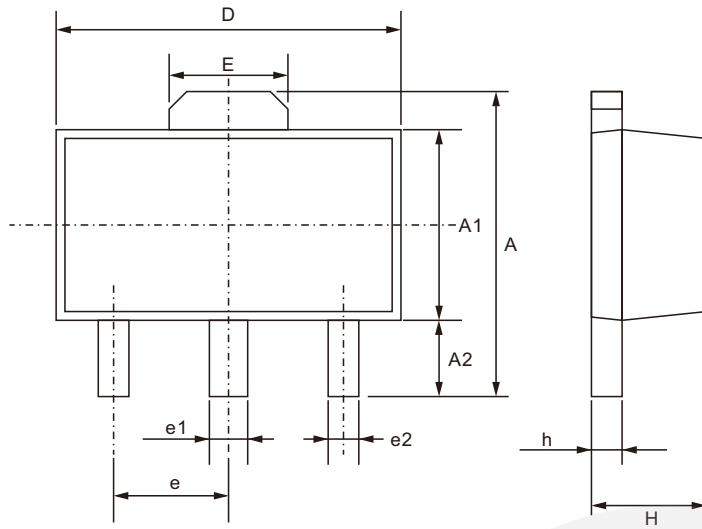

Fig.10 Safe Operating Area



**SOT-89 Package Outline**



Unit: mm

SYMBOL	DIMENSIONS	
	MIN.	MAX.
A	3.750	4.250
A1	2.400	2.600
A2	0.950	1.050
D	4.400	4.600
E	1.500	1.600
e1	0.470	0.530
e2	0.350	0.450
e	1.500 TYP.	
H	1.400	1.600
h	0.300	0.500

**SOT-89 Suggested Pad Layout**

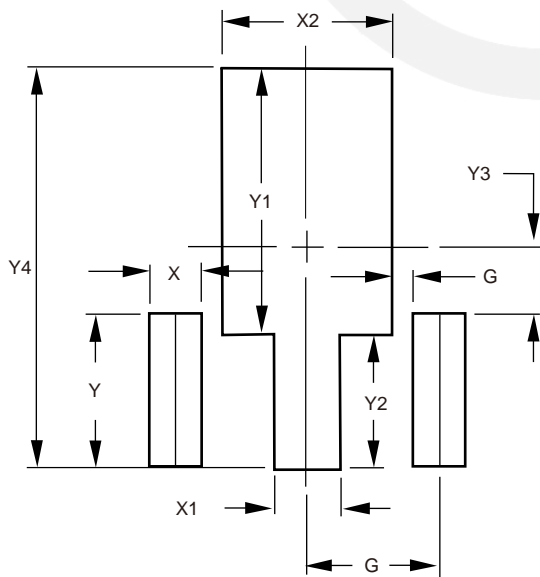

Dimensions	Value (in mm)
C	1.500
G	0.244
X	0.580
X1	0.760
X2	1.933
Y	1.730
Y1	3.030
Y2	1.500
Y3	0.770
Y4	4.530

**Carrier Tape Dimensions**

Unit : mm

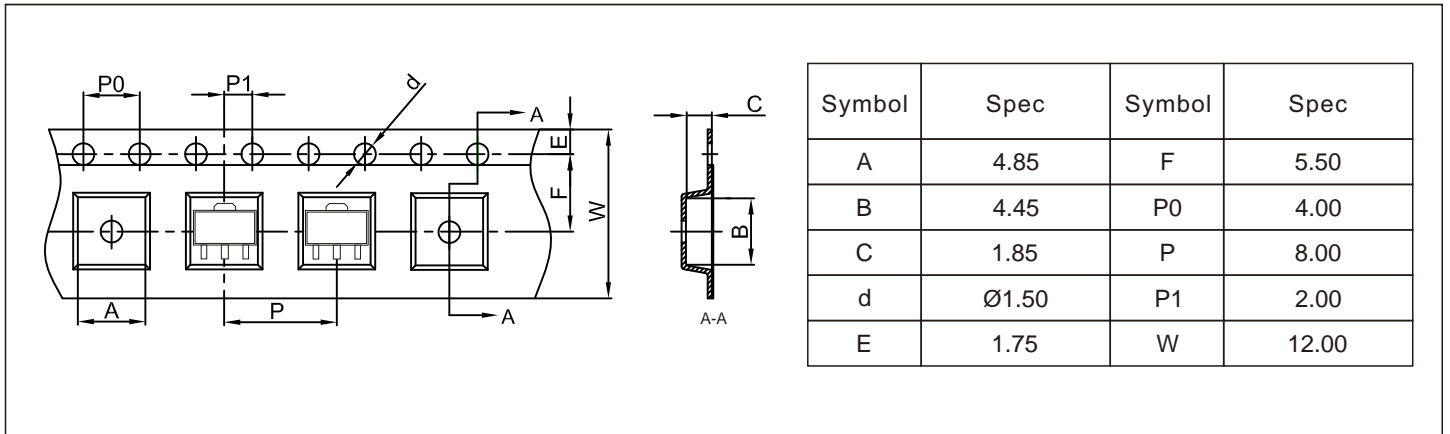

**Reel Dimensions**

Unit : mm

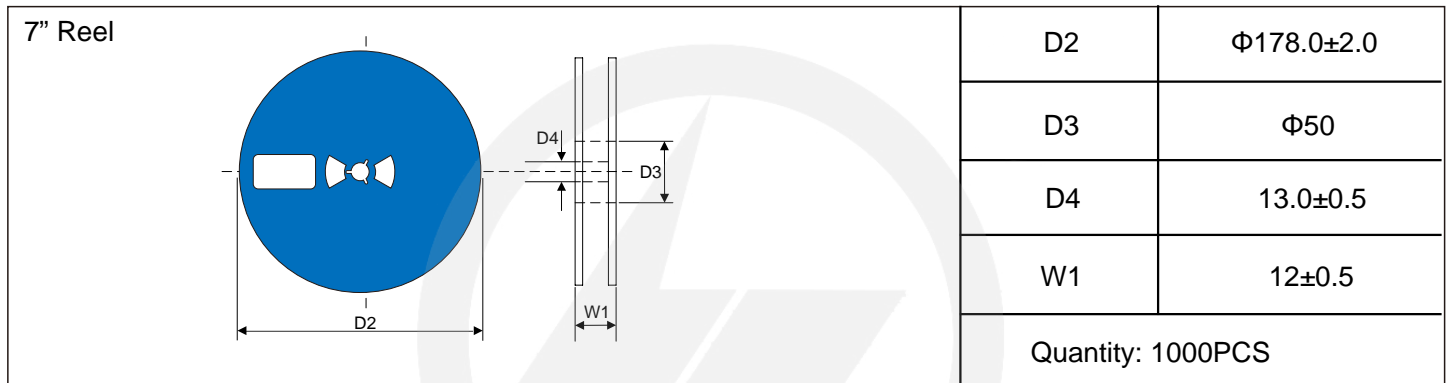

**Reel Dimensions**

Unit : mm

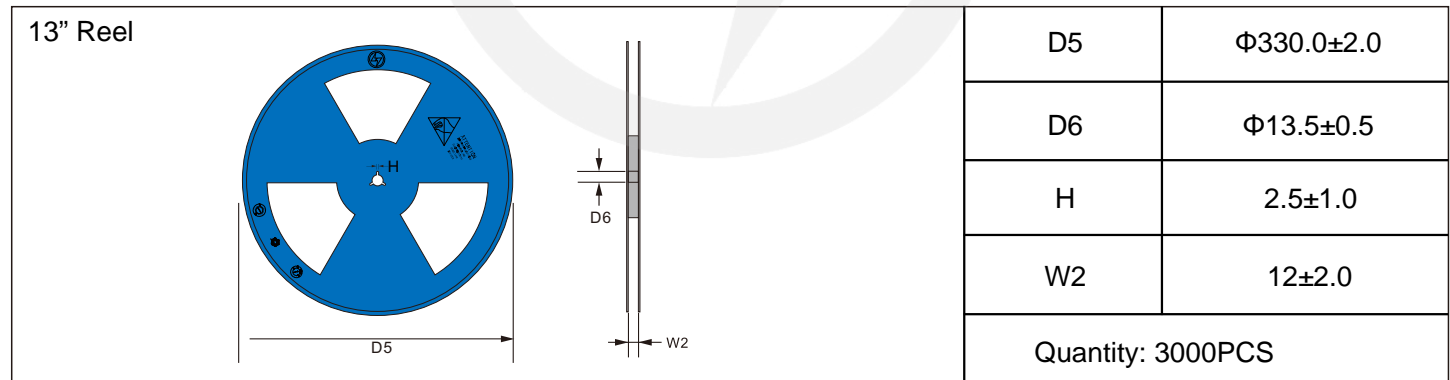

**Packaging**

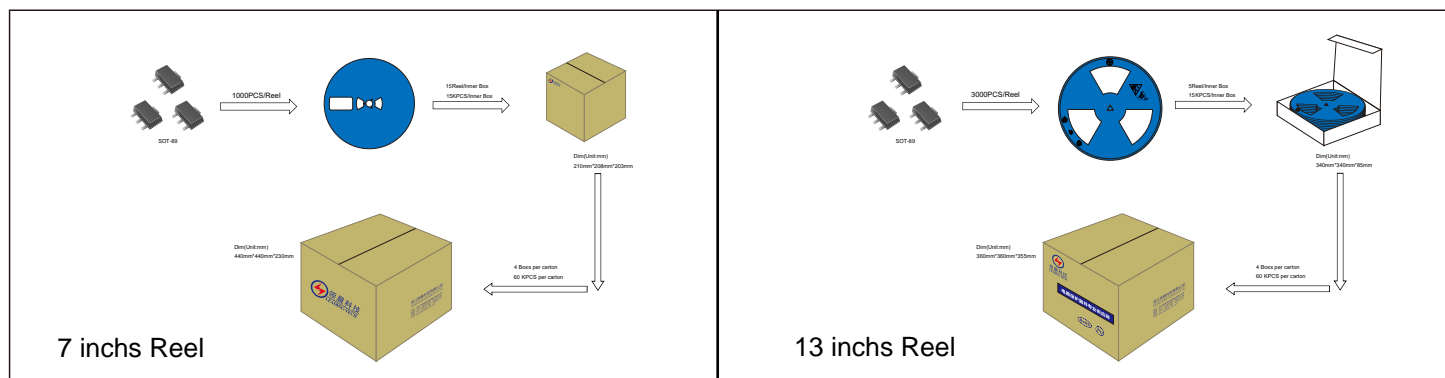



Recommended Soldering Conditions

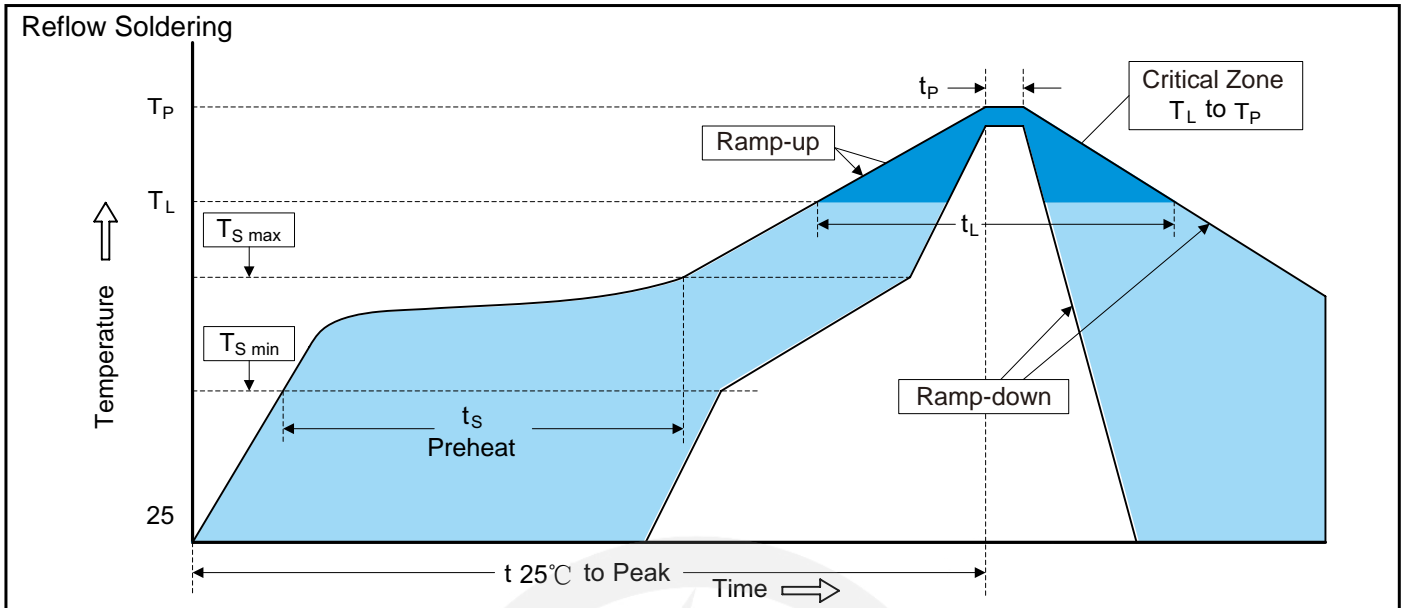

Recommended Conditions

Profile Feature	Pb-Free Assembly
Average ramp-up rate (T <sub>L</sub> to T <sub>P</sub> )	3°C/second max.
Preheat	
-Temperature Min (T <sub>S min</sub> )	150°C
-Temperature Max (T <sub>S max</sub> )	200°C
-Time (min to max) (t <sub>s</sub> )	60-180 seconds
T <sub>S max</sub> to T <sub>L</sub>	
-Ramp-up Rate	3°C/second max.
Time maintained above:	
-Temperature (T <sub>L</sub> )	217°C
-Time (t <sub>L</sub> )	60-150 seconds
Peak Temperature (T <sub>P</sub> )	260°C
Time within 5°C of actual Peak Temperature (t <sub>p</sub> )	20-40 seconds
Ramp-down Rate	6°C/second max.
Time 25°C to Peak Temperature	8 minutes max.

## Important Notice and Disclaimer

Leading-Tech reserves the right to make changes to this document and its products and specifications at any time without notice.

Customers should obtain and confirm the latest product information and specifications before final design, purchase or use.

Leading-Tech makes no warranty, representation or guarantee regarding the suitability of its products for any particular purpose, not does Leading-Tech assume any liability for application assistance or customer product design.

Leading-tech does not warrant or accept any liability with products which are purchase or used for any unintended or unauthorized application.

No license is granted by implication or otherwise under any intellectual property rights of Leading-Tech.

Leading-Tech products are not authorized for use as critical components in life support devices or systems without express written approval of Leading-tech.

## Version Update Information

Series NO.	Enactment/Revision Date	Effective Date	Version	Revision content	Revision Reason	Revision Person	Note
01	2024.3.12	2024.3.12	3.0	New File	/	Ding	