

Features

- For surface mounted applications
- Fast reverse recovery time
- Ideal for automated placement
- Lead free in comply with EU RoHS 2011/65/EU directives

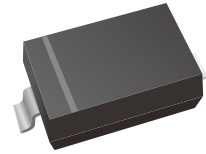

Mechanical Data

- Case: SOD-123
- Terminals: Solderable per MIL-STD-750, Method 2026
- Polarity: Color band denotes cathode end

Ordering Information

Part Number	Shipping	Reel
LT19W THRU LT21W -TR3	3000PCS Tape&Reel	7inchs
LT19W THRU LT21W -TR12	12000PCS Tape&Reel	13inchs

Maximum Ratings ($T_a=25$ unless otherwise noted)

Parameter	Symbols	LT19W	LT20W	LT21W	Unit
Non-Repetitive Peak Reverse Voltage	V_{RM}	120	200	250	V
RMS Reverse Voltage	V_{RMS}	71	106	141	V
Average Rectified Output Current	I_o	200			mA
Repetitive Peak Forward Current	I_{FRM}	625			mA
Non-repetitive Peak Forward Surge Current @ $t < 8.3\text{ms}$	I_{FSM}	2			A
Total Power Dissipation	P_{tot}	500			mW
Operating and Storage Temperature Range	T_j, T_{stg}	-55 ~ +150			°C

Electrical characteristics ($T_a=25$ unless otherwise specified)

Parameter	Symbol	LT19W	LT20W	LT21W	Unit
Reverse Breakdown Voltage at $I_R=100\mu\text{A}$	$V_{(BR)R}$	120	200	250	V
Maximum Forward Voltage at 100 mA at 200 mA	V_F	1.00 1.25			V
Maximum DC Reverse Current $T_a = 25^\circ\text{C}$ at Rated DC Blocking Voltage	I_R	0.1			μA
Typical Junction Capacitance at $V_R=0\text{V}$, $f=1\text{MHz}$	C_j	5			pF
Maximum Reverse Recovery Time (Note1)	t_{rr}	50			ns

Note : (1) Measured with $I_F = 0.5\text{A}$, $I_R = 1\text{A}$, $I_{rr} = 0.25\text{A}$



Characteristics Curves

Fig.1 Power Derating Curve

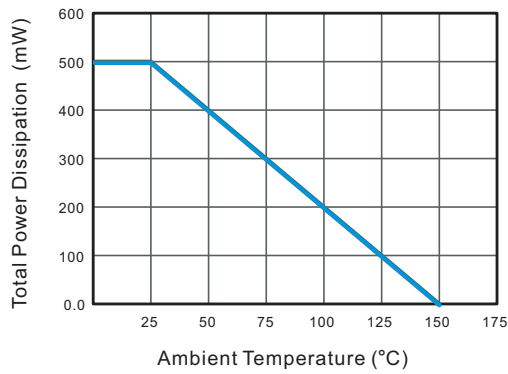

Fig.2 Typical Reverse Characteristics

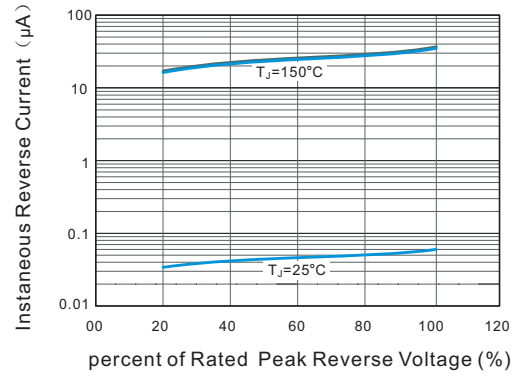

Fig.3 Typical Instantaneous Forward Characteristics

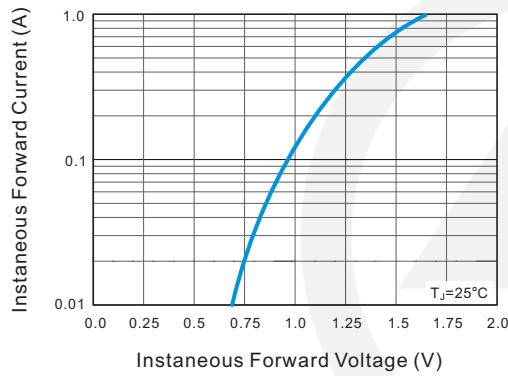
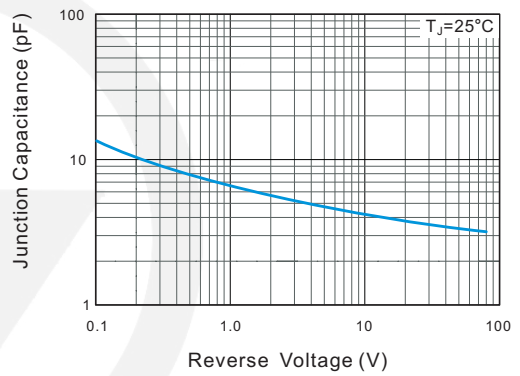
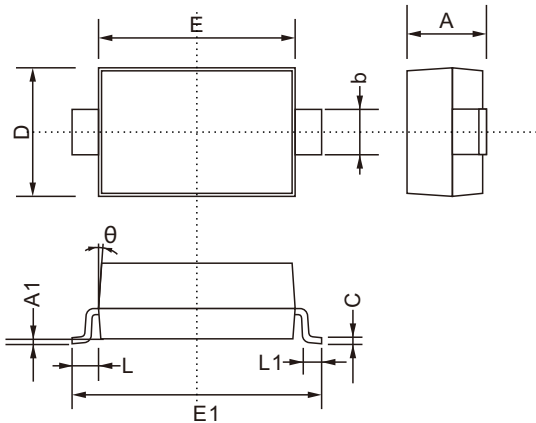

Fig.4 Typical Junction Capacitance



SOD-123 Package Outline

Unit: mm



SYMBOL	DIMENSIONS	
	MIN.	MAX.
A	0.900	1.300
A1	0.000	0.200
b	0.450	0.750
C	0.080	0.230
D	1.500	1.800
E	2.500	2.800
E1	3.550	3.900
L1	0.250	0.450
L	0.5REF	
θ	8°	

SOD-123 Suggested Pad Layout

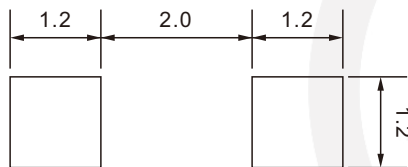

Note:

1. Controlling dimension: in millimeters.
2. General tolerance: $\pm 0.05\text{mm}$
3. The pad layout is for reference purpose only.

Marking

Type number	Marking code
LT19W	A8
LT20W	T2
LT21W	T3

Carrier Tape Dimensions

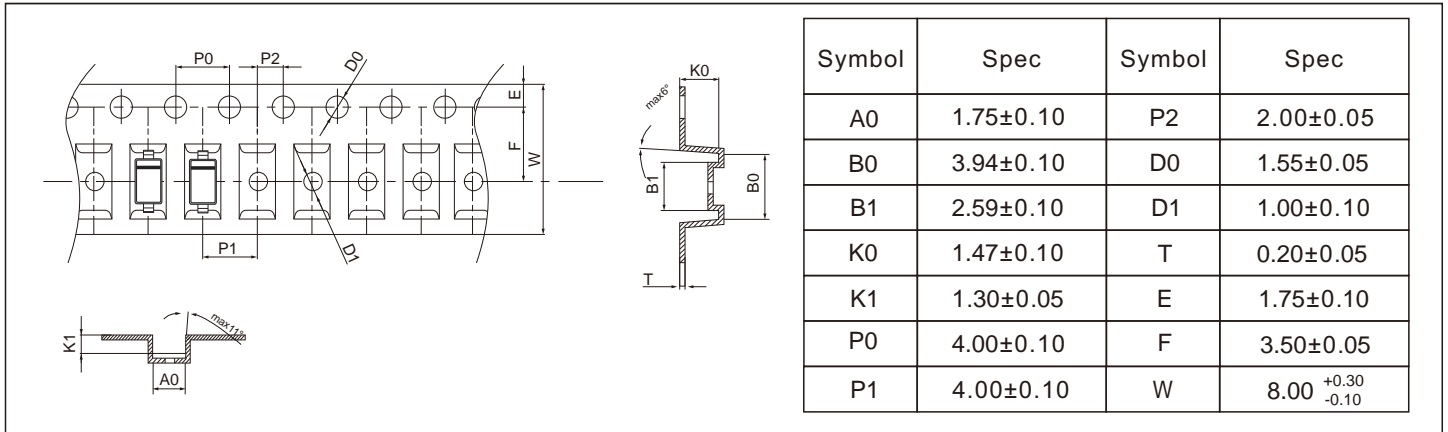

Reel Dimensions

Unit : mm

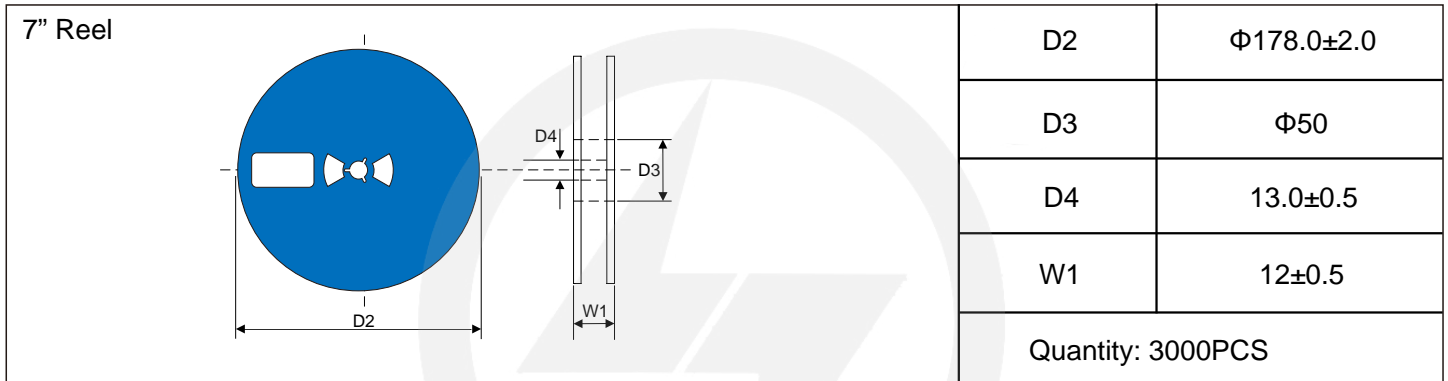

Reel Dimensions

Unit : mm

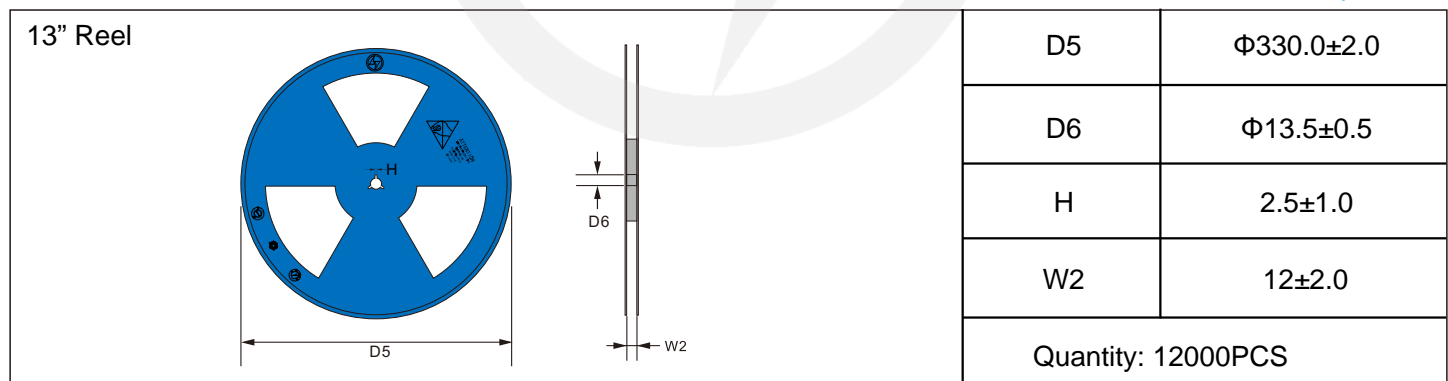

Packaging

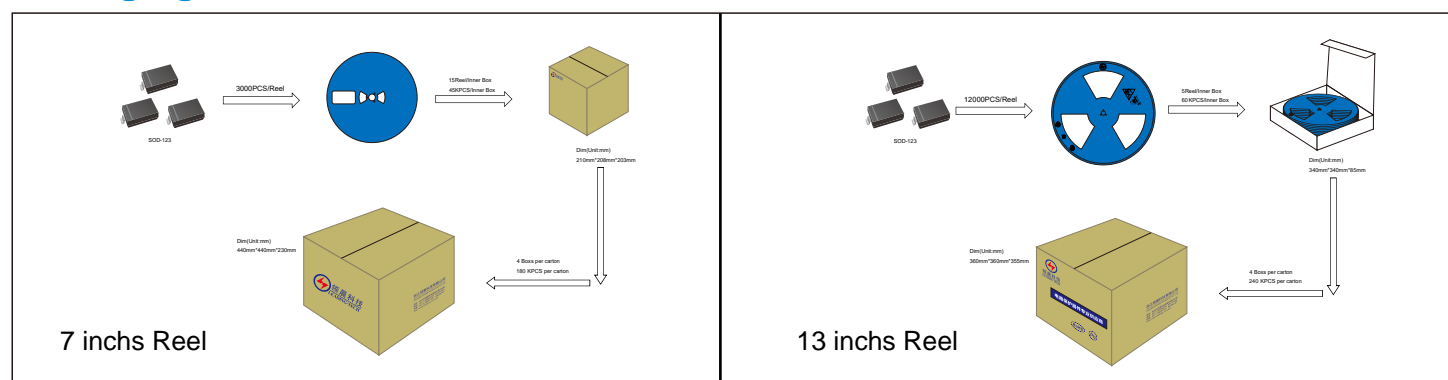



Recommended Soldering Conditions



Recommended Conditions

Profile Feature	Pb-Free Assembly
Average ramp-up rate (T _L to T _P)	3°C/second max.
Preheat	
-Temperature Min (T _{S min})	150°C
-Temperature Max (T _{S max})	200°C
-Time (min to max) (t _s)	60-180 seconds
T _{S max} to T _L	
-Ramp-up Rate	3°C/second max.
Time maintained above:	
-Temperature (T _L)	217°C
-Time (t _L)	60-150 seconds
Peak Temperature (T _P)	260°C
Time within 5°C of actual Peak Temperature (t _p)	20-40 seconds
Ramp-down Rate	6°C/second max.
Time 25°C to Peak Temperature	8 minutes max.

Important Notice and Disclaimer

Leading-Tech reverses the right to make changes to this document and its products and specifications at any time without notice.

Customers should obtain and confirm the latest product information and specifications before final design, purchase or use.

Leading-Tech makes no warranty, representation or guarantee regarding the suitability of its products for any particular purpose, not does Leading-Tech assume any liability for application assistance or customer product design.

Leading-tech does not warrant or accept any liability with products which are purchase or used for any unintended or unauthorized application.

No license is granted by implication or otherwise under any intellectual property rights of Leading-Tech.

Leading-Tech products are not authorized for use as critical components in life support devices or systems without express written approval of Leading-tech.

Version Update Information

Series NO.	Enactment/Revision Date	Effective Date	Version	Revision content	Revision Reason	Revision Person	Note
01	2024.4.15	2024.4.15	3.1	New File	/	Ding	
02	2025.06.18	2025.06.18	3.1	Update packaging information	/	Ding	