

Fast Switching Diode

Features

- Fast Switching Device (TRR <50nS)
- Power Dissipation of 250mW
- High Stability and High Reliability
- Low reverse leakage
- Lead free in comply with EU RoHS 2011/65/EU directives

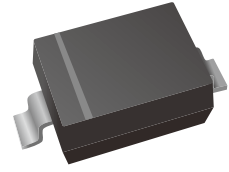

Machanical Data

- Case:SOD-323
- Polarity: Color band denotes cathode end
- Epoxy UL: 94V-0
- Mounting Position: Any

Ordering Information

Part Number	Shipping	Reel
LT19SW THRU LT21SW-TR3	3000PCS Tape&Reel	7 inches
LT19SW THRU LT21SW-TR12	12000PCS Tape&Reel	13 inches

Absolute Maximum Rating (Ta=25 unless otherwise noted)

Parameters	Symbol	Value			Unit
		LT19SW	LT20SW	LT21SW	
Non-Repetitive Peak Reverse Voltage	V_R	120	200	250	V
Peak Repetitive Reverse Voltage	V_{RRM}	100	150	200	V
Working Peak Reverse Voltage	V_{RWM}				
RMS Reverse Voltage	$V_{R(RMS)}$	71	106	141	V
Power Dissipation	P_d	250			mW
Operating junction temperature	T_j	-55 to +150			°C
Storage temperature range	T_s	-55 to +150			°C
Thermal Resistance Junction to Ambient Air	$R_{\theta JA}$	500			°C/W
Average Rectified Current	I_o	200			mA
Peak Forward Surge Current @tp=1ms; TA=25°C	I_{FSM}	1.7			A

Valid provided that electrodes are kept at ambient temperature.

Electrical Characteristics (TA=25°C unless otherwise specified)

Symbols	Parameter	Test Condition	Limits		Unit
			Min	Max	
V_{RB}	Reverse Voltage	IB=100uA LT19SW LT20SW LT21SW	120 200 250		V
I_R	Reverse Leakage Current	VR=100V LT19SW VR=150V LT20SW VR=200V LT21SW		0.1	uA
V_F	Forward Voltage	IF=100mA		1.00	V
		IF=200mA		1.25	
T_{RR}	Reverse Recovery Time	IF= 30mA, IR=30mA		50	nS
		RL=100Ω			
		I _{RR} =3mA			
C	Capacitance	VR=0V, f=1MHZ		5	pF

Characteristics Curves

Fig.1 Forward Characteristics

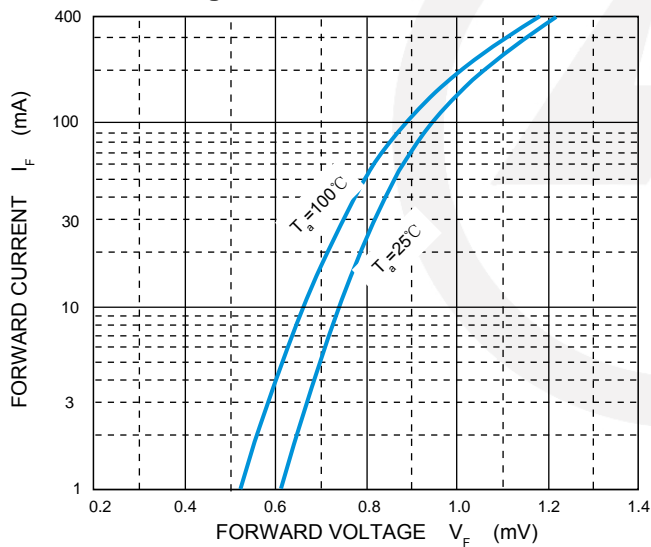

Fig.2 Typical Reverse Characteristics

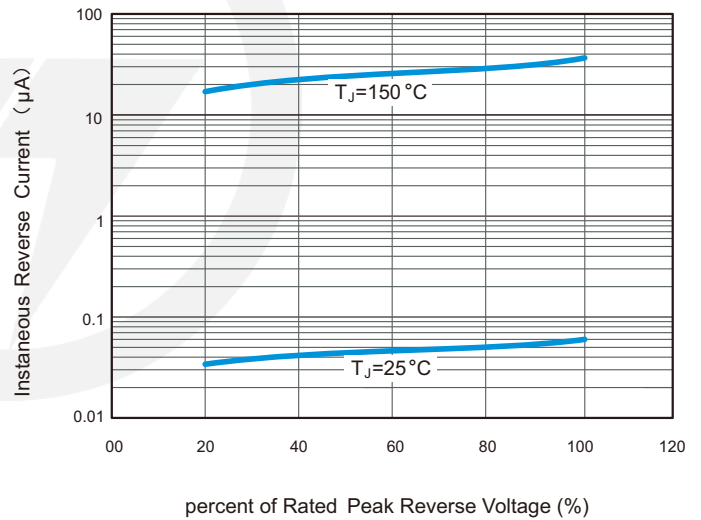

Fig.3 Capacitance Characteristics

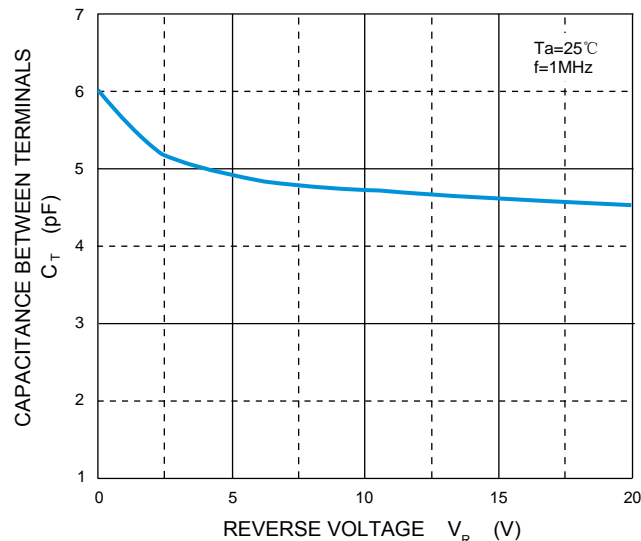
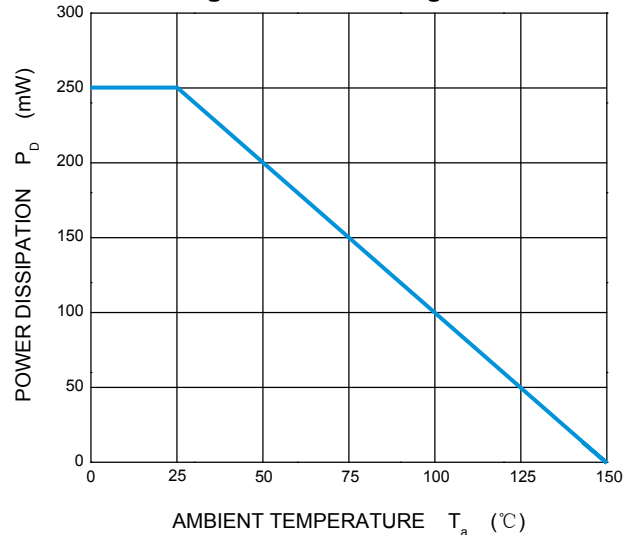

Fig.4 Power Derating Curve





SOD-323 Package Outline

Unit: mm

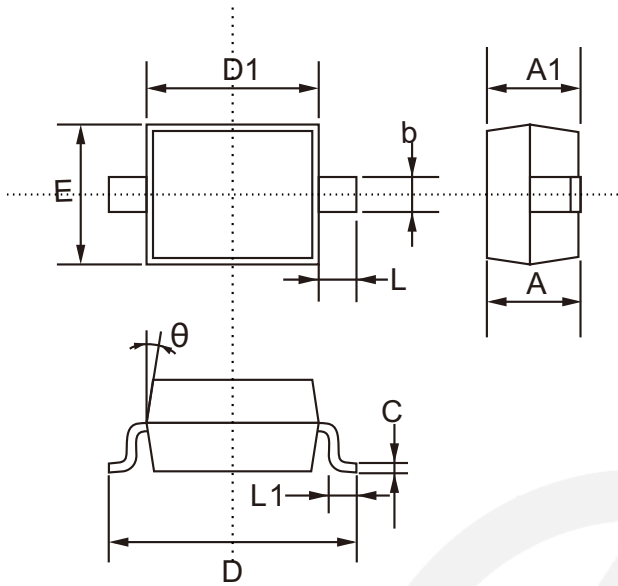

SYMBOL	DIMENSIONS	
	MIN.	MAX.
A	0.800	1.100
A1	0.800	0.900
b	0.250	0.400
C	0.080	0.177
D	2.300	2.800
D1	1.400	1.800
E	1.150	1.400
L1	0.100	0.400
L	0.475 TYP.	
θ	8°	

SOD-323 Suggested Pad Layout

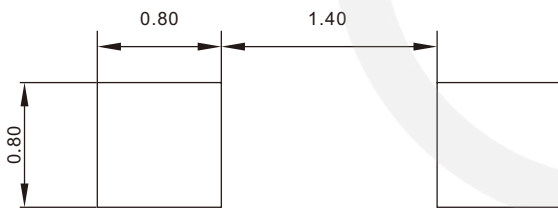

Note:
 1. Controlling dimension: in millimeters.
 2. General tolerance: $\pm 0.05\text{mm}$
 3. The pad layout is for reference purpose only.

Marking

Type number	Marking code
LT19SW	A8
LT20SW	T2
LT21SW	T3

Carrier Tape Dimensions

Unit : mm

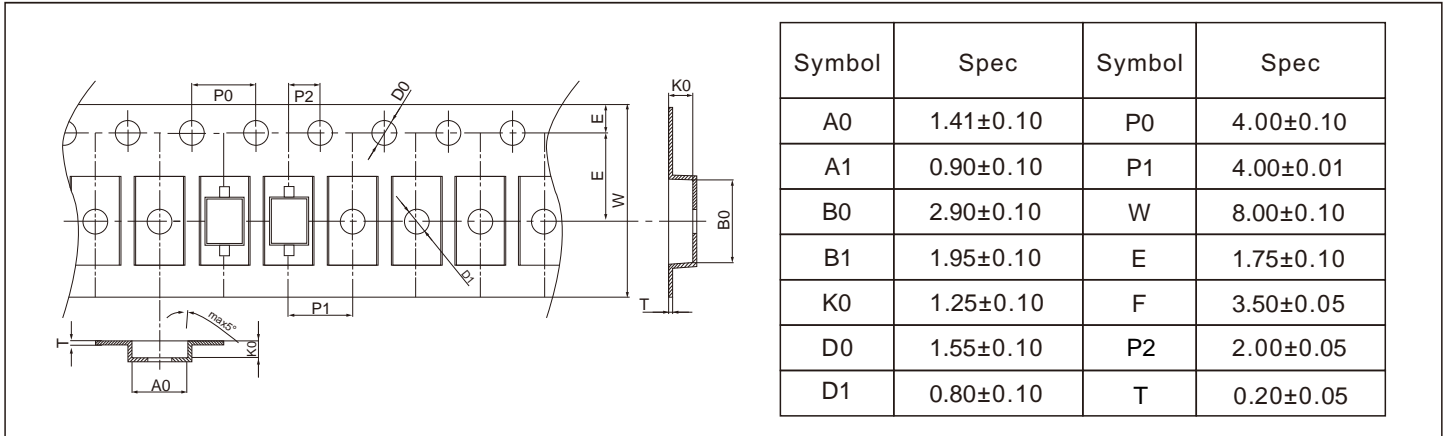

Reel Dimensions

Unit : mm

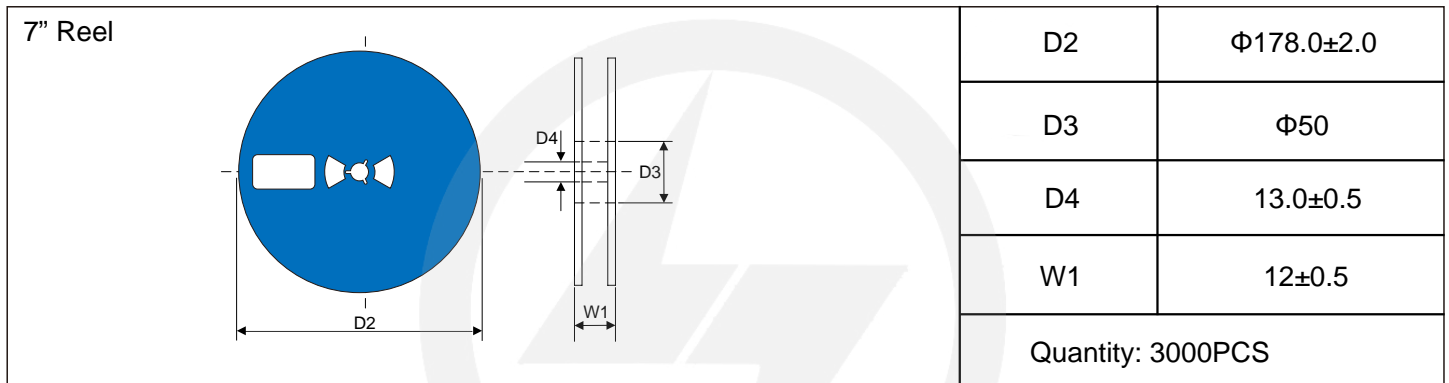

Reel Dimensions

Unit : mm

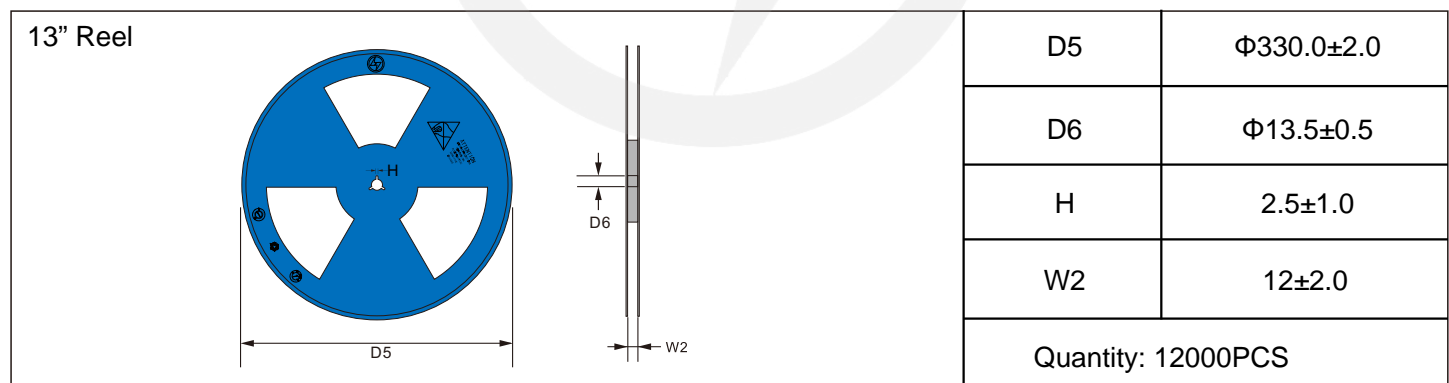

Packaging

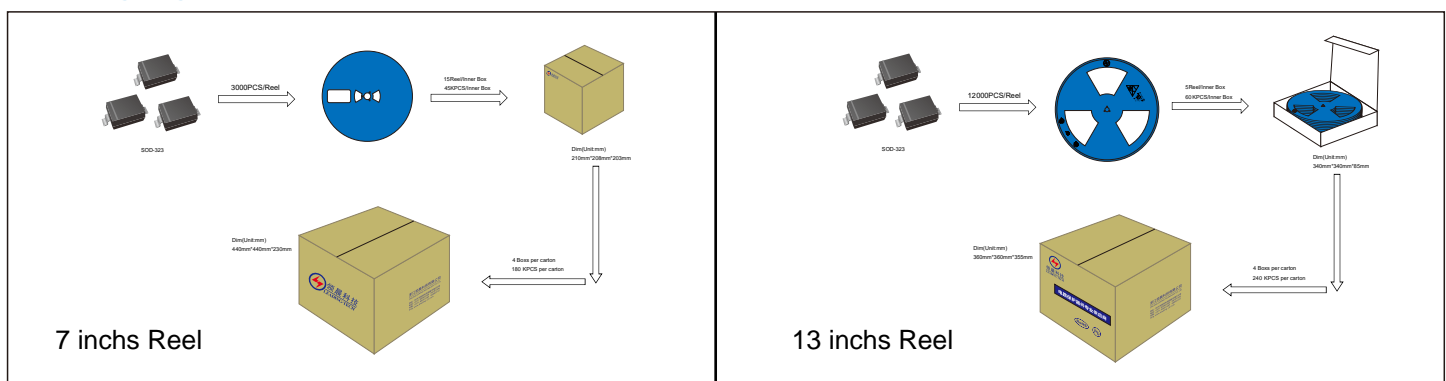



Recommended Soldering Conditions



Recommended Conditions

Profile Feature	Pb-Free Assembly
Average ramp-up rate (T _L to T _P)	3°C/second max.
Preheat	
-Temperature Min (T _{S min})	150°C
-Temperature Max (T _{S max})	200°C
-Time (min to max) (t _s)	60-180 seconds
T _{S max} to T _L	
-Ramp-up Rate	3°C/second max.
Time maintained above:	
-Temperature (T _L)	217°C
-Time (t _L)	60-150 seconds
Peak Temperature (T _P)	260°C
Time within 5°C of actual Peak Temperature (t _p)	20-40 seconds
Ramp-down Rate	6°C/second max.
Time 25°C to Peak Temperature	8 minutes max.

Important Notice and Disclaimer

Leading-Tech reserves the right to make changes to this document and its products and specifications at any time without notice.

Customers should obtain and confirm the latest product information and specifications before final design, purchase or use.

Leading-Tech makes no warranty, representation or guarantee regarding the suitability of its products for any particular purpose, not does Leading-Tech assume any liability for application assistance or customer product design.

Leading-tech does not warrant or accept any liability with products which are purchase or used for any unintended or unauthorized application.

No license is granted by implication or otherwise under any intellectual property rights of Leading-Tech.

Leading-Tech products are not authorized for use as critical components in life support devices or systems without express written approval of Leading-tech.

Version Update Information

Series NO.	Enactment/Revision Date	Effective Date	Version	Revision content	Revision Reason	Revision Person	Note
01	2024.5.12	2024.5.12	3.0	New File	/	Ding	
02	2025.06.16	2025.06.16	3.1	Update packaging information	/	Ding	
03	2025.07.01	2025.07.01	3.2	Modify Absolute Maximum Rating	/	Ding	