

Surface Mount Schottky Barrier Diode

Features

- Guard ring protection
- Low forward voltage drop
- For use in low voltage, high frequency inverters
- High surge current capability
- Lead free in comply with EU RoHS 2011/65/EU directives

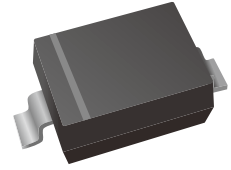

Mechanical Data

- Case: SOD-323
- Terminals: Solderable per MIL-STD-750, Method 2026
- Polarity: Color band denotes cathode end
- Approx. Weight: 4.6mg

Ordering Information

| Part Number | Marking | Shipping | Reel |
|---------------|---------|--------------------|-----------|
| LT16WS - TR3 | SM | 3000PCS Tape&Reel | 7 inches |
| LT16WS - TR12 | SM | 12000PCS Tape&Reel | 13 inches |

Maximum Ratings and Electiral characteristics

Ratings at 25 °C ambient temperature unless otherwise specified.

| Parameter | Symbols | LT16WS | Units |
|---|-----------------|---------------|-------|
| Maximum recurrent peak reverse voltage | V_{RRM} | 60 | V |
| Maximum RMS voltage | V_{RMS} | 42 | V |
| Maximum DC blocking voltage | V_{DC} | 60 | V |
| Continuous forward current | I_F | 1 | A |
| Maximum DC Reverse Current at Rated DC Blocking Voltage | I_R | 0.1 @VR=60V | mA |
| Peak Forward Surge Current, 8.3ms single half sine-wave superimposed on rated load (JEDEC method) | I_{FSM} | 10 | A |
| Maximum Instantaneous Forward Voltage | V_F | 0.7 @ IF=1.0A | V |
| Total power dissipation | P_{tot} | 250 | mW |
| Thermal Resistance, Junction to Ambient Air | $R_{\theta JA}$ | 400 | °C/W |
| Junction Temperature | T_j | 125 | °C |
| Storage Temperature | T_{stg} | -55 to +150 | °C |



Characteristics Curves

Fig.1 Power Derating Curve

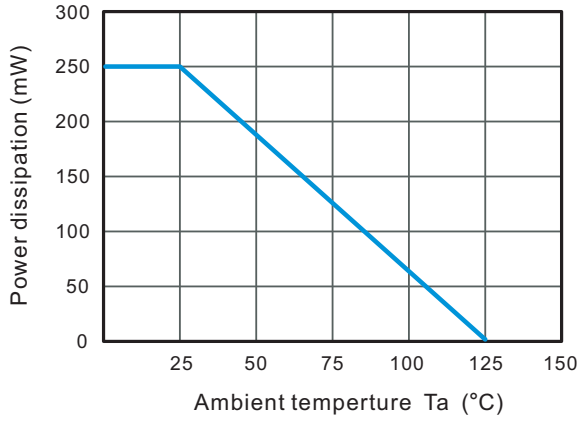

Fig.2 Typical Reverse Characteristics

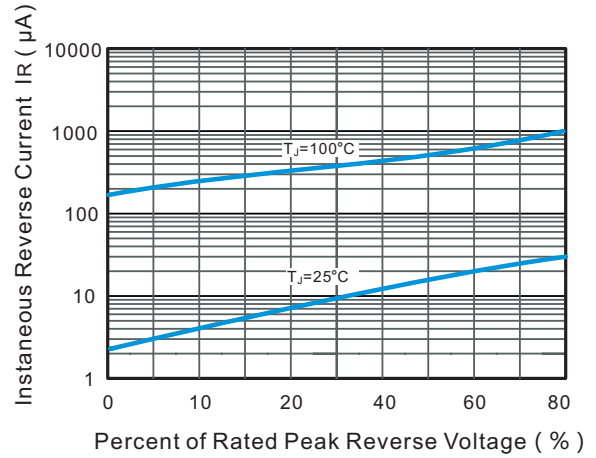

Fig.3 Typical Forward Voltage

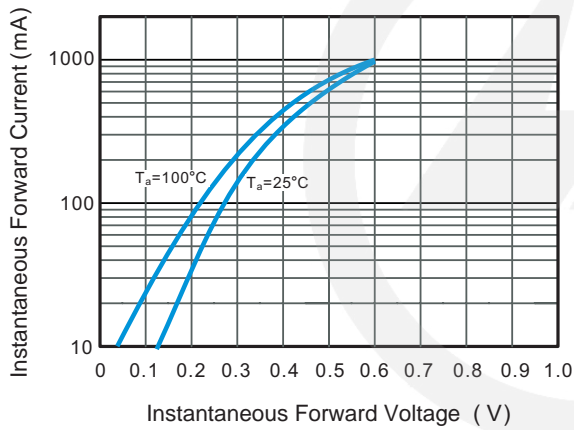

Fig.4 Maximum Non-Repetitive Peak Forward Surge Current

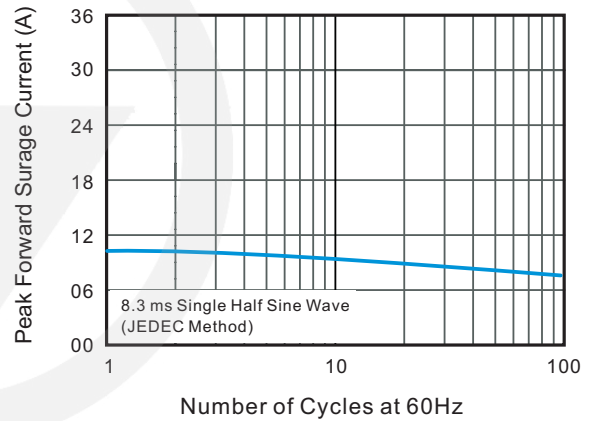
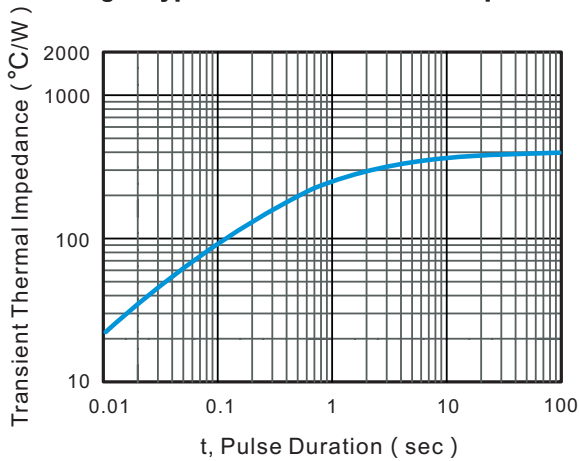
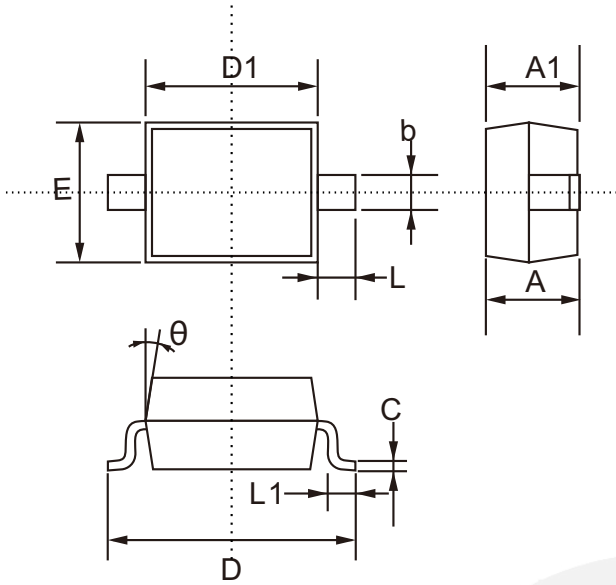

Fig.5 Typical Transient Thermal Impedance



SOD-323 Package Outline

Unit: mm



| SYMBOL | DIMENSIONS | |
|----------|------------|-------|
| | MIN. | MAX. |
| A | 0.800 | 1.100 |
| A1 | 0.800 | 0.900 |
| b | 0.250 | 0.400 |
| C | 0.080 | 0.177 |
| D | 2.300 | 2.800 |
| D1 | 1.400 | 1.800 |
| E | 1.150 | 1.400 |
| L | 0.475 TYP. | |
| θ | 8° | |

SOD-323 Suggested Pad Layout

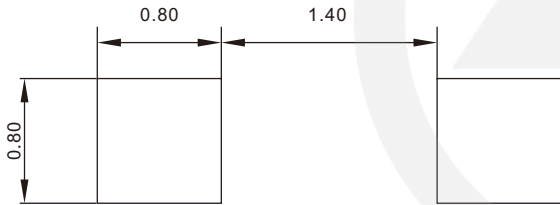

Note:
 1. Controlling dimension: in millimeters.
 2. General tolerance: $\pm 0.05\text{mm}$
 3. The pad layout is for reference purpose only.

Carrier Tape Dimensions

Unit : mm

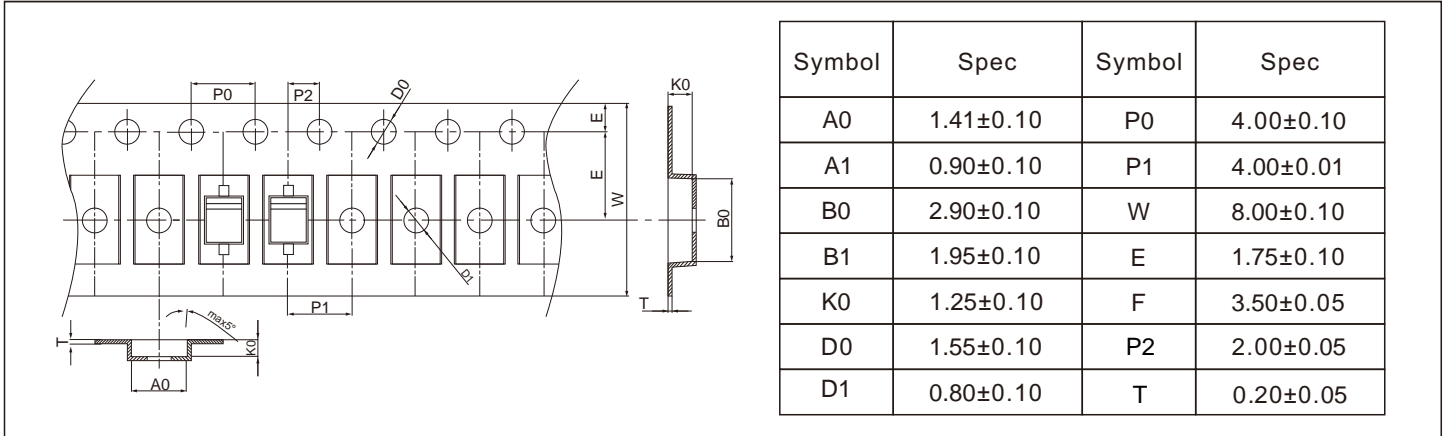

Reel Dimensions

Unit : mm

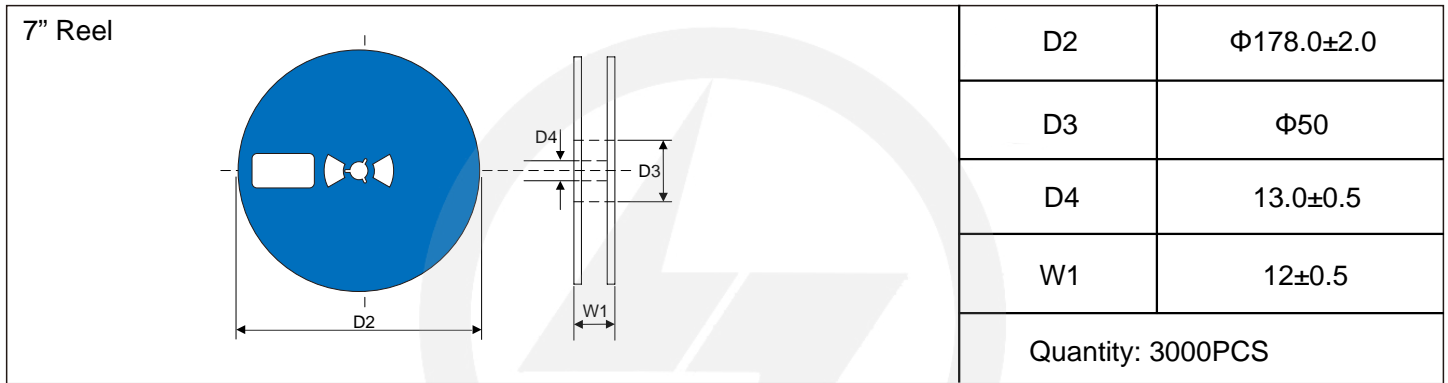

Reel Dimensions

Unit : mm

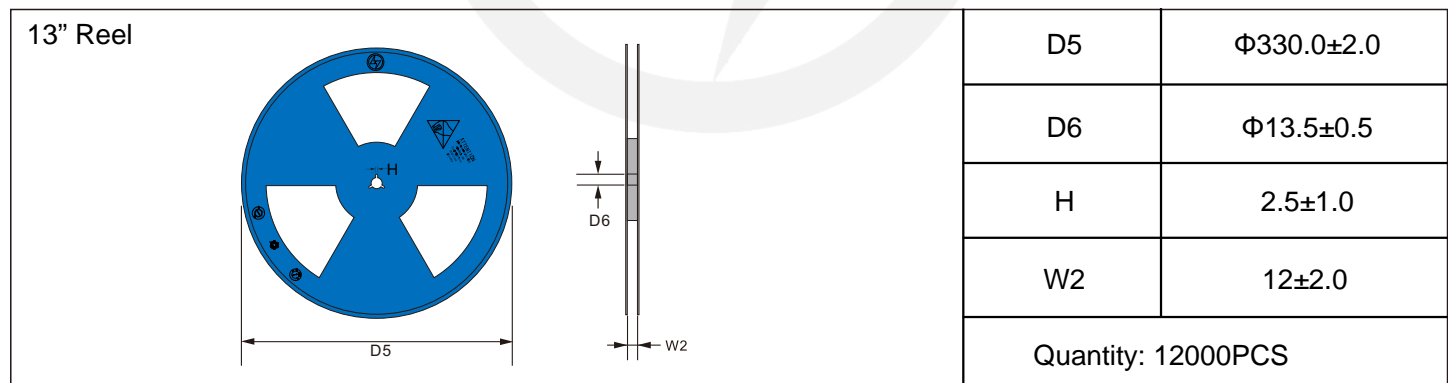

Packaging

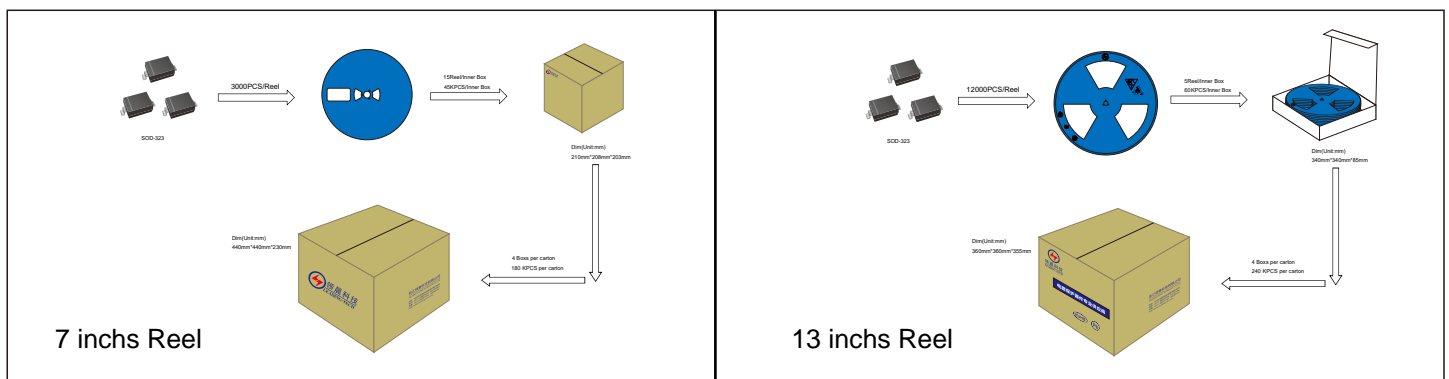



Recommended Soldering Conditions



Recommended Conditions

| Profile Feature | Pb-Free Assembly |
|--|------------------|
| Average ramp-up rate (T _L to T _P) | 3°C/second max. |
| Preheat | |
| -Temperature Min (T _{S min}) | 150°C |
| -Temperature Max (T _{S max}) | 200°C |
| -Time (min to max) (t _s) | 60-180 seconds |
| T _{S max} to T _L | |
| -Ramp-up Rate | 3°C/second max. |
| Time maintained above: | |
| -Temperature (T _L) | 217°C |
| -Time (t _L) | 60-150 seconds |
| Peak Temperature (T _P) | 260°C |
| Time within 5°C of actual Peak Temperature (t _p) | 20-40 seconds |
| Ramp-down Rate | 6°C/second max. |
| Time 25°C to Peak Temperature | 8 minutes max. |

Important Notice and Disclaimer

Leading-Tech reverses the right to make changes to this document and its products and specifications at any time without notice.

Customers should obtain and confirm the latest product information and specifications before final design, purchase or use.

Leading-Tech makes no warranty, representation or guarantee regarding the suitability of its products for any particular purpose, not does Leading-Tech assume any liability for application assistance or customer product design.

Leading-Tech does not warrant or accept any liability with products which are purchase or used for any unintended or unauthorized application.

No license is granted by implication or otherwise under any intellectual property rights of Leading-Tech.

Leading-Tech products are not authorized for use as critical components in life support devices or systems without express written approval of Leading-tech.

Version Update Information

| Series NO. | Enactment/Revision Date | Effective Date | Version | Revision Content | Revision Reason | Revision Person | Note |
|------------|-------------------------|----------------|---------|------------------|-----------------|-----------------|------|
| 01 | 2025.05.24 | 2025.05.24 | 3.0 | New file | / | Ding | |