

Gas Discharge Tube

Features

- Small Size Design 4.2×3.5×3.5mm
- Current Handling Capability 3,000A @ 8/20μs
- Low Capacitance and Insertion Loss
- Fast Response and Long Service Life
- Moisture Sensitivity Level: Level 1

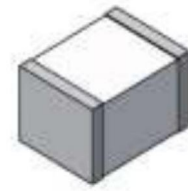

SMD

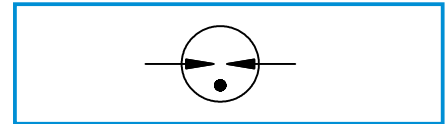
Functional Diagram

Applications

- DSL



Electrical Parameter

DC Breakdown Voltage 1)2)	100V/s	800~1200	V
Impulse Spark-over Voltage	At 1kV/μs	for 99 % of measured values	≤ 1600
	At 1kV/μs	Typical values of distribution	≤1500
Impulse Discharge Current 3)	8/20μs 10 operations [5x (+) & 5x (-)]	3,000	A
Arc Voltage	At 1A	~30	V
Insulation Resistance	DC=100V	≥1	GΩ
Capacitance at 1MHz	VDC=0.5V	≤0.6	pF
Weight		~0.23	g
Operating And Storage Temperature		-40-90	°C
Marking		Without	

1) At delivery AQL 0.65 level II ISO 2859

2) In ionized mode

3) Terms and waveforms in accordance with ITU-T Rec. K. 12; IEC 61643-21

Part Numbering System

LT 102 M
 (1) (2) (3)

- (1) Leading-Tech Gas Discharge Tube
 (2) Series: DC Breakdown Voltage,
 e.g.: $102=10 \times 10^2=1000V$
 (3) Tolerance of DC Breakdown Voltage, M=+-20%,
 N=+-30%, the Specific tolerance is decided by the table
 of "Electrical Parameter"

Product Characteristics

Lead Material	Copper or iron nickel alloy
Body Material	Ceramics
Terminal Finish	100% Matte-Tin Plated

Environmental Reliability Characteristics

Testing items	Technical standards
High Temperature Storage Test	Temperature: 90°C Time: 2H
Low Temperature Storage Test	Temperature: -40°C Time: 2H
Vibration	Frequency: 10-500Hz Amplitude: 0.15mm Time: 45mins
Resistance of soldering heat	Temperature: 260±5°C Time of dip soldering: 10s, 1time

Note: Up-screen program can be specified by customer's request via contacting Bencent service

Solderability test

Solderability	Solder Pot Temperature:	245°C ± 5°C
	Solder Dwell Time:	4-6 seconds

Package Outline

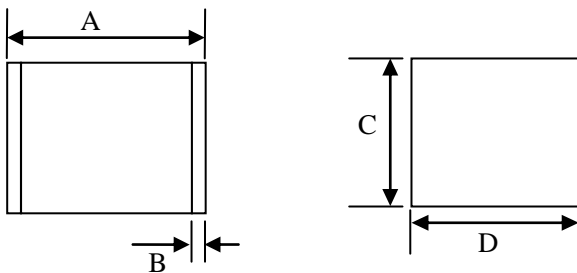

REF	mm
A	4.2±0.3
B	0.5±0.1
C	3.5±0.2
D	3.5±0.2

Suggested Pad Layout

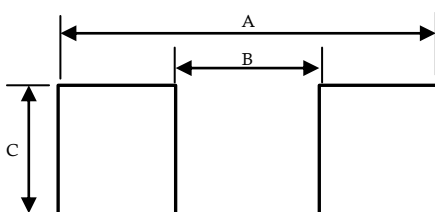

REF	mm
A	4.95
B	3.0
C	4.2

Reflow Profile

Reflow Condition		Pb-Free assembly
Pre Heat	Temperature Min	150°C
	Temperature Max	200°C
	Time (min to max)	60 – 180 secs
Average ramp up rate (Liquids) T _{amp} (T _L) to peak		3°C/second max
T _S (max) to T _L - Ramp-up Rate		3°C/second max
Reflow	- Temperature (T _L) (Liquids)	217°C
	- Temperature (T _L)	60 – 150 seconds
Peak Temperature (T _p)		260±0/-5 °C
Time within 5°C of actual peak Temperature (t _p)		8 – 20 seconds
Ramp-down Rate		6°C/second max
Time 25°C to peak Temperature (T _p)		8 minutes Max.
Do not exceed		260°C

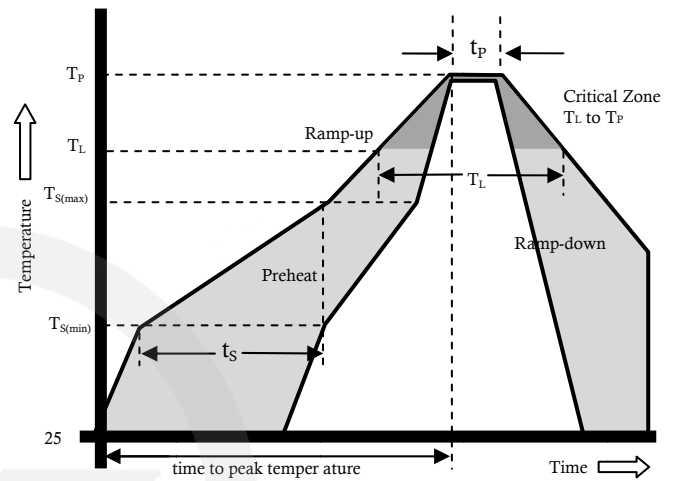

Package Reel Information

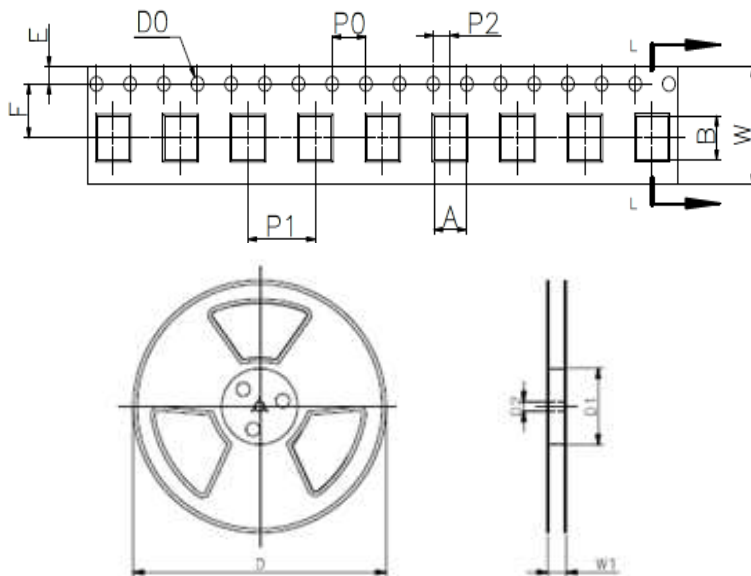

REF	mm	inch
A	3.8±0.1	0.150±0.004
B	4.5±0.2	0.177±0.008
D0	Φ1.5±0.1	Φ0.059±0.004
P0	4.0±0.1	0.157±0.004
P2	2.0±0.1	0.079±0.004
P1	8.0±0.1	0.315±0.004
E	1.75±0.1	0.069±0.004
F	5.0±0.1	0.197±0.004
W	12.0±0.3	0.472±0.012
D	Φ330.0	Φ13.0
D1	Φ50Min	Φ1.97Min
D2	Φ13±0.15	0.512±0.006
W1	16.8±2.0	0.661±0.079

Outline	Reel (PCS)	Per Carton (PCS)	Reel Diameter (mm)	Carton Size(mm)		
				L	W	H
TAPING	2,000	32,000	330	360	360	385